



SafeSite[®] LED Bulkhead / Wallpack - INMETRO

for Indoor and Outdoor Industrial Applications



On when it matters most.

Products and solutions that protect your business





Features & Benefits

- L70 rated for >100,000 hours @ 25°C ambient
- 5 year warranty
- Instant on/off operation
- Mercury free, lead free
- Resistant to shock and vibration
- Additional LED colors available upon request (green or red)

Application

The Dialight SafeSite® LED Bulkhead luminaire with its low profile, rugged design ensures long life and high reliability for a wide variety of applications requiring INMETRO certification. Offered in 22 Watt and 34 Watt versions, it is ideally suited for oil platforms, explosive environments, mills, chemical plants and other hazardous environments. The product can be supplied with a flush mounting bracket, a 30° angled bracket, or no bracket to enable direct mounting.

DuroSite LED Bulkhead / Wallpack - INMETRO

Standard Model



Certifications & Ratings

- INMETRO Portaria 179:2010
- Certificate number: UL-BR 12.0232X
- Ex II 2G D Ex d IIB T5 Gb
- Ex tb IIC T100°C Db IP66
- IP66
- RoHS compliant

Mechanical Information:

Fixture weight:

22W:	5.0 kg (11 lb)
34W:	5.7 kg (12.5 lb)

Shipping weight:

22W:	5.7 kg (12.5 lb)
34W:	6.1 kg (13.5 lb)

Cabling:

All cable entries are drilled and tapped see ordering options.

Electrical Specifications:

Operating Voltage: 100-277 VAC, 50/60 Hz or 24-48 VDC

Total system power consumption:

See table

Operating Temp:

22W:	-40°C to +60°C (-40°F to +140°F)
34W:	-40°C to +50°C (-40°F to +122°F)

Harmonics:

IEC 61000-3-2

Noise Requirements / EMC:

FCC Title 47, Subpart B, Section 15, class B device. RF Immunity; 10V/m, 80MHz-1GHz

Transient protection:

1kV line-to-line, 2kV line-to-ground

THD:

<20%

Power Factor:

> 0.9

Construction:

Housing:

Copper-free aluminum

Finish:

Superior dual coat finish
- Sealed polyester topcoat
- Chemical-resistant epoxy primer

Lens:

High impact resistant clear glass
High impact resistant frosted glass

Mounting Brackets:

316 stainless steel

Stanchion Brackets:

Copper-free LM6 cast aluminium

Photometric Information:

CRI:

75

CCT:

4000K (neutral white)
6000K (cool white)

All values typical unless otherwise stated (tolerance +/- 10%)

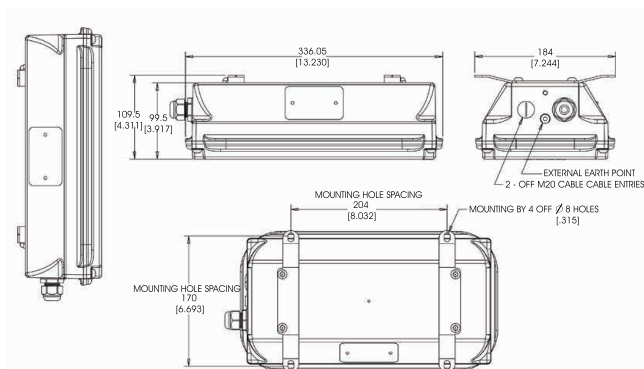

Shown with Flush mounting bracket

Dimensions in mm [inches]

Temperature Ratings

	Ambient Temperature Range T5 Temperature Code	Ambient Temperature Range T6 Temperature Code
22W	-40°C to +60°C (-40°F to +140°F)	-40°C to +50°C (-40°F to +122°F)
34w	-40°C to +50°C (-40°F to +122°F)	-40°C to +40°C (-40°F to +104°F)
Temperature Ratings with Recessed Housing		
22w	-40°C to +55°C (-40°F to +131°F)	-40°C to +45°C (-40°F to +113°F)
34w	-40°C to +45°C (-40°F to +113°F)	-40°C to +35°C (-40°F to +95°F)

DuroSite LED Bulkhead / Wallpack - INMETRO

Ordering Information and Mounting Accessories

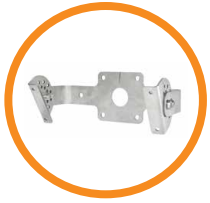

WP-BRKT-SS-ADJ

- Adjustable Bracket
- Includes self-tapping screws



WP-STMB-LG00- 22

- 1 1/2" BSP threaded straight stanchion mounting bracket

WP-STMB-LG00 -24

- 1 1/2" NPT threaded straight stanchion mounting bracket



WP-STMB-LG85-22

- 1 1/2" BSP threaded 85 degree stanchion mounting bracket

WP-STMB-LG85-24

- 1 1/2" NPT threaded 85 degree stanchion mounting bracket

WP-STMB-LG85-50

- Non threaded bore 34mm diameter

WP-STMB-LG85-60

- Non threaded bore 38mm diameter



WP-BRKT-LG-PF

- Pipe and flush bracket
- Includes self-tapping screws



WP-STMB-LG25-22

- 1 1/2" BSP threaded 25 degree stanchion mounting bracket

WP-STMB-LG25-24

- 1 1/2" NPT threaded 25 degree stanchion mounting bracket

WP-BRKT-SS-ADJ

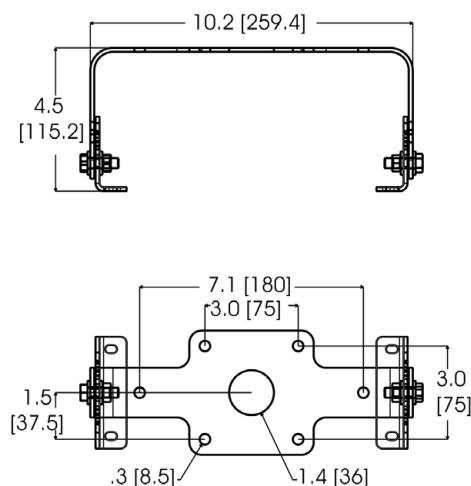

90 degrees

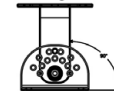

60 degrees



30 degrees

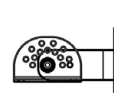
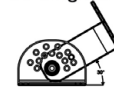

DuroSite LED Bulkhead / Wallpack - INMETRO

Mounting Diagrams

Without Bracket

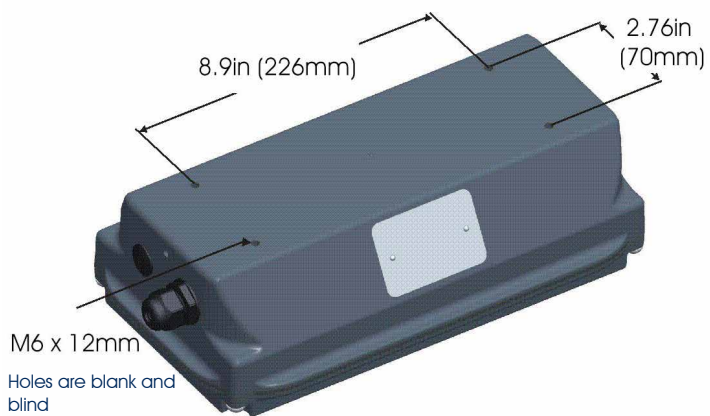

30° Angle Bracket

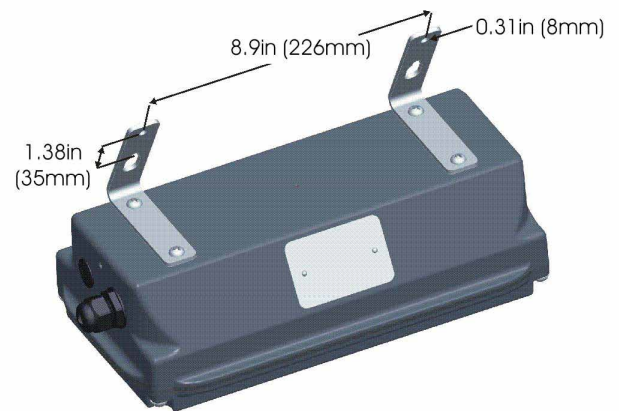

Flush Bracket



WP-STMB-LG00-XX



Standard Option



2 Entries One Side

Option "E"

2 Entries One Side, 1 Entry Opposite Side.
Add **E** to the end of the order code

Option "R"

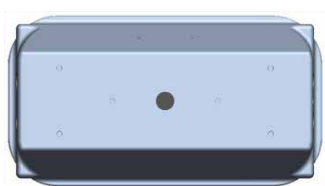
Add **R** to the end of the order code

Option "H"

2 Entries One Side, 2 Entries Opposite Side and 1 Entry in the Rear
Add **H** to the end of the order code

DuroSite LED Bulkhead / Wallpack - INMETRO

Ordering Information and Light Distribution Pattern

Part Number	Fixture Lumens	Wattage	Lm/W	IP Rating	Voltage	Colour Temperature (CCT)	Lens	Beam Distribution
Standard Models - 100-277 VAC								
WPA-2C3L-NLGC-BR	2,250	34	66	IP66	100-277 VAC	6000K (cool white)	Clear Tempered glass	Narrow
WPA-4C3L-NLGC-BR	2,250	34	66	IP66	100-277 VAC	6000K (cool white)	Clear Tempered glass	Oval (35° X 55°)
WPA-5C3L-NLGC-BR	2,150	34	63	IP66	100-277 VAC	6000K (cool white)	Clear Tempered glass	Oval (55° X 35°)
WPA-2C3H-NLGC-BR	1,200	22	55	IP66	100-277 VAC	6000K (cool white)	Clear Tempered glass	Narrow
WPA-4C3H-NLGC-BR	1,200	22	55	IP66	100-277 VAC	6000K (cool white)	Clear Tempered glass	Oval (35° X 55°)
WPA-5N3H-NLGC-BR	1,200	22	55	IP66	100-277 VAC	6000K (cool white)	Clear Tempered glass	Oval (55° X 35°)
Standard Models - 24-48 VDC								
WPA-2C3L-NLGC-BR	2,250	34	66	IP66	24-48 VDC	6000K (cool white)	Clear Tempered glass	Narrow
WPA-4C3L-NLGC-BR	2,250	34	66	IP66	24-48 VDC	6000K (cool white)	Clear Tempered glass	Oval (35° X 55°)
WPA-5C3L-NLGC-BR	2,150	34	63	IP66	24-48 VDC	6000K (cool white)	Clear Tempered glass	Oval (55° X 35°)
WPA-2C3H-NLGC-BR	1,200	22	55	IP66	24-48 VDC	6000K (cool white)	Clear Tempered glass	Narrow
WPA-4C3H-NLGC-BR	1,200	22	55	IP66	24-48 VDC	6000K (cool white)	Clear Tempered glass	Oval (35° X 55°)
WPA-5N3H-NLGC-BR	1,200	22	55	IP66	24-48 VDC	6000K (cool white)	Clear Tempered glass	Oval (55° X 35°)

All values typical unless otherwise stated, Lumen values are typical (tolerance +/- 10%).

Part number in table show fixture without a bracket.

All the codes listed above (except for amber models) are neutral white. For Cool white, change the 'C' to 'N'. Ex: WPA-4C3L-NLGC becomes WPA-4N3L-NLGC.

Oval (35°x55°)

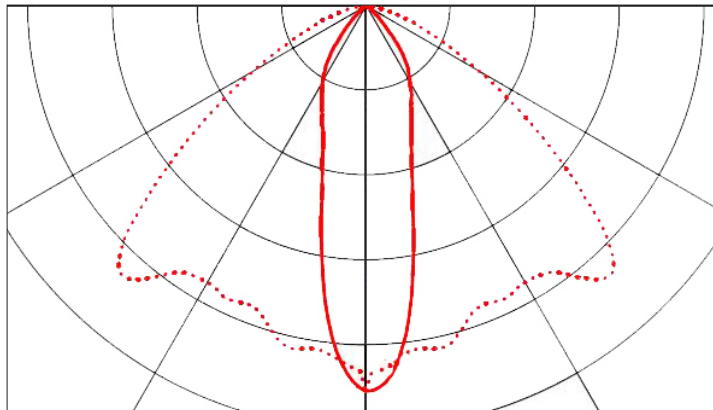

Oval (55°x35°)

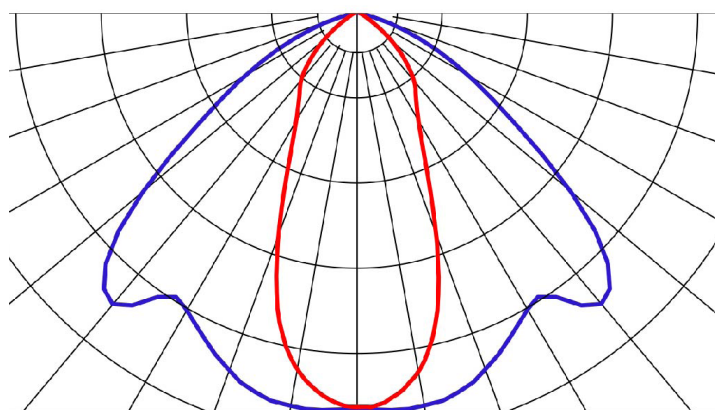

Narrow

