



Dialight

SafeSite[®] LED Wallpack - UL 844
for Indoor and Outdoor Hazardous Applications

On when it matters most.

Products and solutions that protect your business

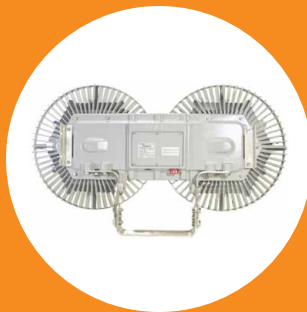



Features & Benefits

- L70 rated for >100,000 hours @ 25°C ambient
- 5 year warranty
- Instant on/off operation
- Mercury free, lead free
- Resistant to shock and vibration
- LED color options available - Please contact factory for details

Application

The Dialight SafeSite[®] Wallpack / Bulkhead luminaire with its low profile, rugged design ensures long life and high reliability for a wide variety of Class I, Div 2, Class II, Div 2 applications. Offered in 11 Watt, 22 Watt and 34 Watt versions, it is ideally suited for oil platforms, explosive environments, mills, chemical plants and other hazardous environments. The product can be supplied with a flush mounting bracket, a 30° angled bracket, or no bracket to enable direct mounting.

Hazardous Locations Ratings

Fixed and portable fixtures for installation and use in hazardous (classified) locations Class I, Divisions 1 and 2, Groups A, B, C, and D; Class II, Division 1, Groups E, F, and G; Class II, Division 2, Groups F and G; and Class III, Divisions 1 and 2, in accordance with the National Electrical Code, NFPA 70

Classes

The classes define the general nature of hazardous material in the surrounding atmosphere.

Class	Hazardous Material in Surrounding Atmosphere
Class I	Hazardous because flammable gases or vapors are present in the air in quantities sufficient to produce explosive or ignitable mixtures.
Class II	Hazardous because combustible or conductive dusts are present.
Class III	Hazardous because ignitable fibers or flying's are present, but not likely to be in suspension in sufficient quantities to produce ignitable mixtures. Typical wood chips, cotton, flax and nylon. Group classifications are not applied to this class.

Divisions

The division defines the probability of hazardous material being present in an ignitable concentration in the surrounding atmosphere.

Division	Presence of Hazardous Material
Division 1	The substance referred to by class is present during normal conditions.
Division 2	The substance referred to by class is present only in abnormal conditions, such as a container failure or system breakdown.

Groups

The group defines the hazardous material in the surrounding atmosphere.

Group	Hazardous Material in Surrounding Atmosphere
Group A	Acetylene
Group B	Hydrogen, fuel and combustible process gases containing more than 30% hydrogen by volume or gases of equivalent hazard such as butadiene, ethylene, oxide, propylene oxide and acrolein.
Group C	Carbon monoxide, ether, hydrogen sulfide, morphine, cyclopropane, ethyl and ethylene or gases of equivalent hazard.
Group D	Gasoline, acetone, ammonia, benzene, butane, cyclopropane, ethanol, hexane, methanol, methane, vinyl chloride, natural gas, naphtha, propane or gases of equivalent hazard.
Group E	Combustible metal dusts, including aluminum, magnesium and their commercial alloys or other combustible dusts whose particle size, abrasiveness and conductivity present similar hazards in connection with electrical equipment.
Group F	Carbonaceous dusts, carbon black, coal black, charcoal, coal or coke dusts that have more than 8% total entrapped volatiles or dusts that have been sensitized by other material so they present an explosion hazard.
Group G	Flour dust, grain dust, flour, starch, sugar, wood, plastic and chemicals.

SafeSite LED Wallpack - UL 844

Class I, Div. 2 Models



Patent #8,029,162

Certifications & Ratings

- Class I, Div. 2 Groups A, B, C & D
- UL 844
- UL 1598/A
- CSA C22.2 No. 137
- IP66/67

Mechanical Information:

Fixture weight:	11 lb (5.0 kg)
Shipping weight:	11lbs (5kg)
Cable Entry:	All cable entries are drilled and tapped see ordering options.

Electrical Specifications:

Operating Voltage:	100-277 VAC, 50/60Hz
Total system power consumption:	See table
Operating Temp:	See table
Harmonics:	EN 61000-3-2: 2006
Noise requirement /EMC:	FCC Title 47, Subpart B, Section 15, class A device. RF Immunity; 10V/m, 80MHz-1GHz
Transient protection:	1kV line-to-line, 2kV line-to-ground
THD:	<20%
Power Factor:	> 0.9

Construction:

Housing:	Copper-free aluminum
Finish:	Switch out for platform statement from most recent edits
Lens:	High impact resistant clear glass High impact resistant frosted glass
Mounting Brackets:	316 stainless steel
Stanchion Brackets:	Copper free LM6 cast aluminium

Photometric Information:

CRI:	70
CCT:	5650K (cool white) 4300K (neutral white)
Optics:	available at www.dialight.com

All values typical unless otherwise stated
Lumen values are typical (tolerance +/- 10%)

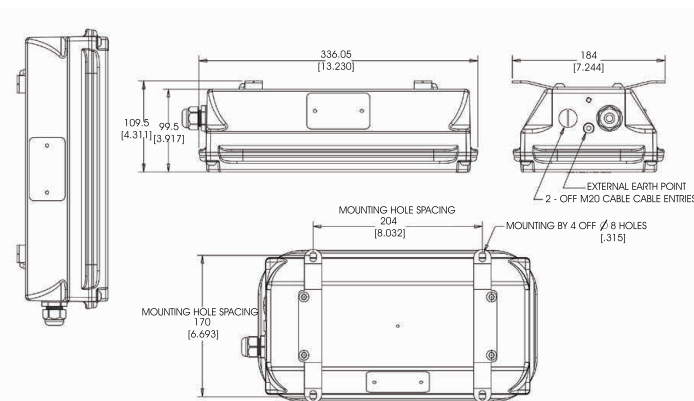

Dimensions in mm [Inches]

Temperature Ratings

Ambient Temperature Range T4A Temperature Code

11W / 22W	-40°F to +140°F (-40°C to +60°C)
34W	-40°F to +122°F (-40°C to +50°C)

SafeSite LED Wallpack - UL 844

Ordering Information

Classifications: CID2 A, B, C, D • CIID2 F, G

Part Number	CID1	CID2	CIID1	CIID2	CIID	Voltage	Lens	CCT	Fixture Lumens	Watt	lm/W	Beam Distribution
Standard Models - 100-277 VAC												
WPC2C3LNLGC		•		•		100-277 VAC	Clear tempered glass	5650K (cool white)	2250	34	66	Narrow
WPC4C3LNLGC		•		•		100-277 VAC	Clear tempered glass	5650K (cool white)	2250	34	66	Oval (35° x 55°)
WPC5C3LNLGC		•		•		100-277 VAC	Clear tempered glass	5650K (cool white)	2150	34	66	Oval (55° x 35°)
WPC2C3HNLGC		•		•		100-277 VAC	Clear tempered glass	5650K (cool white)	1200	22	55	Narrow
WPC4C3HNLGC		•		•		100-277 VAC	Clear tempered glass	5650K (cool white)	1200	22	55	Oval (35° x 55°)
WPC5C3HNLGC		•		•		100-277 VAC	Clear tempered glass	5650K (cool white)	1200	22	55	Oval (55° x 35°)
WPC2C3CNLGC		•		•		100-277 VAC	Clear tempered glass	5650K (cool white)	600	11	55	Narrow
WPC4C3CNLGC		•		•		100-277 VAC	Clear tempered glass	5650K (cool white)	600	11	55	Oval (35° x 55°)
WPC5C3CNLGC		•		•		100-277 VAC	Clear tempered glass	5650K (cool white)	600	11	55	Oval (55° x 35°)

All values typical unless otherwise stated, Lumen values are typical (tolerance +/- 10%).

Standard Option - 2 M20 entries one side. For through wiring, add an **E** to the end of the order code. For rear entry, add an **R** to the end of the order code. For 3/4 NPT entries, add a **S** to the end of the order code.

For neutral white 4300K, change the second **C** to an **N** EX: WPC4**C**3LNLGC becomes WPC4**N**3LNLGC

For bracket options, change the fourth to last **N** character to **F** for Flush Bracket or **A** for 30° Angle bracket EX: WPC4C3**N**LG**C** becomes WPC4C3**F**LG**C** with Flush bracket

For frosted glass lens option change the last digit from **C** to **F** EX: WPC4C3LNLG**C** becomes WPC4C3LFLG**F**

SafeSite LED Wallpack - UL 844

Entry Options

Standard Option



2 Entries One Side

Option "E"



2 Entries One Side, 1 Entry Opposite Side.
Add **E** to the end of the order code

Option "R"

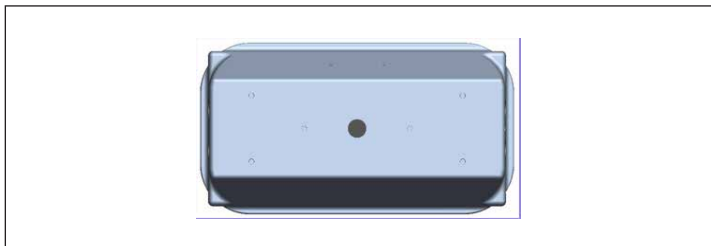

Add **R** to the end of the order code

Option "H"



2 Entries One Side, 2 Entries Opposite Side and 1 Entry in the Rear
Add **H** to the end of the order code

SafeSite LED Wallpack - UL 844

Light Distribution Pattern

Oval (35°x55°)

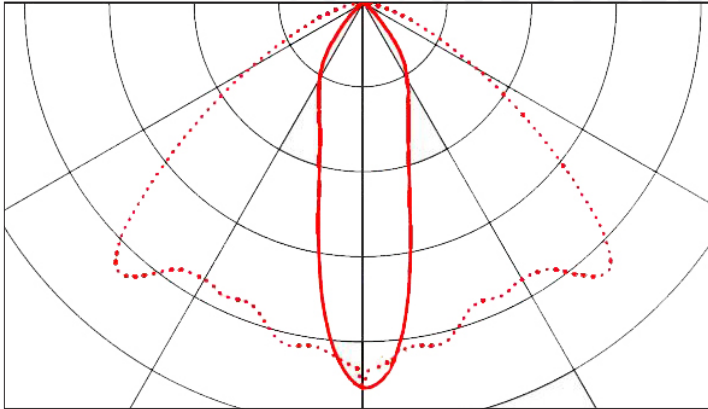

Oval (55°x35°)

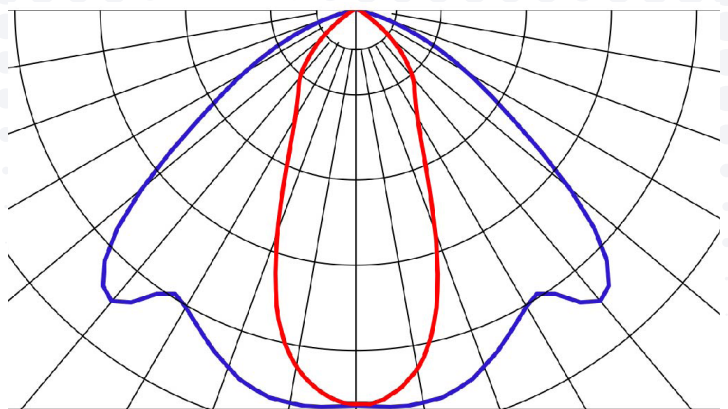

Narrow

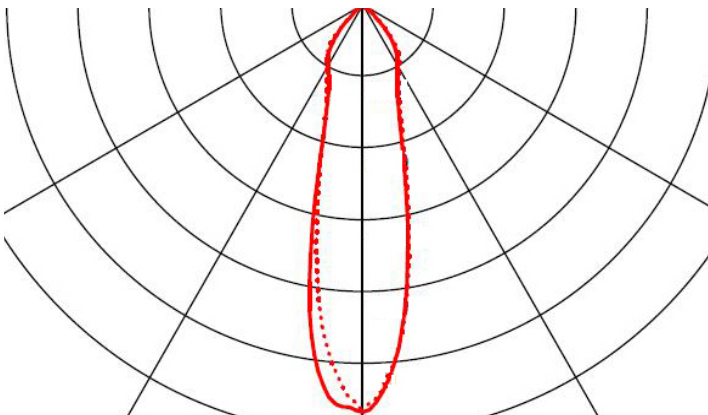

SafeSite LED Wallpack - UL 844

Ordering Information and Mounting Accessories

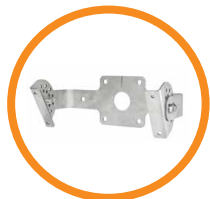
**WP-BRKT-SS-ADJ**

- Adjustable Bracket

**WP-STMB-LG00- 22**

- 1 1/2" BSP threaded straight stanchion mounting bracket

WP-STMB-LG00 -24

- 1 1/2" NPT threaded straight stanchion mounting bracket

**WP-STMB-LG25-22**

- 1 1/2" BSP threaded 25 degree stanchion mounting bracket

WP-STMB-LG25-24

- 1 1/2" NPT threaded 25 degree stanchion mounting bracket

**WP-STMB-LG85-22**

- 1 1/2" BSP threaded 85 degree stanchion mounting bracket

WP-STMB-LG85-24

- 1 1/2" NPT threaded 85 degree stanchion mounting bracket

**WP-BRKT-LG-PF**

- Pipe and flush bracket

**WP-STMB-LG25-22**

- 1 1/2" BSP threaded 25 degree stanchion mounting bracket

WP-STMB-LG25-24

- 1 1/2" NPT threaded 25 degree stanchion mounting bracket

SafeSite LED Wallpack - UL 844

Mounting Diagrams

Without Bracket

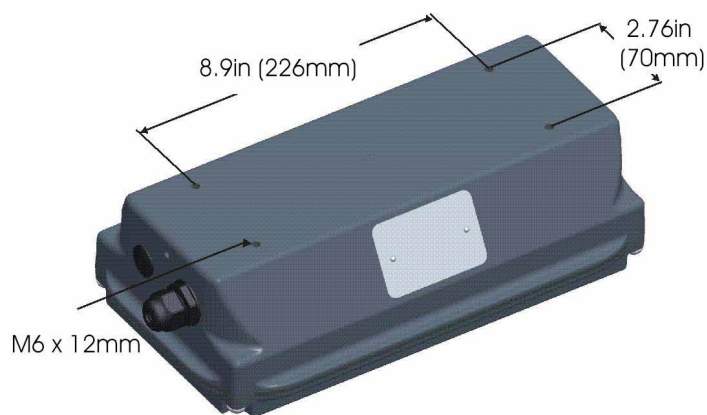

30° Angle Bracket

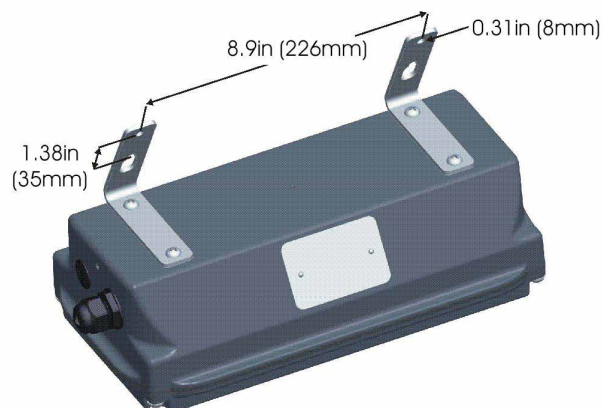

Flush Bracket



WP-STMB-LG00-XX



WP-BRKT-SS-ADJ

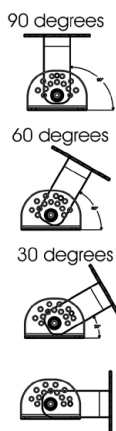
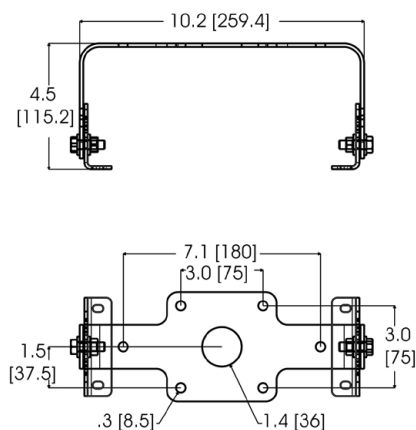

WP-BRKT-SS-ADJ



North American HQ

1501 Route 34 South
Farmingdale, NJ 07727
Tel: 732-919-3119
Fax: 732-751-5778
info@dialight.com

EMEA Technical Centre

Ejby Industrivej 91 B
200 Glostrup
Tel: +45 8877 4545 (Denmark)
Tel: +44 1638 666541 (UK)
Tel: +49 89 12089 5713 (Germany)
Tel: +33 3 23 22 62 58 (France)
sales-europe@dialight.com

Houston

16830 Barker Springs Rd
Ste 407
Houston, TX 77084
Tel: 732-919-3119
Fax: 281-492-1531
info@dialight.com

Middle East

Level 42
Emirates Towers (Office Tower)
Sheikh Zayed Road
Dubai, United Arab Emirates
Fax: +971 (0) 4319 7686
Tel: +971 (0) 4319 7686

Australia

38 O'Malley Street
Osborne Park, WA 6017
Tel: +61 (0) 8 9244 7600
Fax: +61 (0) 8 9244 7601
info@dialight.com.au

Southeast Asia

33 Ubi Avenue 3
#07-72 Vertex (Tower A)
Singapore 408868
Tel: +65 6578 7157
Fax: +65 6578 7150
enquiry@dialight.com.sg

Brazil

Alameda Mercurio,
225 – American Park Empresarial NR
Indaiatuba – SP – 13347– 662
Tel: +55 (19) 3113-4300
Fax: +55 (19) 3113-4300
brasil@dialight.com

ALL VALUES ARE DESIGN OR TYPICAL VALUES WHEN MEASURED UNDER LABORATORY CONDITIONS. THE LIGHTING EFFICIENCY STATEMENTS CONTAINED HEREIN ARE CALCULATED ON A LUMEN PER WATTS BASIS WHEN COMPARING FIXTURES WITH SIMILAR FEATURES. ALL INFORMATION PROVIDED IS ACCURATE AS OF THE DATE OF PUBLICATION, IS SUBJECT TO CHANGE WITHOUT NOTICE AND DOES NOT FORM PART OF ANY CONTRACT WITH DIALIGHT. DIALIGHT DOES NOT WARRANT OR REPRESENT THAT ITS PRODUCTS ARE FIT FOR ANY PARTICULAR PURPOSE AND HAS NO RESPONSIBILITY FOR THE [INAPPROPRIATE/UNAUTHORISED/NON-APPROVED] USE OF ANY DIALIGHT PRODUCTS BY THE END USER.

Dialight reserves the right to make changes at any time in order to supply the best product possible.

The most current version of this document will always be available at: www.dialight.com