

.....Dialight



Vigilant® LED Floodlight - UL/CSA

for Indoor and Outdoor Industrial Applications

MARCH 2021



Features & Benefits

- 10 year warranty
- L70 rated for >100,000 hours @ 25°C ambient
- Instant on/off operation
- Universal input (100-277 VAC, 50/60Hz and 347/480 VAC, 60Hz)
- Superior color rendition index compared to HPS, LPS, MH
- Mercury free
- Resistant to shock and vibration
- Temperature compensation technology for longer life
- Safety tabs provided for secondary retention

Application

The Vigilant® LED Floodlight represents the future of energy efficient facility illumination for industrial applications worldwide. The lighting fixture consumes at least 50% less energy than traditional HID light sources, while reducing maintenance and carbon emissions. This light incorporates both cutting edge LED technology along with proprietary optics to achieve flood lighting comparable with other traditional light sources.

Vigilant® LED Dual Floodlight - UL / CSA

Standard Models

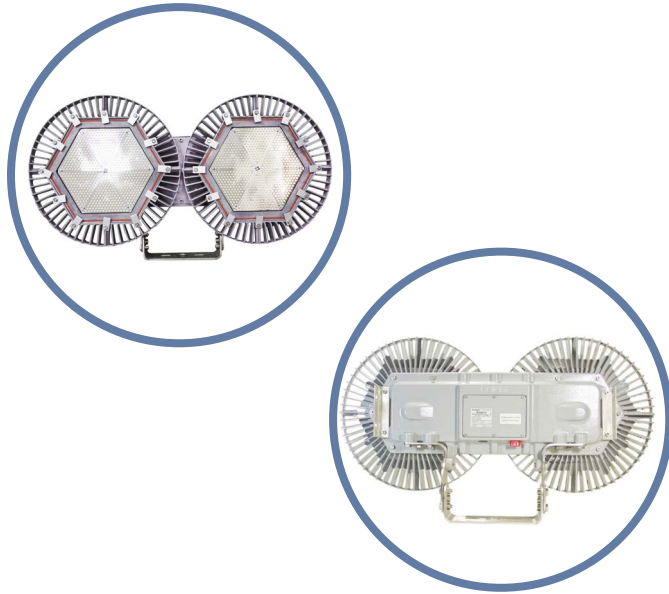

Certifications & Ratings

- UL 1598/A
- CSA C22.2 No. 250
- NEMA 4X
- IP66
- IK05

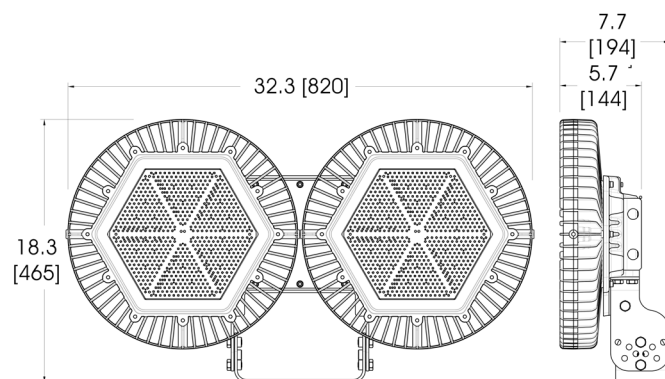

Dimensions in inches [mm]

Mechanical Information:

Fixture weight:	56 lb (25.4 kg)
Shipping weight:	60 lb (27.2 kg)
EPA (sq.ft):	2.69
Mounting:	304 Stainless Steel trunnion mounting bracket included
Entries:	(2) 3/4" NPT cable entries

Electrical Specifications:

Operating voltage:	100-277 VAC/120-250 VDC
Power consumption:	See table
Operating temp:	-40°F to +149°F (-40°C to +65°C)
Noise requirement /EMC:	FCC Title 47, Subpart B, Section 15, Class A device. RF Immunity; 10V/m, 80MHz-1GHz
Surge protection:	6kV/2 ohm combination wave, as per IEEE C62.41, line-line and line-ground
THD:	< 20%
Power factor:	> 0.9

Variable Dimming:

Variable dimming control:	0-10 VDC
Dimming range:	10 VDC = 100% light output 0 VDC = <10% light output

Construction:

Housing:	Copper-free aluminum
Finish:	Superior dual coat finish - Sealed polyester topcoat - Epoxy primer
Lens:	Tempered glass

Photometric Information:

CRI:	80
CCT:	5000K (cool white) 4000K (neutral white)
Beam patterns:	Medium distribution NEMA 6 distribution NEMA 7x6 distribution
IES files:	Available at www.dialight.com

All values typical unless otherwise stated (tolerance +/- 10%)

WARNING - INSTALLATION & SECONDARY RETENTION. Use of any Dialight products without proper installation (including secondary retention / netting) and periodic inspections could cause severe injury or death. Dialight recommends that all installations should use secondary retention / netting (appropriate to the installation environment) where applicable. It is the exclusive responsibility of the contractor, installer and/or end-user to: (a) determine the suitability of the product for its intended application; and, (b) ensure that the product is safely installed (with secondary retention / netting where appropriate) and in compliance with all applicable laws and regulations. To the extent permissible under applicable laws, Dialight disclaims all liability for personal injury and/or other damage resulting from any dislodgment or other dislocation of its products.

Vigilant® LED Dual Floodlight - UL / CSA

347/480 VAC Models

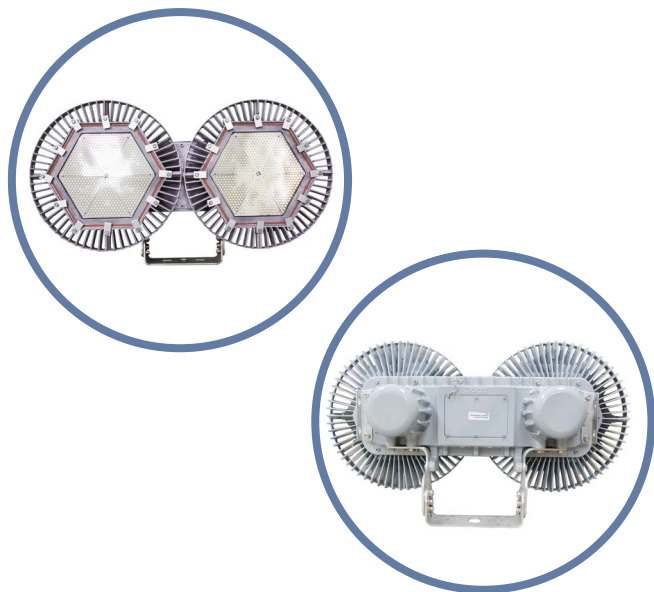

Certifications & Ratings

- UL 1598/A
- CSA C22.2 No. 250
- NEMA 4X
- IP66
- IK05

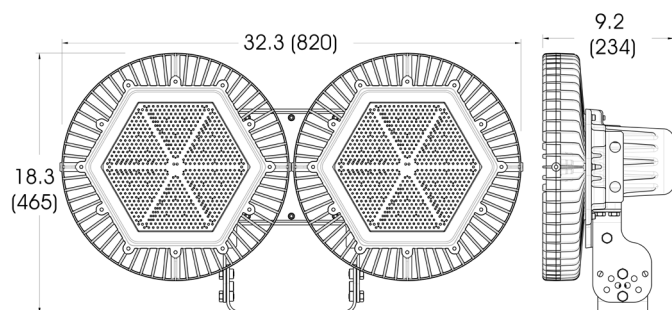

Dimensions in inches [mm]

Mechanical Information:

Fixture weight:	73 lb (33.1 kg)
Shipping weight:	79 lb (35.8 kg)
EPA (sq.ft):	2.69
Mounting:	304 Stainless Steel trunnion mounting bracket included
Entries:	(2) 3/4" NPT cable entries

Electrical Specifications:

Operating voltage:	347/480 VAC, 60Hz
Power consumption:	See table
Operating temp:	-40°F to +149°F (-40°C to +65°C)
Noise requirement /EMC:	FCC Title 47, Subpart B, Section 15, Class A device. RF Immunity; 10V/m, 80MHz-1GHz
Surge protection:	6kV/2 ohm combination wave, as per IEEE C62.41, line-line and line-ground
THD:	< 20%
Power factor:	> 0.9

Variable Dimming:

Variable dimming control:	0-10 VDC
Dimming range:	10 VDC = 100% light output 0 VDC = <10% light output

Construction:

Housing:	Copper-free aluminum
Finish:	Superior dual coat finish - Sealed polyester topcoat - Epoxy primer
Lens:	Tempered glass

Photometric Information:

CRI:	80
CCT:	5000K (cool white) 4000K (neutral white)
Beam patterns:	Medium distribution NEMA 6 distribution NEMA 7x6 distribution
IES files:	Available at www.dialight.com

All values typical unless otherwise stated (tolerance +/- 10%)

WARNING - INSTALLATION & SECONDARY RETENTION. Use of any Dialight products without proper installation (including secondary retention / netting) and periodic inspections could cause severe injury or death. Dialight recommends that all installations should use secondary retention / netting (appropriate to the installation environment) where applicable. It is the exclusive responsibility of the contractor, installer and/or end-user to: (a) determine the suitability of the product for its intended application; and, (b) ensure that the product is safely installed (with secondary retention / netting where appropriate) and in compliance with all applicable laws and regulations. To the extent permissible under applicable laws, Dialight disclaims all liability for personal injury and/or other damage resulting from any dislodgment or other dislocation of its products.

Vigilant® LED Single Floodlight - UL / CSA

Standard Models

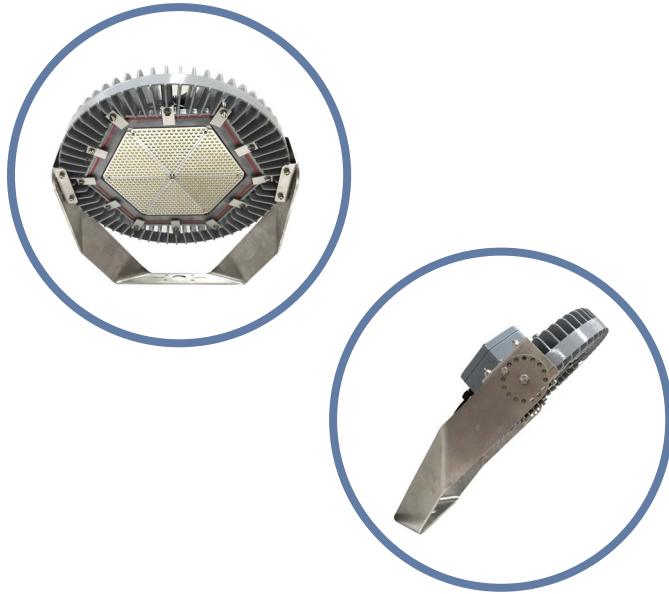

Certifications & Ratings

- UL 1598/A
- CSA C22.2 No. 250
- NEMA 4X
- IP66
- IK07

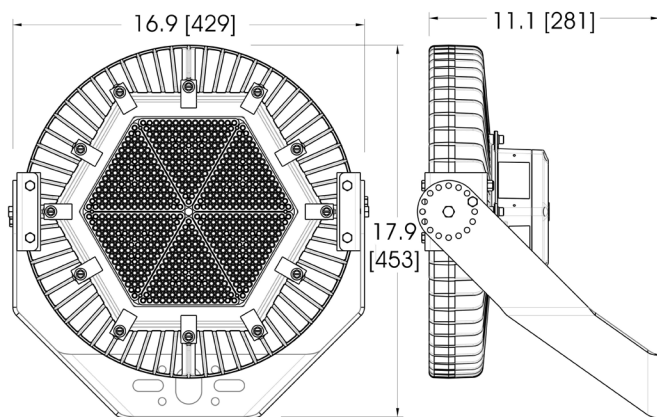

Dimensions in inches [mm]

Mechanical Information:

Fixture weight:	34 lb (15.4 kg)
Shipping weight:	39 lb (17.7 kg)
Mounting:	304 Stainless Steel forward throw bracket
Entries:	(3) 3/4" NPT cable entries

Electrical Specifications:

Operating voltage:	100-277 VAC/120-250 VDC
Power consumption:	See table
Operating temp:	-40°C to +65°C (-40°F to +149°F)
Noise requirement /EMC:	FCC Title 47, Subpart B, Section 15, Class A device. RF Immunity; 10V/m, 80MHz-1GHz
Surge protection:	100-277 VAC models tested to withstand up to 8kV/4kA per IEEE C62.41
THD:	< 20%
Power factor:	> 0.9

Variable Dimming:

Variable dimming control:	0-10 VDC
Dimming range:	10 VDC = 100% light output 0 VDC = <10% light output

Construction:

Housing:	Copper-free aluminum
Finish:	Superior dual coat finish - Sealed polyester topcoat - Epoxy primer
Lens:	Tempered glass

Photometric Information:

CRI:	80
CCT:	5000K (cool white) 4000K (neutral white)

Beam patterns:	NEMA 6 distribution NEMA 7x6 distribution
----------------	--

IES files:	Available at www.dialight.com
------------	---

All values typical unless otherwise stated (tolerance +/- 10%)

WARNING - INSTALLATION & SECONDARY RETENTION. Use of any Dialight products without proper installation (including secondary retention / netting) and periodic inspections could cause severe injury or death. Dialight recommends that all installations should use secondary retention / netting (appropriate to the installation environment) where applicable. It is the exclusive responsibility of the contractor, installer and/or end-user to: (a) determine the suitability of the product for its intended application; and, (b) ensure that the product is safely installed (with secondary retention / netting where appropriate) and in compliance with all applicable laws and regulations. To the extent permissible under applicable laws, Dialight disclaims all liability for personal injury and/or other damage resulting from any dislodgment or other dislocation of its products.

Vigilant® LED Floodlight - UL / CSA

Mounting Accessories & Beam Distribution



HZXCBL2

- Safety cable kit
- Kit includes: (2) safety cables

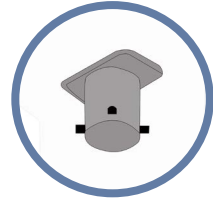

FLX-1TPT-20DB¹

- Tenon pole topper, 2-3/8" mount
- Kit includes: tenon topper, pole set screws, and mounting hardware

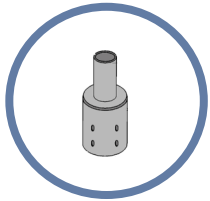

FLX-3RPA-20DB FLX-4RPA-20DB

- Reducer for 3" or 4" OD round pole top to 2-3/8" light mount
- Kit includes: reducer pole set screws

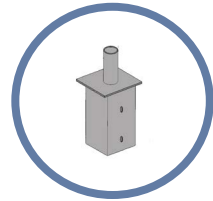

FLX-4SPA-20DB FLX-5SPA-20DB FLX-6SPA-20DB

- Internal tenon adapter for 4", 5" or 6" square pole top to 2-3/8" light mount
- Kit includes: adapter

¹Bracket and adapters require tenon adapter (FLX-1TPT-20DB) to mount floodlight. Tenon adapter is sold separately.

Medium

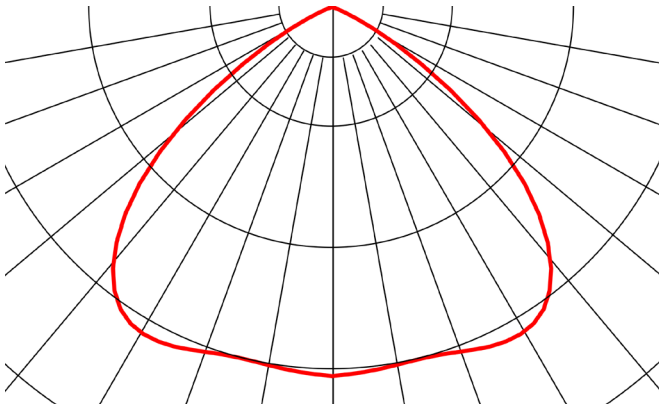

NEMA 6

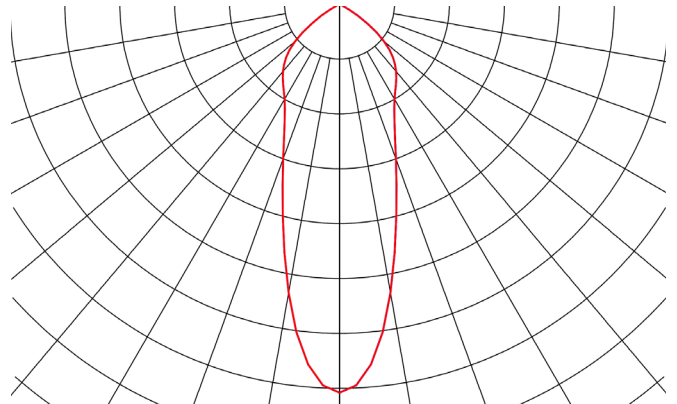

NEMA 7x6

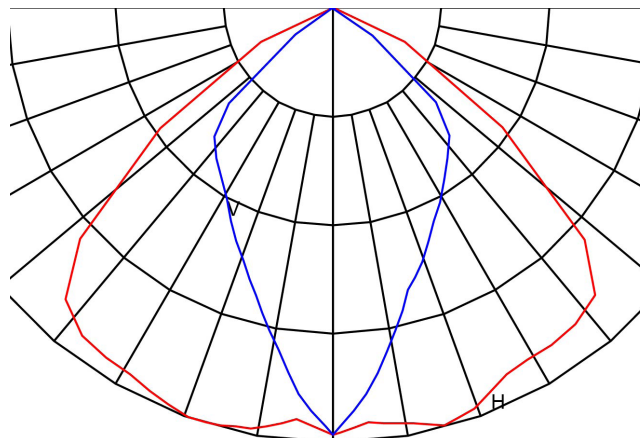

DISCLAIMER. All product information provided is, to the best of Dialight's knowledge, accurate as of the date of publication. When ordering, refer to www.dialight.com for current versions of: (a) relevant product documentation (including the relevant product data sheets); (b) Dialight terms and conditions of sale; and, (c) the relevant product warranty. To the extent that any contract is deemed formed between Dialight and the purchaser of Dialight products and/or an end-user, versions of documents available at www.dialight.com as at the date of sale shall be the versions incorporated therein. In the event of any discrepancy between this document or information provided at www.dialight.com, the latter shall prevail.

Vigilant® LED Floodlight - UL / CSA

Dimensional Drawings

Dual Model

Dual Floodlight Mounting Options

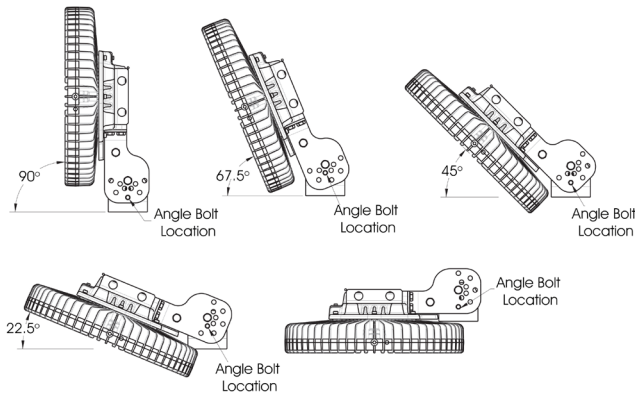

Factory Installed Mounting Bracket Dimensions

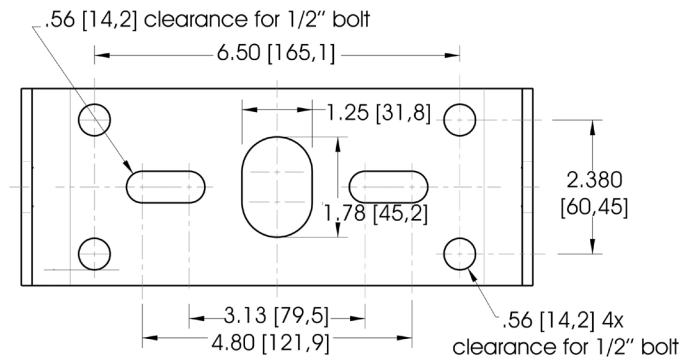

Single Model

Factory Installed Mounting Bracket Dimesions

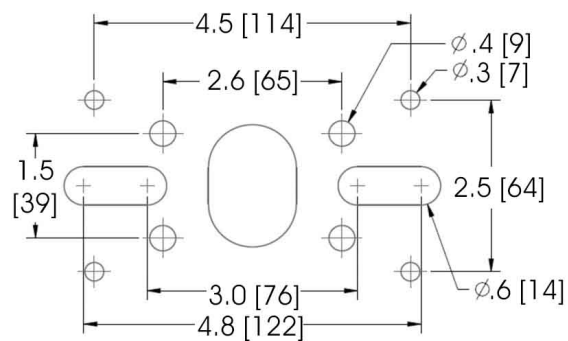
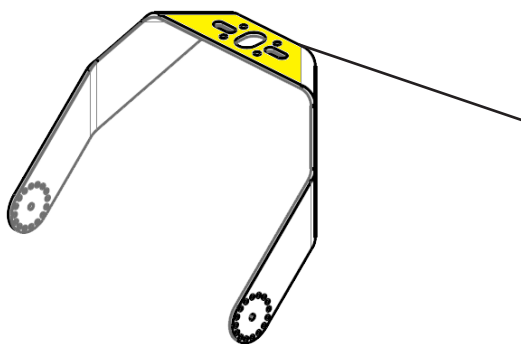

Dimensions in inches [mm]

DISCLAIMER. All product information provided is, to the best of Dialight's knowledge, accurate as of the date of publication. When ordering, refer to www.dialight.com for current versions of: (a) relevant product documentation (including the relevant product data sheets); (b) Dialight terms and conditions of sale; and, (c) the relevant product warranty. To the extent that any contract is deemed formed between Dialight and the purchaser of Dialight products and/or an end-user, versions of documents available at www.dialight.com as at the date of sale shall be the versions incorporated therein. In the event of any discrepancy between this document or information provided at www.dialight.com, the latter shall prevail.

Vigilant® LED Floodlight - UL / CSA

Ordering Information

Standard Models - 100-277 VAC/120-250 VDC								
Part Number	Legacy Part Number	Fixture Lumens	Wattage	lm/W	Voltage	CCT	Lens	Beam Distribution
Dual Floodlight Models								
FDU76C2MDSNNGN	FLWB66NC2NG	56,000	385	145	100-277 VAC/ 120-250 VDC	5000K (cool white)	Clear Tempered Glass	NEMA 6
FDU7MC2MDSNNGN	FLWBM0NC2NG	54,000	385	140	100-277 VAC/ 120-250 VDC	5000K (cool white)	Clear Tempered Glass	Medium
FDU77C2MDSNNGN	FLWB76NC2NG	54,000	380	142	100-277 VAC/ 120-250 VDC	5000K (cool white)	Clear Tempered Glass	NEMA 7x6
FDU76C2HDSNNGN	FLW966NC2NG	39,000	270	144	100-277 VAC/ 120-250 VDC	5000K (cool white)	Clear Tempered Glass	NEMA 6
FDU77C2HDSNNGN	FLW976NC2NG	37,500	265	141	100-277 VAC/ 120-250 VDC	5000K (cool white)	Clear Tempered Glass	NEMA 7x6
Single Floodlight Models								
FSU76C2EDDNNGN	FLW666JC2NG	27,500	185	149	100-277 VAC/ 120-250 VDC	5000K (cool white)	Clear Tempered Glass	NEMA 6
FSU77C2EDDNNGN	FLW676JC2NG	26,400	185	143	100-277 VAC/ 120-250 VDC	5000K (cool white)	Clear Tempered Glass	NEMA 7x6

All values typical unless otherwise stated (tolerance +/- 10%).

For neutral white models, replace the 6th character (standard) / 8th character (legacy) with an **N**. Ex. FDU76**C**2MDSNNGN / FLWB66**N**C2NG becomes FDU76**N**2MDSNNGN / FLWB66**N**C2NG. For warm white models, replace the 6th character (standard) / 8th character (legacy) with an **N**. Ex. FDU76**C**2MDSNNGN / FLWB66**N**C2NG becomes FDU76**W**2MDSNNGN / FLWB66**N**W2NG.

Standard Models - 347/480 VAC										
Part Number	Legacy Part Number	Fixture Lumens	Wattage		lm/W		Voltage	CCT	Lens	Beam Distribution
			347 VAC	480 VAC	347 VAC	480 VAC				
Dual Floodlight Models										
FDU76CAMDSNNGN	FLWB66NC5NG	56,000	457	409	122	136	347/480 VAC	5000K (cool white)	Tempered Glass	NEMA 6
FDU7MCAMDSNNGN	FLWBM0NC5NG	54,000	457	409	118	132	347/480 VAC	5000K (cool white)	Tempered Glass	Medium
FDU77CAMDSNNGN	FLWB76NC5NG	54,000	452	404	119	133	347/480 VAC	5000K (cool white)	Tempered Glass	NEMA 7x6
FDU76CAHDSNNGN	FLW966NC5NG	39,000	342	294	114	132	347/480 VAC	5000K (cool white)	Tempered Glass	NEMA 6
FDU77CAHDSNNGN	FLW976NC5NG	37,500	337	289	111	129	347/480 VAC	5000K (cool white)	Tempered Glass	NEMA 7x6

All values typical unless otherwise stated (tolerance +/- 10%).

For neutral white models, replace the 6th character (standard) / 8th character (legacy) with an **N**. Ex. FDU76**C**AMDSNNGN / FLWB66**N**C5NG becomes FDU76**N**AMDSNNGN / FLWB66**N**C5NG. For warm white models, replace the 6th character (standard) / 8th character (legacy) with an **N**. Ex. FDU76**C**AMDSNNGN / FLWB66**N**C5NG becomes FDU76**W**AMDSNNGN / FLWB66**N**W5NG.

DISCLAIMER. All product information provided is, to the best of Dialight's knowledge, accurate as of the date of publication. When ordering, refer to www.dialight.com for current versions of: (a) relevant product documentation (including the relevant product data sheets); (b) Dialight terms and conditions of sale; and, (c) the relevant product warranty. To the extent that any contract is deemed formed between Dialight and the purchaser of Dialight products and/or an end-user, versions of documents available at www.dialight.com as at the date of sale shall be the versions incorporated therein. In the event of any discrepancy between this document or information provided at www.dialight.com, the latter shall prevail.

North American HQ

1501 Route 34 South
Farmingdale, NJ 07727
Tel: 732-919-3119
Fax: 732-751-5778
info@dialight.com

WARNING / DISCLAIMERS:

Installation & secondary retention. The use of this product without proper installation (including secondary retention / netting) and periodic inspections, could cause severe injury or death. Dialight recommends that all installations should use secondary retention / netting (appropriate to the installation environment) as applicable. Dialight products are intended for ultimate purchase, installation and operation by knowledgeable persons trained in the functional assessment, installation, use and maintenance of such products and all customers (including but not limited to end customers) are responsible for assessing the suitability of Dialight products for any given installation requirement. It is the exclusive responsibility of the contractor, installer and/or end-user to: (a) determine the suitability of the product for its intended application; and, (b) ensure that the product is safely installed (with secondary retention / netting as appropriate) and in compliance with all applicable laws and regulations.

Product specifications & warranties. All product information provided is, to the best of Dialight's knowledge, accurate as of the date of publication. All values and performance data herein are design or typical values when measured under laboratory conditions. The information herein is subject to change without notice. The products / software detailed herein are subject to applicable warranties and terms and conditions of use/purchase. Unless agreed otherwise in writing by an authorized representative of Dialight, Dialight does not represent that its products are fit for any particular purpose and accepts no liability for the installation and/or unauthorised use of its products. When ordering, refer to www.dialight.com for current versions of: (a) relevant product documentation (including relevant product data sheets); (b) Dialight terms and conditions of sale; and, (c) the relevant product warranties. To the extent that any contract is deemed formed between Dialight and the purchaser of Dialight products and/or an end-user, versions of documents available at www.dialight.com as at the date of sale shall be the versions incorporated therein. In the event of any discrepancy between this document and information provided at www.dialight.com, the latter shall prevail.

Exclusion of liability. To the extent permissible under the relevant law, Dialight disclaims all liability for personal injury and/or other damage resulting from any dislodgment or other dislocation of its products. Whilst Dialight has used its reasonable endeavours to ensure the completeness and accuracy of information herein, Dialight does not assume any liability for damages resulting from use of this information or for any third-party representations made in relation to Dialight products.