



ProSite LED Floodlight

Technical Specification Sheet - INMETRO

ProSite LED Floodlight - INMETRO

F1 Models



Certifications & Ratings

- 10 year warranty
- INMETRO Zone 2, 21 & 22
 - Ex ec IIC T4 Gc
 - Ex tb IIIC T110°C Db
 - BRA 22.GE0026X
- IP66/67
- IK08 - Glass lens
- L70 > 150,000 hours @ 25°C ambient

Angled Bracket

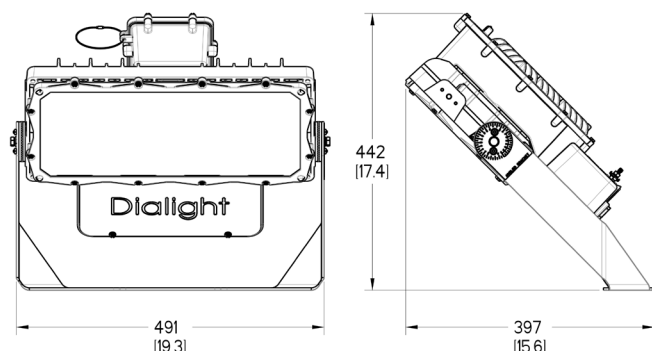

Dimensions in mm [inches]
Additional dimensional drawings on pages 12-13

Mechanical Information:

Fixture weight:	10.9 - 13.6 kg
Shipping weight:	~14.5 kg
EPA (m²):	0.186
Mounting:	316 stainless steel straight bracket (all with 7.5° tilt adjustment) 316 stainless steel angled bracket Slipfitter bracket
Cable entry:	2 x M25

Electrical Specifications:

Operating voltage:	120-277 VAC / 120-250 VDC 347-415-480 VAC
Operating temp:	-40°C to +65°C
EMC:	CISPR 15 Flicker: IEC 61000-3-3 Immunity requirements for lighting: IEC 61547 Harmonics: IEC 61000-3-2 Class C
Transient protection:	IEC 61000-4-5. 6kV line-line and line-ground.
THD:	< 20%
Power Factor:	> 0.9
Dimming:	DALI 2.0 compatible/0-10 VDC

Construction:

Housing:	A360 Die-cast aluminum
Hardware:	316 stainless steel
Finish:	Superior epoxy and polyester dual coat finish
Lens:	Glass

Photometric Information:

CRI:	70 (80 optional)
CCT:	5000K (cool white) 4000K (neutral white) 2200K (warm white) 2700K (warm white) - 80 CRI Amber
Beam pattern:	Medium - 55° Wide - 125° Very Wide - 131° x 108° Asymmetric - Forward Distribution

IES files: Available at www.dialight.com

All values typical unless otherwise stated (tolerance +/- 10%)

WARNING - INSTALLATION & SECONDARY RETENTION. Use of any Dialight products without proper installation (including secondary retention / netting) and periodic inspections could cause severe injury or death. Dialight recommends that all installations should use secondary retention / netting (appropriate to the installation environment) where applicable. It is the exclusive responsibility of the contractor, installer and/or end-user to: (a) determine the suitability of the product for its intended application; and, (b) ensure that the product is safely installed (with secondary retention / netting where appropriate) and in compliance with all applicable laws and regulations. To the extent permissible under applicable laws, Dialight disclaims all liability for personal injury and/or other damage resulting from any dislodgment or other dislocation of its products.

Ordering Information - F1

ProSite LED Floodlight - INMETRO



Hazardous - INMETRO							
Part Number	Fixture Lumens	Wattage	lm/W	Voltage	CCT	Lens	Beam Distribution
12,000lm Models							
F1L-77B2-BDEN-VGN	12,500	81	154	120-277VAC / 120-250VDC	5000k (cool white)	Glass	Very Wide (131° x 108°)
F1L-76B2-BDEN-VGN	12,500	81	154	120-277VAC / 120-250VDC	5000k (cool white)	Glass	Wide (125°)
F1L-74B2-BDEN-VGN	12,500	81	154	120-277VAC / 120-250VDC	5000k (cool white)	Glass	Medium (56°)
F1L-7FB2-BDEN-VGN	12,200	81	151	120-277VAC / 120-250VDC	5000k (cool white)	Glass	Asymmetric
F1L-77L2-BDEN-VGN	12,500	81	154	120-277VAC / 120-250VDC	4000k (neutral white)	Glass	Very Wide (131° x 108°)
F1L-76L2-BDEN-VGN	12,500	81	154	120-277VAC / 120-250VDC	4000k (neutral white)	Glass	Wide (125°)
F1L-74L2-BDEN-VGN	12,500	81	154	120-277VAC / 120-250VDC	4000k (neutral white)	Glass	Medium (56°)
F1L-7FL2-BDEN-VGN	12,200	81	151	120-277VAC / 120-250VDC	4000k (neutral white)	Glass	Asymmetric
18,000lm Models							
F1L-77B2-CDEN-VGN	18,000	124	145	120-277VAC / 120-250VDC	5000k (cool white)	Glass	Very Wide (131° x 108°)
F1L-76B2-CDEN-VGN	18,000	124	145	120-277VAC / 120-250VDC	5000k (cool white)	Glass	Wide (125°)
F1L-74B2-CDEN-VGN	18,000	124	145	120-277VAC / 120-250VDC	5000k (cool white)	Glass	Medium (56°)
F1L-7FB2-CDEN-VGN	17,700	124	143	120-277VAC / 120-250VDC	5000k (cool white)	Glass	Asymmetric
F1L-77L2-CDEN-VGN	18,000	124	145	120-277VAC / 120-250VDC	4000k (neutral white)	Glass	Very Wide (131° x 108°)
F1L-76L2-CDEN-VGN	18,000	124	145	120-277VAC / 120-250VDC	4000k (neutral white)	Glass	Wide (125°)
F1L-74L2-CDEN-VGN	18,000	124	145	120-277VAC / 120-250VDC	4000k (neutral white)	Glass	Medium (56°)
F1L-7FL2-CDEN-VGN	17,700	124	143	120-277VAC / 120-250VDC	4000k (neutral white)	Glass	Asymmetric
30,000lm Models							
F1L-77B2-FDEN-VGN	29,900	234	128	120-277VAC / 120-250VDC	5000k (cool white)	Glass	Very Wide (131° x 108°)
F1L-76B2-FDEN-VGN	29,900	234	128	120-277VAC / 120-250VDC	5000k (cool white)	Glass	Wide (125°)
F1L-74B2-FDEN-VGN	29,900	234	128	120-277VAC / 120-250VDC	5000k (cool white)	Glass	Medium (56°)
F1L-7FB2-FDEN-VGN	29,200	234	125	120-277VAC / 120-250VDC	5000k (cool white)	Glass	Asymmetric
F1L-77L2-FDEN-VGN	29,900	234	128	120-277VAC / 120-250VDC	4000k (neutral white)	Glass	Very Wide (131° x 108°)
F1L-76L2-FDEN-VGN	29,900	234	128	120-277VAC / 120-250VDC	4000k (neutral white)	Glass	Wide (125°)
F1L-74L2-FDEN-VGN	29,900	234	128	120-277VAC / 120-250VDC	4000k (neutral white)	Glass	Medium (56°)
F1L-7FL2-FDEN-VGN	29,200	234	125	120-277VAC / 120-250VDC	4000k (neutral white)	Glass	Asymmetric

All values typical unless otherwise stated (tolerance +/- 10%).

CCT - For 2700k change 6th character to 'W'. For 2200k change 6th character to 'U'. Refer to lumen table on page 6 for accurate values.

Mounting Bracket - Angled Bracket supplied as standard - for straight bracket change 10th character to 'F'.

ProSite LED Floodlight - INMETRO

F2 Models



Certifications & Ratings

- 10 year warranty
- INMETRO Zone 2, 21 & 22
 - Ex ec IIC T4 Gc
 - Ex tb IIIC T110°C Db
 - BRA 22.GE0026X
- IP66/67
- IK08 - Glass lens
- L70 > 150,000 hours @ 25°C ambient

Angled Bracket

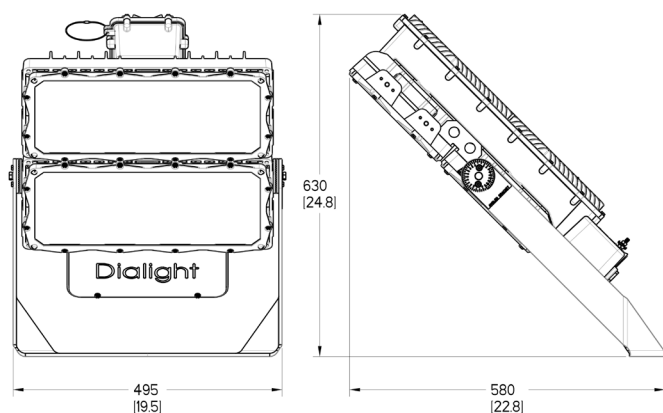

Dimensions in mm [inches]
Additional dimensional drawings on pages 12-13

Mechanical Information:

Fixture weight:	19.5 - 24.5 kg
Shipping weight:	~25.5 kg
EPA (m²):	0.310
Mounting:	316 stainless steel straight bracket (all with 7.5° tilt adjustment) 316 stainless steel angled bracket
Cable entry:	2 x M25

Electrical Specifications:

Operating voltage:	120-277 VAC / 120-250 VDC 347-415-480 VAC
Operating temp:	-40°C to +65°C -40°C to +55°C - 60klm
EMC:	CISPR 15 Flicker: IEC 61000-3-3 Immunity requirements for lighting: IEC 61547 Harmonics: IEC 61000-3-2 Class C
Transient protection:	IEC 61000-4-5. 6kV line-line and line-ground.
THD:	< 20%
Power Factor:	> 0.9
Dimming:	DALI 2.0 compatible/0-10 VDC

Construction:

Housing:	A360 Die-cast aluminum
Hardware:	316 stainless steel
Finish:	Superior epoxy and polyester dual coat finish
Lens:	Glass

Photometric Information:

CRI:	70 (80 optional)
CCT:	5000K (cool white) 4000K (neutral white) 2200K (warm white) 2700K (warm white) - 80 CRI Amber
Beam pattern:	Medium - 55° Wide - 125° Very Wide - 131° x 108° Asymmetric - Forward Distribution
IES files:	Available at www.dialight.com

All values typical unless otherwise stated (tolerance +/- 10%)

WARNING - INSTALLATION & SECONDARY RETENTION. Use of any Dialight products without proper installation (including secondary retention / netting) and periodic inspections could cause severe injury or death. Dialight recommends that all installations should use secondary retention / netting (appropriate to the installation environment) where applicable. It is the exclusive responsibility of the contractor, installer and/or end-user to: (a) determine the suitability of the product for its intended application; and, (b) ensure that the product is safely installed (with secondary retention / netting where appropriate) and in compliance with all applicable laws and regulations. To the extent permissible under applicable laws, Dialight disclaims all liability for personal injury and/or other damage resulting from any dislodgment or other dislocation of its products.

Ordering Information - F2

ProSite LED Floodlight - INMETRO



Hazardous - INMETRO							
Part Number	Fixture Lumens	Wattage	lm/W	Voltage	CCT	Lens	Beam Distribution
60,000lm Models							
F2L-77B2-NDEN-VGN	61,400	484	127	120-277VAC / 120-250VDC	5000k (cool white)	Glass	Very Wide (131° x 108°)
F2L-76B2-NDEN-VGN	61,400	484	127	120-277VAC / 120-250VDC	5000k (cool white)	Glass	Wide (125°)
F2L-74B2-NDEN-VGN	61,400	484	127	120-277VAC / 120-250VDC	5000k (cool white)	Glass	Medium (56°)
F2L-7FB2-NDEN-VGN	60,100	484	124	120-277VAC / 120-250VDC	5000k (cool white)	Glass	Asymmetric
F2L-77L2-NDEN-VGN	61,400	484	127	120-277VAC / 120-250VDC	4000k (neutral white)	Glass	Very Wide (131° x 108°)
F2L-76L2-NDEN-VGN	61,400	484	127	120-277VAC / 120-250VDC	4000k (neutral white)	Glass	Wide (125°)
F2L-74L2-NDEN-VGN	61,400	484	127	120-277VAC / 120-250VDC	4000k (neutral white)	Glass	Medium (56°)
F2L-7FL2-NDEN-VGN	60,100	484	124	120-277VAC / 120-250VDC	4000k (neutral white)	Glass	Asymmetric

All values typical unless otherwise stated (tolerance +/- 10%).

CCT - For 2700k change 6th character to 'W'. For 2200k change 6th character to 'U'. Refer to lumen table on page 6 for accurate values.

Mounting Bracket - Angled Bracket supplied as standard - for straight bracket change 10th character to 'F'.

Lumen Tables

Lumen Output Family	Wattage (120-277 VAC)	Wattage (347-480 VAC)	Optic	Glass Lens			
				5000K	4000K	2700K	2200K
12,000	81	84	Medium (NEMA 4)	12,500	12,500	9,500	9,700
			Wide (NEMA 6)	12,500	12,500	9,500	9,700
			Very Wide (NEMA 7x6)	12,500	12,500	9,500	9,700
			Asymmetric	11,600	11,600	8,600	8,800
18,000	124	128	Medium (NEMA 4)	18,000	18,000	13,800	14,000
			Wide (NEMA 6)	18,000	18,000	13,800	14,000
			Very Wide (NEMA 7x6)	18,000	18,000	13,800	14,000
			Asymmetric	16,700	16,700	12,400	12,700
24,000	175	179	Medium (NEMA 4)	23,600	23,600	18,000	18,400
			Wide (NEMA 6)	23,600	23,600	18,000	18,400
			Very Wide (NEMA 7x6)	23,600	23,600	18,000	18,400
			Asymmetric	21,900	21,900	16,300	16,600
F1 30,000	234	237	Medium (NEMA 4)	29,900	29,900	22,800	23,200
			Wide (NEMA 6)	29,900	29,900	22,800	23,200
			Very Wide (NEMA 7x6)	29,900	29,900	22,800	23,200
			Asymmetric	27,700	27,700	20,500	21,000
F2 30,000	200	206	Medium (NEMA 4)	30,200	30,200	23,000	23,500
			Wide (NEMA 6)	30,200	30,200	23,000	23,500
			Very Wide (NEMA 7x6)	30,200	30,200	23,000	23,500
			Asymmetric	28,000	28,000	20,800	21,300
36,000	234	241	Medium (NEMA 4)	35,400	35,400	27,000	27,600
			Wide (NEMA 6)	35,400	35,400	27,000	27,600
			Very Wide (NEMA 7x6)	35,400	35,400	27,000	27,600
			Asymmetric	32,800	32,800	24,400	24,900
48,000	346	357	Medium (NEMA 4)	48,200	48,200	36,700	37,500
			Wide (NEMA 6)	48,200	48,200	36,700	37,500
			Very Wide (NEMA 7x6)	48,200	48,200	36,700	37,500
			Asymmetric	44,600	44,600	33,200	33,900
60,000	484	499	Medium (NEMA 4)	61,400	61,400	46,800	47,800
			Wide (NEMA 6)	61,400	61,400	46,800	47,800
			Very Wide (NEMA 7x6)	61,400	61,400	46,800	47,800
			Asymmetric	56,900	56,900	42,300	43,200

DISCLAIMER. All product information provided is, to the best of Dialight's knowledge, accurate as of the date of publication. When ordering, refer to www.dialight.com for current versions of: (a) relevant product documentation (including the relevant product data sheets); (b) Dialight terms and conditions of sale; and, (c) the relevant product warranty. To the extent that any contract is deemed formed between Dialight and the purchaser of Dialight products and/or an end-user, versions of documents available at www.dialight.com as at the date of sale shall be the versions incorporated therein. In the event of any discrepancy between this document or information provided at www.dialight.com, the latter shall prevail.

Inrush Current

F1 Models					
VAC	120	240	347	415	480
Peak inrush current (A)	7.7	15.4	4.1	4.9	5.7
Duration, T50 (ms)	1.5	1.5	1.5	1.5	1.5
F2 Models (30 - 36klm)					
Peak inrush current (A)	7.7	15.4	4.1	4.9	5.7
Duration, T50 (ms)	1.5	1.5	1.5	1.5	1.5
F2 Models (48 - 65klm)					
Peak inrush current (A)	15.4	30.8	8.2	9.8	11.4
Duration, T50 (ms)	1.5	1.5	1.5	1.5	1.5

DISCLAIMER. All product information provided is, to the best of Dialight's knowledge, accurate as of the date of publication. When ordering, refer to www.dialight.com for current versions of: (a) relevant product documentation (including the relevant product data sheets); (b) Dialight terms and conditions of sale; and, (c) the relevant product warranty. To the extent that any contract is deemed formed between Dialight and the purchaser of Dialight products and/or an end-user, versions of documents available at www.dialight.com as at the date of sale shall be the versions incorporated therein. In the event of any discrepancy between this document or information provided at www.dialight.com, the latter shall prevail.

Maximum per Circuit Breaker

120 VAC			
Lumen Output	10 Amp	16 Amp	20 Amp
12,000	9	14	17
18,000	6	9	11
24,000	4	6	8
30,000 F1	3	5	6
30,000F2	4	6	7
36,000	3	5	6
48,000	2	3	4
60,000	1	2	3
12,000 Amber	3	5	6
24,000 Amber	2	2	3

240 VAC		
10 Amp	16 Amp	20 Amp
17	28	35
11	18	23
8	13	16
6	10	12
7	11	14
6	10	12
4	7	8
3	5	6
6	10	13
3	5	6

277 VAC			
Lumen Output	10 Amp	16 Amp	20 Amp
12,000	20	32	40
18,000	13	21	26
24,000	9	15	19
30,000 F1	7	11	14
30,000F2	8	13	16
36,000	7	11	14
48,000	5	8	9
60,000	3	5	7
12,000 Amber	7	12	14
24,000 Amber	4	6	7

415 VAC		
10 Amp	16 Amp	20 Amp
29	47	58
19	31	38
14	22	27
10	17	21
12	19	24
10	16	20
7	11	14
5	8	10
11	17	21
5	8	10

Dialight recommends using B or C type breakers.

These tables are based on steady-state input current and nominal breaker current ratings @ 80% derating.

DISCLAIMER. All product information provided is, to the best of Dialight's knowledge, accurate as of the date of publication. When ordering, refer to www.dialight.com for current versions of: (a) relevant product documentation (including the relevant product data sheets); (b) Dialight terms and conditions of sale; and, (c) the relevant product warranty. To the extent that any contract is deemed formed between Dialight and the purchaser of Dialight products and/or an end-user, versions of documents available at www.dialight.com as at the date of sale shall be the versions incorporated therein. In the event of any discrepancy between this document or information provided at www.dialight.com, the latter shall prevail.

Beam Distribution

Medium - 55°

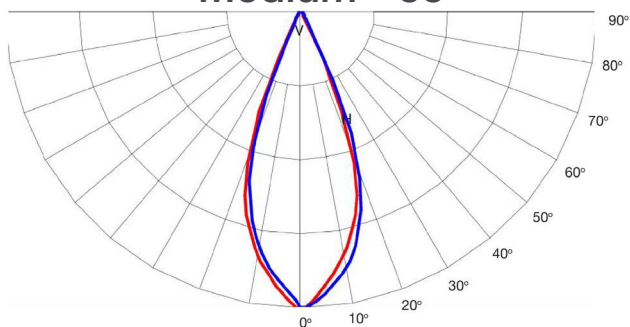

Wide - 125°

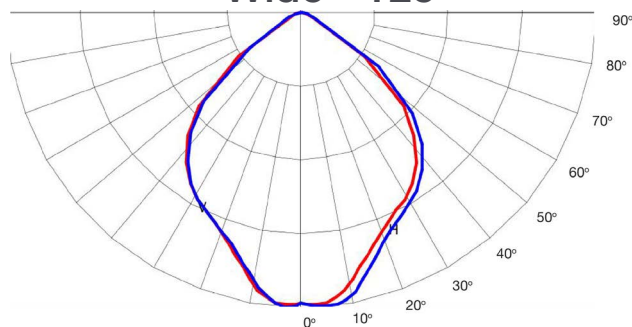

Very Wide - 131°x108°

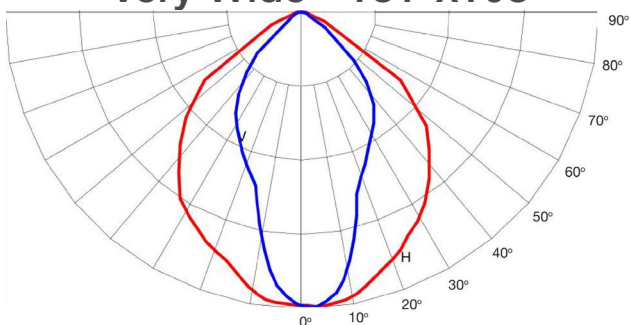

Asymmetric - Forward Distribution

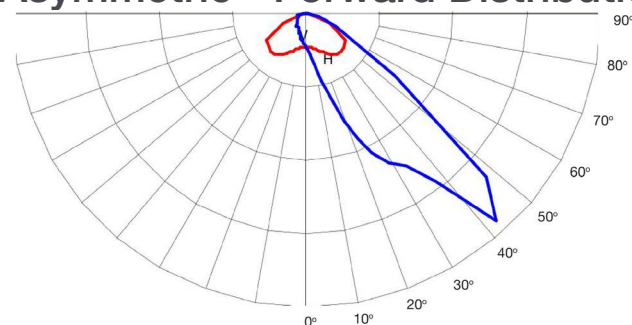

DISCLAIMER. All product information provided is, to the best of Dialight's knowledge, accurate as of the date of publication. When ordering, refer to www.dialight.com for current versions of: (a) relevant product documentation (including the relevant product data sheets); (b) Dialight terms and conditions of sale; and, (c) the relevant product warranty. To the extent that any contract is deemed formed between Dialight and the purchaser of Dialight products and/or an end-user, versions of documents available at www.dialight.com as at the date of sale shall be the versions incorporated therein. In the event of any discrepancy between this document or information provided at www.dialight.com, the latter shall prevail.

Lumen Maintenance Factor - F1

F1 Floodlight 12k lm (Hours)									
Ambient	0	15000	30000	45000	60000	75000	90000	100000	150000
25°C	100%	98%	97%	96%	96%	95%	94%	93%	91%
30°C	99%	97%	96%	95%	95%	94%	93%	92%	90%
35°C	98%	96%	96%	95%	95%	94%	93%	92%	90%
40°C	98%	96%	95%	94%	94%	93%	92%	91%	89%
45°C	97%	95%	94%	93%	93%	92%	91%	90%	88%
50°C	96%	94%	94%	93%	93%	92%	91%	90%	88%
55°C	96%	94%	93%	92%	91%	90%	90%	89%	87%
60°C	95%	93%	92%	91%	91%	90%	89%	89%	86%
65°C	94%	92%	92%	91%	90%	89%	88%	88%	85%

F1 Floodlight 18k lm (Hours)									
Ambient	0	15000	30000	45000	60000	75000	90000	100000	150000
25°C	100%	98%	97%	96%	96%	95%	94%	93%	91%
30°C	99%	97%	96%	95%	95%	94%	93%	92%	90%
35°C	98%	96%	96%	95%	95%	94%	93%	92%	90%
40°C	98%	96%	95%	94%	94%	93%	92%	91%	89%
45°C	97%	95%	94%	93%	93%	92%	91%	90%	88%
50°C	96%	94%	94%	93%	93%	92%	91%	90%	88%
55°C	96%	94%	93%	92%	91%	90%	90%	89%	87%
60°C	95%	93%	92%	91%	91%	90%	89%	89%	86%
65°C	94%	92%	92%	91%	90%	89%	88%	88%	85%

F1 Floodlight 30k lm (Hours)									
Ambient	0	15000	30000	45000	60000	75000	90000	100000	150000
25°C	100%	98%	95%	93%	91%	89%	87%	85%	79%
30°C	99%	97%	94%	92%	90%	88%	86%	84%	78%
35°C	98%	96%	93%	91%	89%	87%	85%	83%	77%
40°C	97%	94%	92%	90%	88%	85%	83%	82%	76%
45°C	96%	93%	91%	88%	86%	84%	82%	81%	74%
50°C	94%	92%	90%	87%	85%	83%	81%	79%	72%
55°C	93%	91%	88%	86%	84%	81%	79%	78%	71%
60°C	92%	90%	87%	85%	82%	80%	78%	76%	70%
65°C	91%	88%	86%	84%	81%	79%	77%	75%	68%

DISCLAIMER. All product information provided is, to the best of Dialight's knowledge, accurate as of the date of publication. When ordering, refer to www.dialight.com for current versions of: (a) relevant product documentation (including the relevant product data sheets); (b) Dialight terms and conditions of sale; and, (c) the relevant product warranty. To the extent that any contract is deemed formed between Dialight and the purchaser of Dialight products and/or an end-user, versions of documents available at www.dialight.com as at the date of sale shall be the versions incorporated therein. In the event of any discrepancy between this document or information provided at www.dialight.com, the latter shall prevail.

Lumen Maintenance Factor - F2

F2 Floodlight 36k lm (Hours)									
Ambient	0	15000	30000	45000	60000	75000	90000	100000	150000
25°C	100%	98%	97%	96%	96%	95%	94%	93%	91%
30°C	99%	97%	96%	96%	95%	94%	93%	93%	90%
35°C	98%	97%	96%	95%	94%	93%	92%	92%	89%
40°C	98%	96%	95%	94%	93%	93%	92%	91%	89%
45°C	97%	95%	94%	94%	93%	92%	91%	91%	88%
50°C	96%	94%	94%	93%	92%	91%	90%	90%	87%
55°C	96%	94%	93%	92%	91%	90%	90%	89%	87%
60°C	95%	93%	92%	91%	91%	90%	89%	88%	86%
65°C	94%	92%	92%	91%	90%	89%	88%	88%	85%

F2 Floodlight 60k lm (Hours)									
Ambient	0	15000	30000	45000	60000	75000	90000	100000	150000
25°C	100%	98%	95%	93%	91%	89%	87%	85%	79%
30°C	99%	96%	94%	92%	90%	88%	86%	84%	78%
35°C	98%	95%	93%	91%	88%	86%	84%	83%	76%
40°C	96%	94%	92%	89%	87%	85%	83%	81%	75%
45°C	95%	93%	90%	88%	86%	83%	81%	80%	73%
50°C	94%	91%	89%	87%	84%	82%	80%	78%	72%
55°C	93%	90%	88%	85%	83%	80%	78%	77%	70%

DISCLAIMER. All product information provided is, to the best of Dialight's knowledge, accurate as of the date of publication. When ordering, refer to www.dialight.com for current versions of: (a) relevant product documentation (including the relevant product data sheets); (b) Dialight terms and conditions of sale; and, (c) the relevant product warranty. To the extent that any contract is deemed formed between Dialight and the purchaser of Dialight products and/or an end-user, versions of documents available at www.dialight.com as at the date of sale shall be the versions incorporated therein. In the event of any discrepancy between this document or information provided at www.dialight.com, the latter shall prevail.

Dimensional Drawings

F1 Straight Bracket

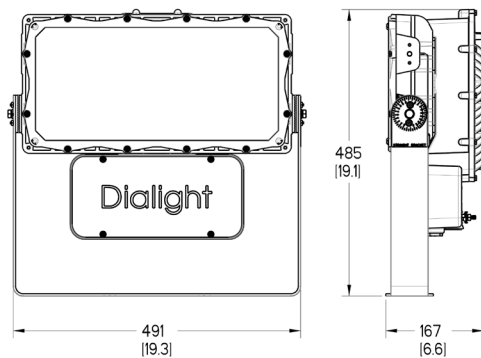

F2 Straight Bracket

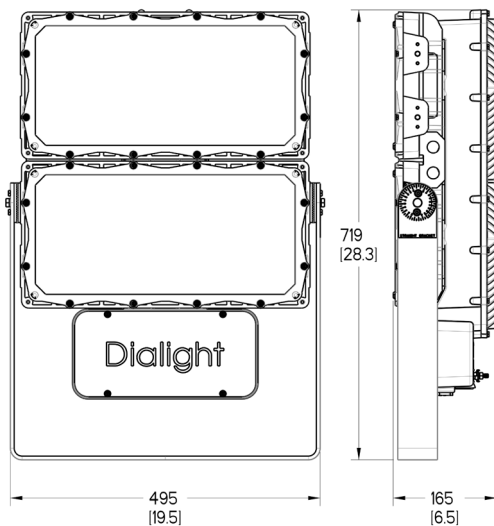

Dimensions in mm [inches]

DISCLAIMER. All product information provided is, to the best of Dialight's knowledge, accurate as of the date of publication. When ordering, refer to www.dialight.com for current versions of: (a) relevant product documentation (including the relevant product data sheets); (b) Dialight terms and conditions of sale; and, (c) the relevant product warranty. To the extent that any contract is deemed formed between Dialight and the purchaser of Dialight products and/or an end-user, versions of documents available at www.dialight.com as at the date of sale shall be the versions incorporated therein. In the event of any discrepancy between this document or information provided at www.dialight.com, the latter shall prevail.

Dimensional Drawings

F1 Mounting Bracket

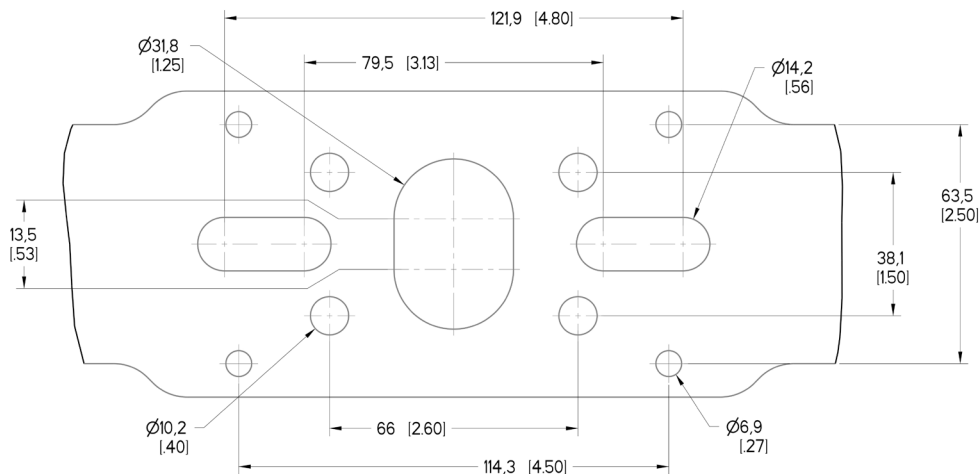

F2 Mounting Bracket

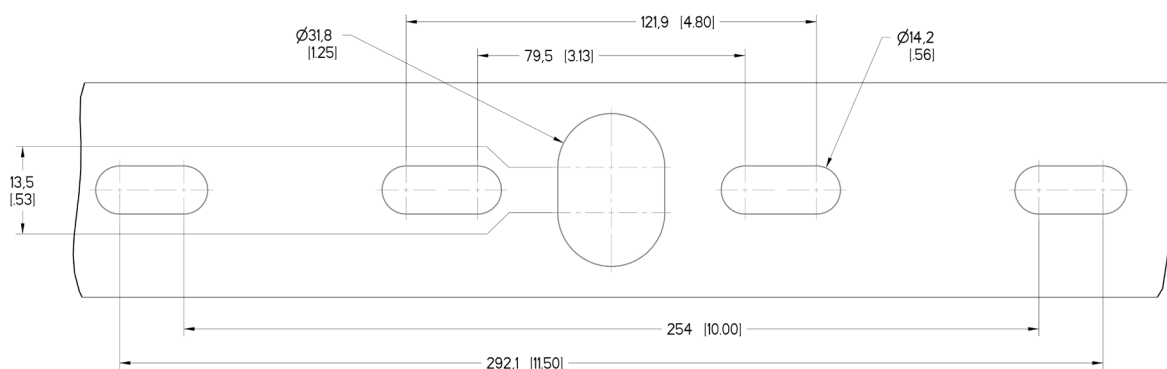

Dimensions in mm [inches]

DISCLAIMER. All product information provided is, to the best of Dialight's knowledge, accurate as of the date of publication. When ordering, refer to www.dialight.com for current versions of: (a) relevant product documentation (including the relevant product data sheets); (b) Dialight terms and conditions of sale; and, (c) the relevant product warranty. To the extent that any contract is deemed formed between Dialight and the purchaser of Dialight products and/or an end-user, versions of documents available at www.dialight.com as at the date of sale shall be the versions incorporated therein. In the event of any discrepancy between this document or information provided at www.dialight.com, the latter shall prevail.

Accessories



F1NVISOR

- F1 visor NEMA optics

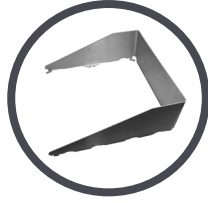

F2NVISOR

- F2 visor NEMA optics



F2AVISOR

- F2 visor asymmetric optics
- Not suitable for asymmetric wide optic



H6XCAB72¹

- 72" stainless steel safety rope
- Kit includes: (1) cable

H6XCAB60¹

- 60" stainless steel safety rope
- Kit includes: (1) cable

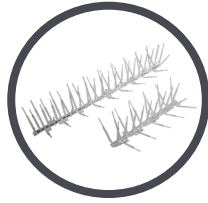

F1SPIKES F2SPIKES

- Bird spikes

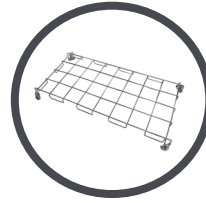

FLWG

- Wire guard
- Kit includes (1) assembly

¹F1 models require 1 cable per unit. F2 models require 2 cables per unit.

North American HQ

1501 Route 34 South
Farmingdale, NJ 07727
Tel: 732-919-3119
Fax: 732-751-5778
info@dialight.com

Australia

108 Howe Street
Osborne Park, WA 6017
Tel: +61 (0) 8 9244 7600
Fax: +61 (0) 8 9244 7601
info@dialight.com.au

Dialight Europe Ltd

Highdown House, Yeoman Way,
Worthing, England BN99 3HH
Tel: +44 (0) 203 058 3540
Customer Service: +44 (0) 163 866 6541
sales-emea@dialight.com

Southeast Asia

56 Kallang Pudding Road
#09 – 08 HH@Kallang
Singapore 349328
Tel: +65 6578 7271
Fax: +65 6578 7150
enquiry@dialight.com.sg

Middle East

Level 23 – Boulevard Plaza Tower 2
Emaar Boulevard, Dubai, U.A.E.
P.O. Box 124342
Tel: +971 (4) 409-6962
Fax: +971 (4) 409-6850

WARNING / DISCLAIMERS:

Installation & secondary retention. The use of this product without proper installation (including secondary retention / netting) and periodic inspections, could cause severe injury or death. Dialight recommends that all installations should use secondary retention / netting (appropriate to the installation environment) as applicable. Dialight products are intended for ultimate purchase, installation and operation by knowledgeable persons trained in the functional assessment, installation, use and maintenance of such products and all customers (including but not limited to end customers) are responsible for assessing the suitability of Dialight products for any given installation requirement. It is the exclusive responsibility of the contractor, installer and/or end-user to: (a) determine the suitability of the product for its intended application; and, (b) ensure that the product is safely installed (with secondary retention / netting as appropriate) and in compliance with all applicable laws and regulations.

Product specifications & warranties. All product information provided is, to the best of Dialight's knowledge, accurate as of the date of publication. All values and performance data herein are design or typical values when measured under laboratory conditions. The information herein is subject to change without notice. The products / software detailed herein are subject to applicable warranties and terms and conditions of use/purchase. Unless agreed otherwise in writing by an authorized representative of Dialight, Dialight does not represent that its products are fit for any particular purpose and accepts no liability for the installation and/or unauthorised use of its products. When ordering, refer to www.dialight.com for current versions of: (a) relevant product documentation (including relevant product data sheets); (b) Dialight terms and conditions of sale; and, (c) the relevant product warranties. To the extent that any contract is deemed formed between Dialight and the purchaser of Dialight products and/or an end-user, versions of documents available at www.dialight.com as at the date of sale shall be the versions incorporated therein. In the event of any discrepancy between this document and information provided at www.dialight.com, the latter shall prevail.

Exclusion of liability. To the extent permissible under the relevant law, Dialight disclaims all liability for personal injury and/or other damage resulting from any dislodgment or other dislocation of its products. Whilst Dialight has used its reasonable endeavours to ensure the completeness and accuracy of information herein, Dialight does not assume any liability for damages resulting from use of this information or for any third-party representations made in relation to Dialight products.