

.....Dialight

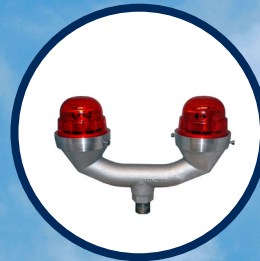

Obstruction LED Solutions

High, Medium & Low Intensity Systems



JANUARY 2024



DIALIGHT IS THE INNOVATION AND MARKET LEADER IN LED OBSTRUCTION SOLUTIONS FOR MORE THAN 20 YEARS

SAFE

Dialight LED systems have Infrared (IR) LEDs for visibility by pilots utilizing Night Vision Goggles (NVGs) or Night Vision Imaging Systems (NVIS).



DIFFERENTIATED

Dialight offers the industry's most comprehensive, energy-efficient and reliable line of LED-based obstruction solution systems in the world. Our precision patented optics ensure maximum safety with minimal ground scatter for community-friendly illumination.



CONVENIENT

Dialight systems offer a small, light-weight flash head for ease of installation, while our low-maintenance fixtures virtually eliminate tower climbs and unplanned site visits for years, dramatically reducing maintenance costs and non-compliance risk.



INTELLIGENT

Dialight controlled LED Obstruction solutions can be seamlessly integrated into existing operation and control centers while providing additional valuable information, both locally and remotely.



TRUSTED

Every Dialight LED Obstruction system is fully certified and compliant with FAA, TC, ICAO, and international standards, for dependability and performance you can trust.

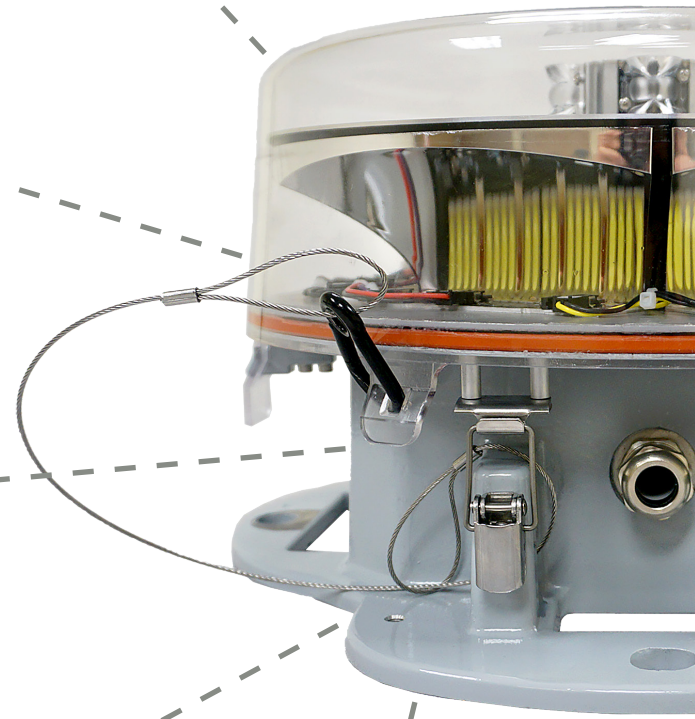

FEATURES & BENEFITS

- Compliant to FAA Infrared (IR) standards AC 150/5345-43J and EB 98
- 5 year warranty
- Resistant to shock and vibration
- High impact polycarbonate lens with UV, scratch and chemical resistant coating
- Reduction in tower climbs for lower maintenance costs/unplanned site visits
- Community friendly lighting system utilizing patented optics

Dialight's LED Technology Innovations Over the Years

First ever FAA certified LED obstruction lights with IR

Vigilant® LED Based L-864/L-856 High Intensity System



2011

Current

Vigilant® LED Based L-810 Red



1999

Current

Vigilant® LED Based L-864 Red Beacon



2001

Current

Vigilant® LED Based L-864/L-865 Flashing Dual (Red/White) System



2007

Current

Dialight Timeline

First IR enabled LED product launched in 2011, nearly 10 years before FAA regulation

1999	2001	2007	2011	2012	2013	2015	2020
• L810	• L864	• L864 / L865	• L856 • added IR to L810	• L864 / L856	• added IR to L864	• added IR to L864 / L865	• FAA requires IR

Table of Contents

●	System Monitoring Software	
	INEM® Obstruction Lighting Remote Control & Monitoring System	4–5
●	High Intensity Products	
	Vigilant® D366 LED with IR High Intensity System L-864/L-856	6–7
●	Medium Intensity Products	
	Vigilant® D1CW LED with IR Medium Intensity System L-864/L-865	8–10
	Vigilant® D6C LED with IR Medium Intensity L-864	11–12
●	Low Intensity Products	
	Vigilant® RTO LED with IR Low Intensity L-810	13
	Vigilant® RTO LED Low Intensity L-810	14
	Vigilant® 860 LED Based Low Intensity L-810	15

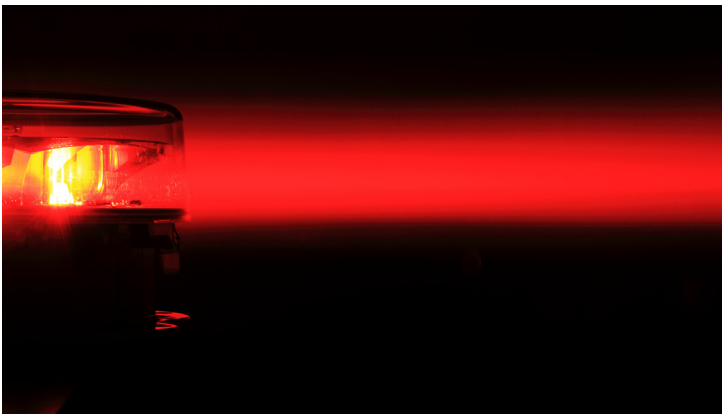

Patented Optics

Minimum ground scatter for a “community-friendly” lighting system

Dialight (LSE: DIA.L) is leading the energy efficient LED lighting revolution around the world for industrial and hazardous areas as well as for transportation and infrastructure applications. For 40 years we have been committed to the development of LED lighting solutions that enable organizations to vastly reduce energy use and maintenance needs, improve safety, ease disposal and reduce CO2 emissions.

INEM[®] Remote Control & Monitoring System

Cellular & Ethernet Connectivity

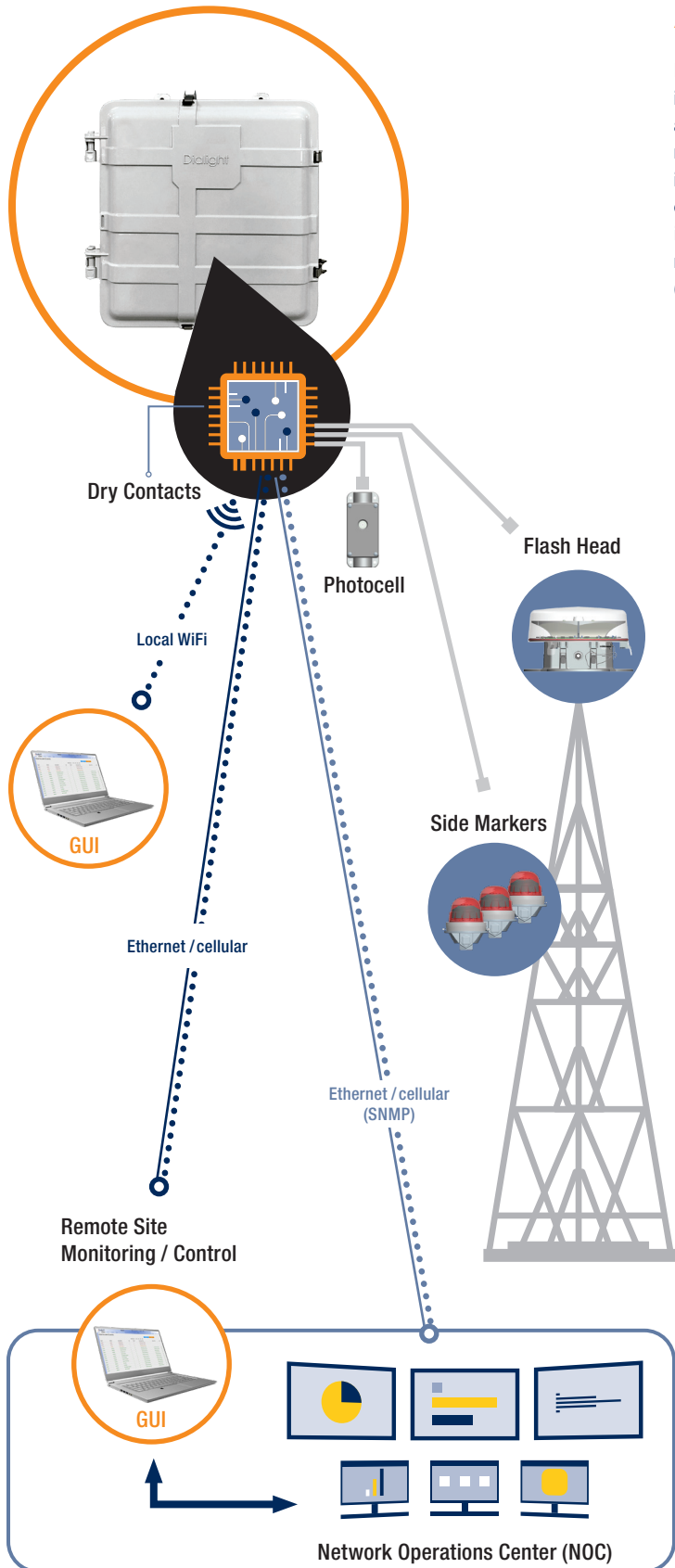

Application

Dialight's INEM[®] Obstruction Lighting Remote Control and Monitoring System is an integrated software application that enables remote management and tracking of lighting systems via ethernet, cellular, and/or local wifi networks. The system is also capable of transmitting SNMP traps for NOC integration. Operating in conjunction with Dialight's Obstruction Lighting controllers, the INEM[®] system can be packaged as a standalone unit or be integrated into Dialight controller cabinets. The INEM[®] system operates with red low/medium intensity (L-810/L864), dual red/white medium intensity (L-864/L-865), or high intensity (L-864/L-856) lighting systems.

Features & Benefits

- Web interface to configure, control, and monitor lighting system
- User friendly Graphical User Interface (GUI)
- Remote lighting inspections
- Over-the-air system programming for software updates
- Alarm/event logging
- Data reports
- Local wifi to access/ configure system
- Provisions for battery back-up connectivity with low voltage disconnect
- New systems or retrofit existing systems
- Compatible with NOC software
- SNMP trap flexibility
- Can be used with cellular modem or ethernet

INEM® Obstruction Lighting Remote Control & Monitoring System GUI

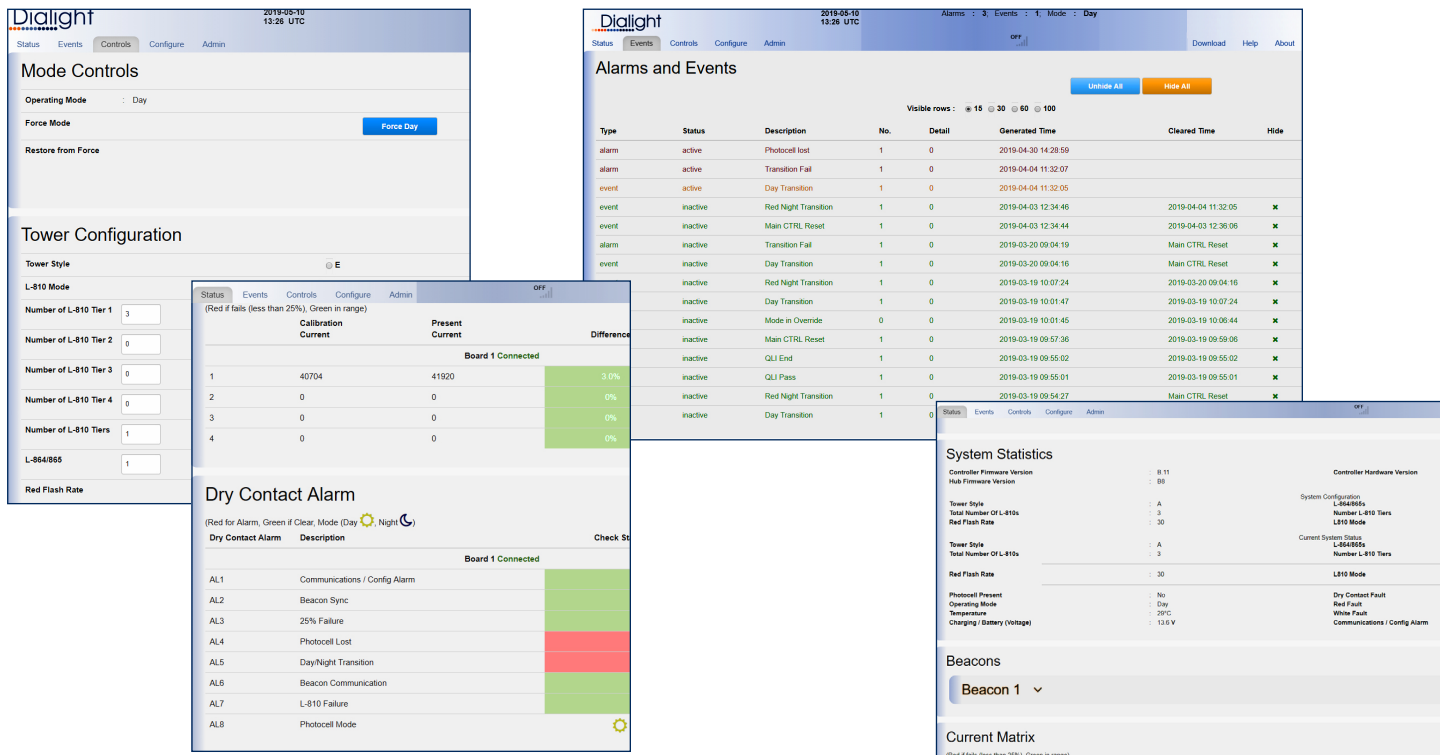

Remote or Onsite Web Interface Provides:

- Lighting system status and diagnostics
- Configuration options
- Control of lighting system
- Ability to change modes
- Initiation of lighting inspections
- Over-the-air programming
- Event and alarm logs
- Data reports
- Remote system reset
- Site information

Dialight P/N	Description	Voltage
DNEM01N	INEM® Obstruction Lighting Remote Control & Monitoring System (standalone)	120–240 VAC
DNEM04N	INEM® Obstruction Lighting Remote Control & Monitoring System (standalone)	± 48 VDC
D366A57CTRACN	D366 High Intensity Controller with Integrated INEM®	208–277 VAC
D1CWCTR409N	D1CW Medium Intensity Controller with Integrated INEM®	120–277 VAC
D1CWCTR449N	D1CW Medium Intensity Controller with Integrated INEM®	48 VDC

Vigilant® LED High Intensity System L-864 / L-856

High Intensity (Red / White) System with Infrared (IR)

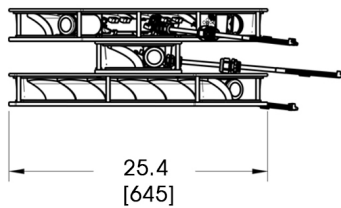
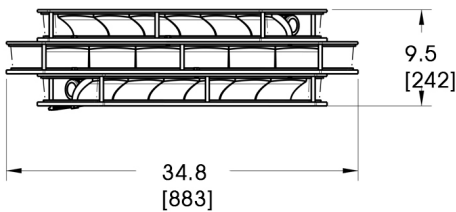
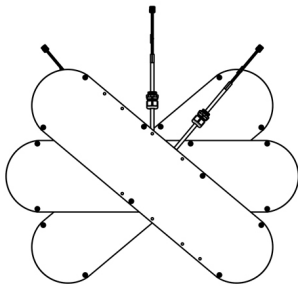

Dimensions in inches [mm]

Certifications & Compliance

- FAA AC 150/5345 - 43J
- FAA EB No. 67D and 98
- IP66
- NEMA 4X

Features & Benefits

- 5 year warranty
- ETL verified to FAA standards
- IR wavelength at 850 nm
- Superior surge and lightning protection
- Controller can be mounted at the base of the structure
- IP66/NEMA 4X outdoor rated enclosures
- Low power consumption
- IP66 rated light fixtures
- Impact and vibration resistant
- Provision for padlock on the enclosure
- Patented optics for minimal down light/ground scatter
- Dry contacts for alarm monitoring/status
 - › Photocell alarm
 - › Sync alarm
 - › White mode alarm
 - › Red mode alarm
 - › Communication
 - › Operation mode (day/night)
 - › Power fail

Technical Information:

Flash head weight:	63 lbs (30 kg)
Operating voltage:	208–277 VAC 50/60 Hz
Effective intensity:	White Day - 270,000 cd White Twilight - 20,000 cd White Night - 2,000 cd Red - 2,000 cd IR - 246 mW/sr
Wattage:	White Day - 220 W White Twilight - 40 W White Night - 30 W Red/IR - 33 W
Power factor:	> 0.9
Ambient temperature:	-40 °F to +131 °F (-40 °C to +55 °C)
Synchronization:	Multiple unit sync from single controller

All values typical unless otherwise stated (tolerance ± 10%)

US Patents: #7,281,821 | #9,423,086 | #9,581,309 (other patents pending)

Part Number	Description	Voltage	Certification
D366A57270	Flash head (120°) and power supply	208–277 VAC	FAA
D366A57CTRAC	Base controller w/ display	208–277 VAC	FAA
D366A57CTRACN	Base controller w/ display and integrated INEM	208–277 VAC	FAA
D2566000PEC	Day/Twilight/Night photocell w/ enclosure and 3/4 inch conduit entry	—	FAA
D1CWKITAOL	Aviation obstruction light (AOL) & power supply kit for FAA, Types C & F	208–277 VAC	FAA

Intertek verified FAA compliant system number D366A57SYS

Vigilant® LED High Intensity System L-864 / L-856

High Intensity (Red / White) System with Infrared (IR)

FAA Type B, C, F & G

Application

The Dialight Vigilant® High Intensity System is the first all LED L-864/L-856 unit designed for the lighting of communication towers, chimneys, smoke stacks, broadcast towers and other tall obstructions to aerial navigation, as specified by the FAA and ICAO.

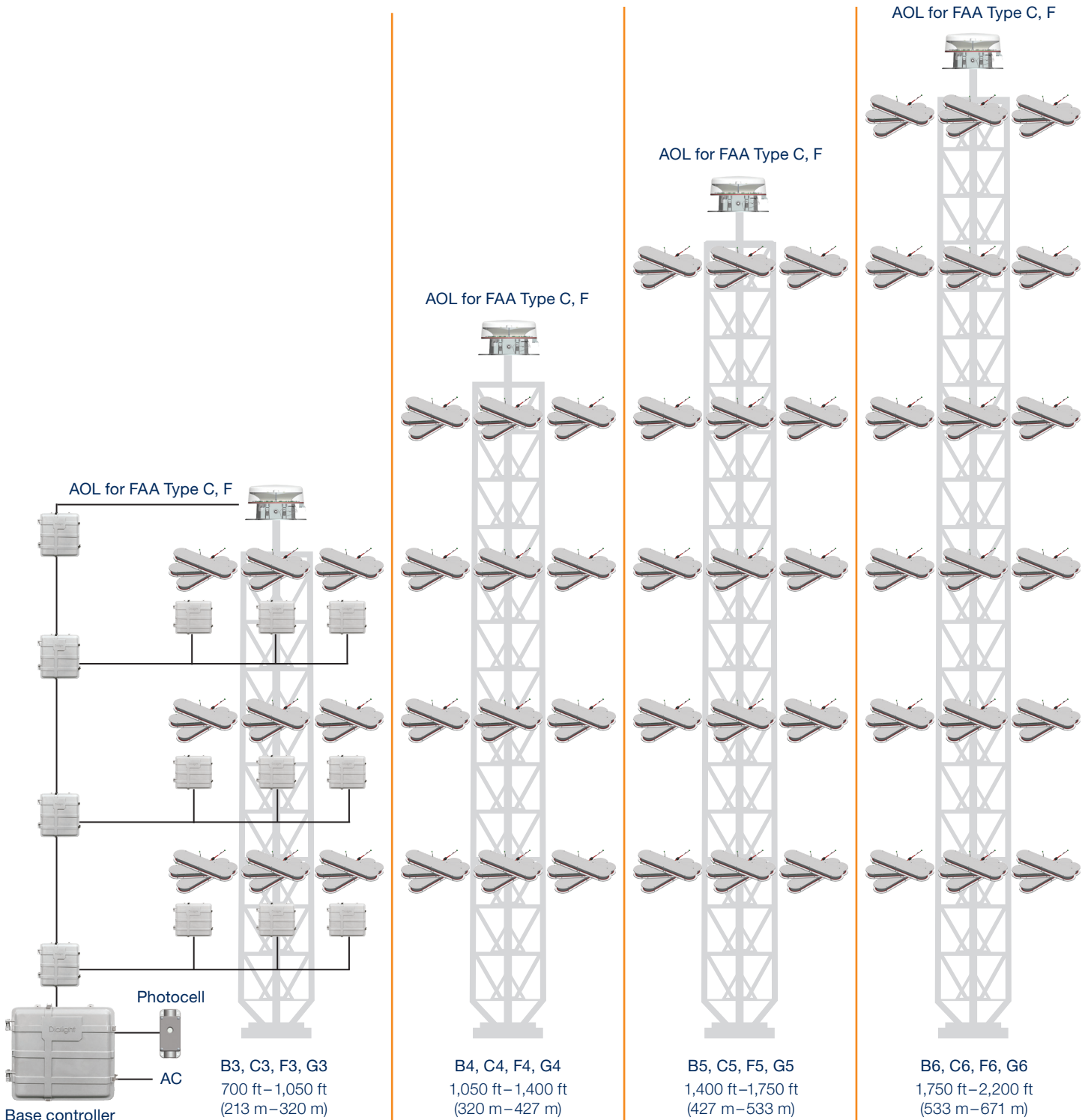

Vigilant® LED Medium Intensity System L-864 / L-865

Medium Intensity (Red / White) System with Infrared (IR)

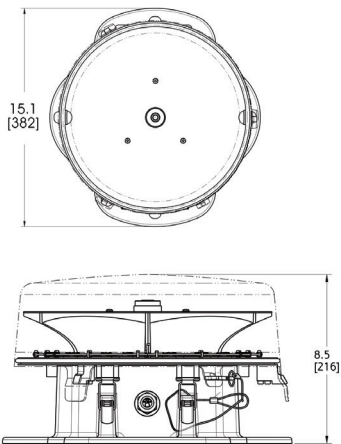

Dimensions in inches [mm]

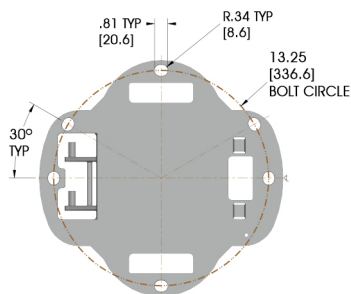

Flip top design for simple installation

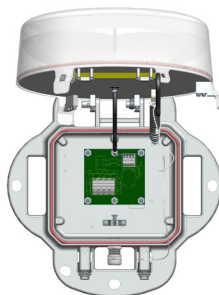

Certifications & Compliance

- FAA AC 150/5345 - 43J
- FAA EB No. 67D and 98
- IP66
- NEMA 4X

Features & Benefits

- 5 year warranty
- ETL verified to FAA standards
- IR wavelength at 850 nm
- Superior surge and lightning protection
- Patented optics for minimal down light / ground scatter
- Remote monitoring options available
- Integrated controller with LCD backlit display
- Universal 120–277 VAC input or 48 VDC input
- IP66/NEMA 4X outdoor rated enclosure
- Provisions for padlock on the enclosure

Cable

- Recommended UV rated 4 conductor cable with metal foil and braid. 14AWG (2.08 mm²) for lengths up to 680' (207 m) or 12AWG (3.31 mm²) for lengths above 680' (207 m).
- Complete kits available: D1, E1, E1+1, E2, D2, E2+1 and D2+1

Technical Information:

Flash head weight:	21 lbs (9.5 kg)
Operating voltage:	120-277 VAC 50/60 Hz or 48 VDC power factor corrected supply
Supply voltage ranges:	Nominal ± 10%
Effective intensity:	White Day - 20,000 cd White Night - 2,000 cd Red Night - 2,000 cd IR - 246 mW/sr
Flash head power:	White Day - 36 W (system = 75 w) White Night - 4 W (system = 10 w) Red/IR Night - 15 W (system = 28 w)
Power factor:	> 0.9
Operating temperature:	-40 °F to +131 °F (-40 °C to +55 °C)
Synchronization:	Multiple unit sync from single controller
All values typical unless otherwise stated (tolerance ± 10%)	

US Patents: #7,208,881 | #7,568,821 | #7,604,380 | #7,777,424 | #9,423,086 | #9,476,548 | #9,581,309

Vigilant® LED Medium Intensity System L-864 / L-865

Medium Intensity (Red / White) System with Infrared (IR)

FAA Type D & E

Application

Dialight's LED based obstruction system is ideal for D & E style FAA communication tower types and can be used to mark other structures as well. The operation of the lights is configurable and fully monitored. The side markers can be run in steady burn or flashing mode. The lights are ETL verified to the FAA requirements.

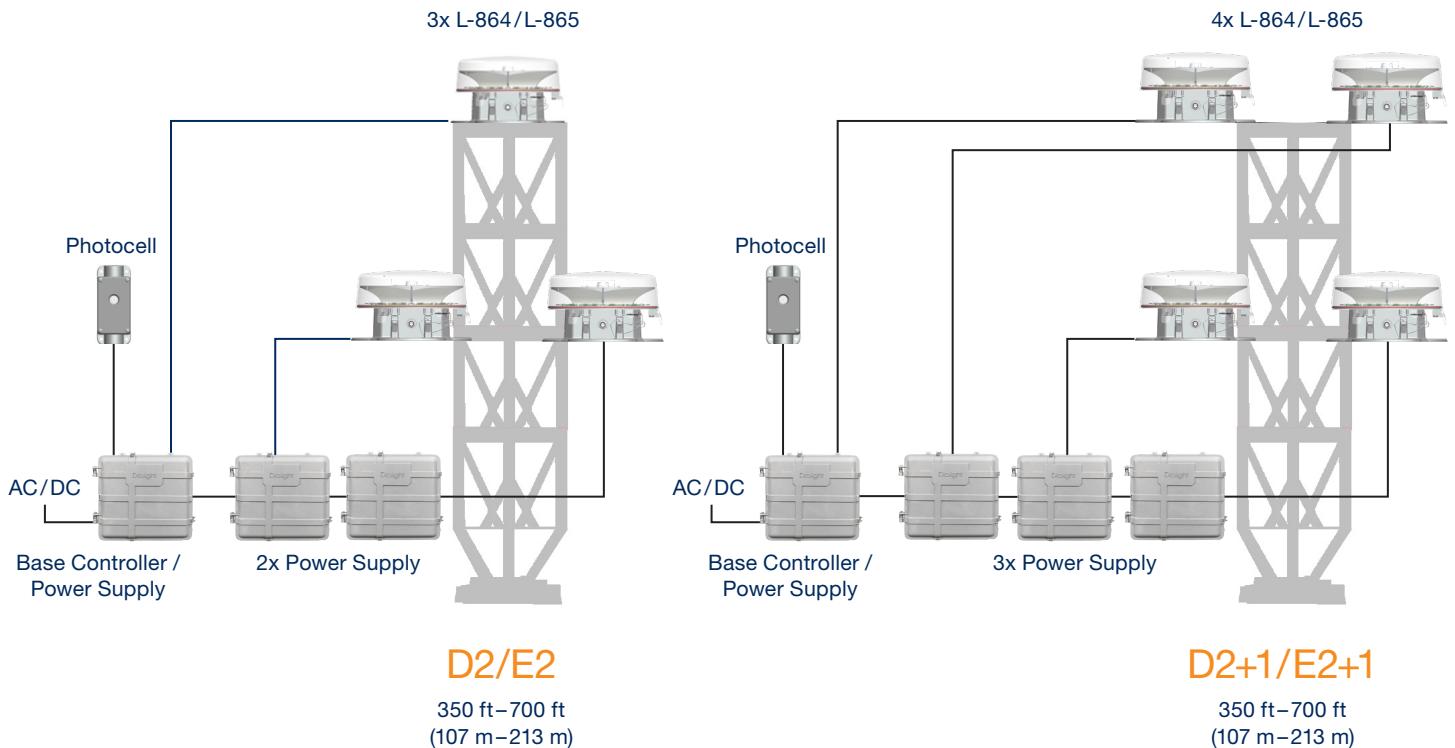
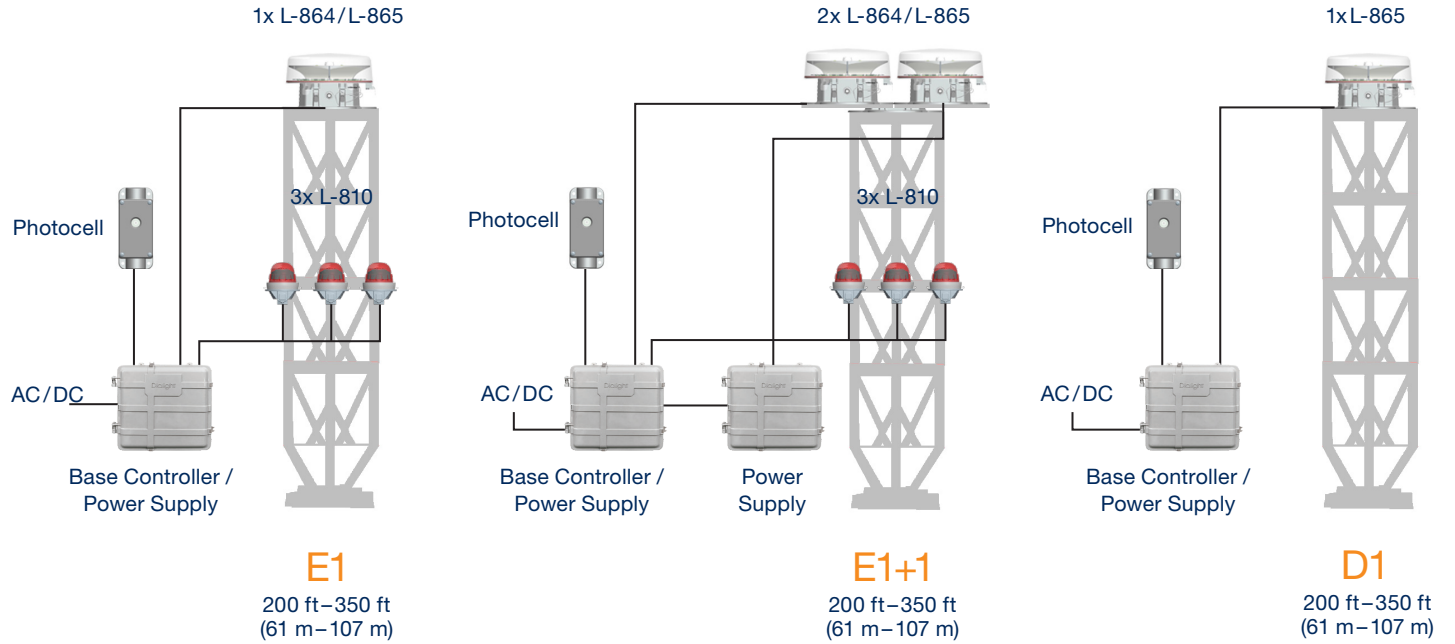

Vigilant® LED Medium Intensity System L-864 / L-865

Medium Intensity (Red / White) System with Infrared (IR)

LED Flash Head (L-864 / L-865)

Part Number	Description
D1CWFH409	Dual Red/White Medium Intensity Flash Head w/ IR

LED Side Markers L-810

Input	Part Number	Description
24-48 VDC	RTOCR28001	L-810 Low Intensity Side Marker w/ IR: DC Input

Controllers

Input	Part Number	Description
120-277 VAC	D1CWCTR409	Dual Red/White Medium Intensity Controller w/ IR: AC Input
48 VDC	D1CWCTR449	Dual Red/White Medium Intensity Controller w/ IR: DC Input
120-277 VAC	D1CWCTR409N	Dual Red/White Medium Intensity Controller w/ IR: AC Input with integrated INEM®
48 VDC	D1CWCTR449N	Dual Red/White Medium Intensity Controller w/ IR: DC Input with integrated INEM®

Power Supply

Input	Part Number	Description
120-277 VAC	D1CWPS9409	Dual Red/White Medium Intensity Power Supply w/ IR: AC Input
48 VDC	D1CWPS9449	Dual Red/White Medium Intensity Power Supply w/ IR: DC Input

Photocell

Part Number	Description
D2566000PEC	Photocell: Single 3/4" NPT Entry

Cable

Tower Height	Description
up to 680ft (207m)	14AWG (2.08mm ²) UV rated 4 conductor cable with metal foil and braid
above 680ft (207m)	12AWG (3.31mm ²) UV rated 4 conductor cable with metal foil and braid

Vigilant® LED Based L-864

Medium Intensity (Red) Flash head with Infrared (IR)

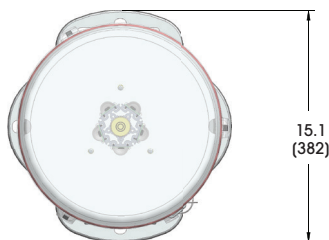
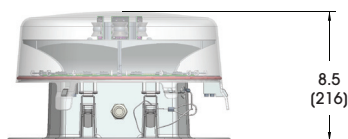
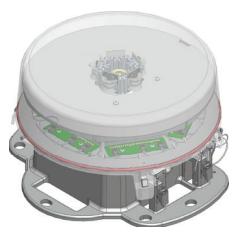

Dimensions in inches [mm]

Certifications & Compliance

- FAA AC 150/5345 - 43J
- FAA EB No. 67D and 98
- IP66
- NEMA 4X

Features & Benefits

- 5 year warranty
- ETL verified to FAA standards
- IR wavelength at 850 nm
- Superior surge and lightning protection
- Patented optics for minimal down light/ground scatter
- IP66/NEMA 4X outdoor rated enclosures
- Remote monitoring options available
- Provisions for padlock on the enclosure
- 6kV of surge protection
- Shock and vibration resistant

Technical Information:

Flash head weight:	18 lbs (8.2 kg)
Flash rate:	20, 30, or 40 (±1%)
Effective intensity:	Red - 2,000 cd IR - 246 mW/sr
Wattage:	15.0 W (50% duty circle) - L864 3.0 W (50% duty circle) - L810 30 flashes per minute with 1.0 sec. on time
Operating temperature:	-40 °F to +131 °F (-40 °C to +55 °C)
Power factor:	> 0.9
All values typical unless otherwise stated (tolerance ±10%)	

US Patents: # 7,281,821 | #7,568,821 | #9,423,086 | #9,423,086 | #9,476,548
#9,581,309 (other patents pending)

Part Number	Description	Notes	Certification
Standard Models			
D664R13001	L-864 Red Flash head with IR AC	120–240 VAC	FAA
D664R54001	L-864 Red Flash head with IR DC	24–48 VDC	FAA
RTOCR27001	L-810 Low Intensity Side Marker - single with IR	120–240 VAC	FAA
RTOCR27002	L-810 Low Intensity Side Marker - double with IR	120–240 VAC	FAA
RTOCR28001	L-810 Low Intensity Side Marker - single with IR	24–48 VDC	FAA
RTOCR28002	L-810 Low Intensity Side Marker - double with IR	24–48 VDC	FAA
Photocell			
D2566000PEC	Photocell: Single 3/4" NPT Entry	—	FAA
Controllers			
D6CB55CCTR	A0/A1 Red Controller (24-48 VDC)	2 outputs	FAA
D6CB77CCTR	A0/A1 Red Controller (AC system)	2 outputs	FAA
D6CE77CCTR	A1-A6 Red Controller (AC system)	12 outputs	FAA
D6CG77CCTR	A1-A6 Red Controller (AC system)	18 outputs	FAA

Intertek verified FAA compliant system numbers D6Cxxx-SYS

Vigilant® LED Based L-810/L-864

Red-Only Medium and Low Intensity Systems with Infrared (IR)

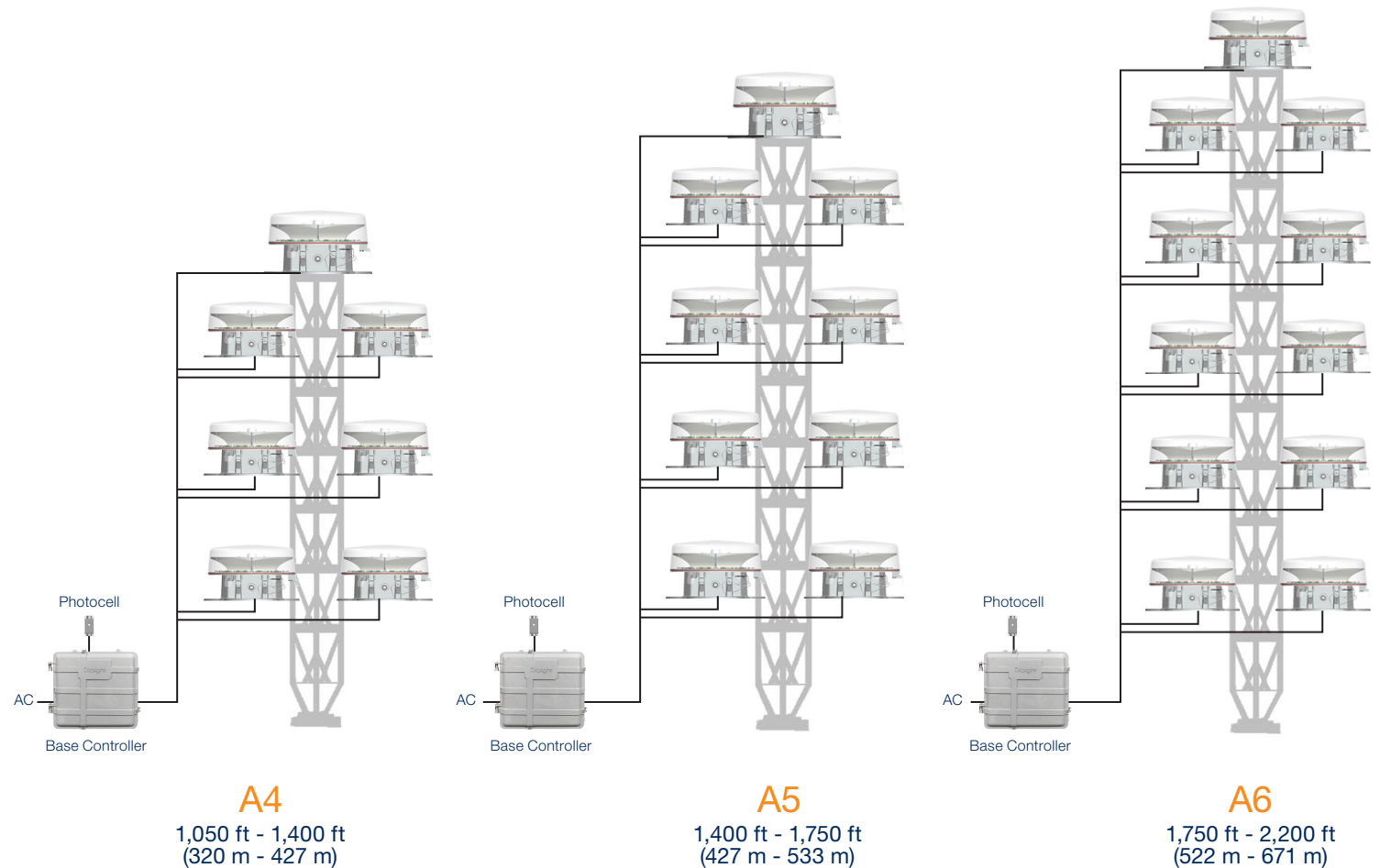
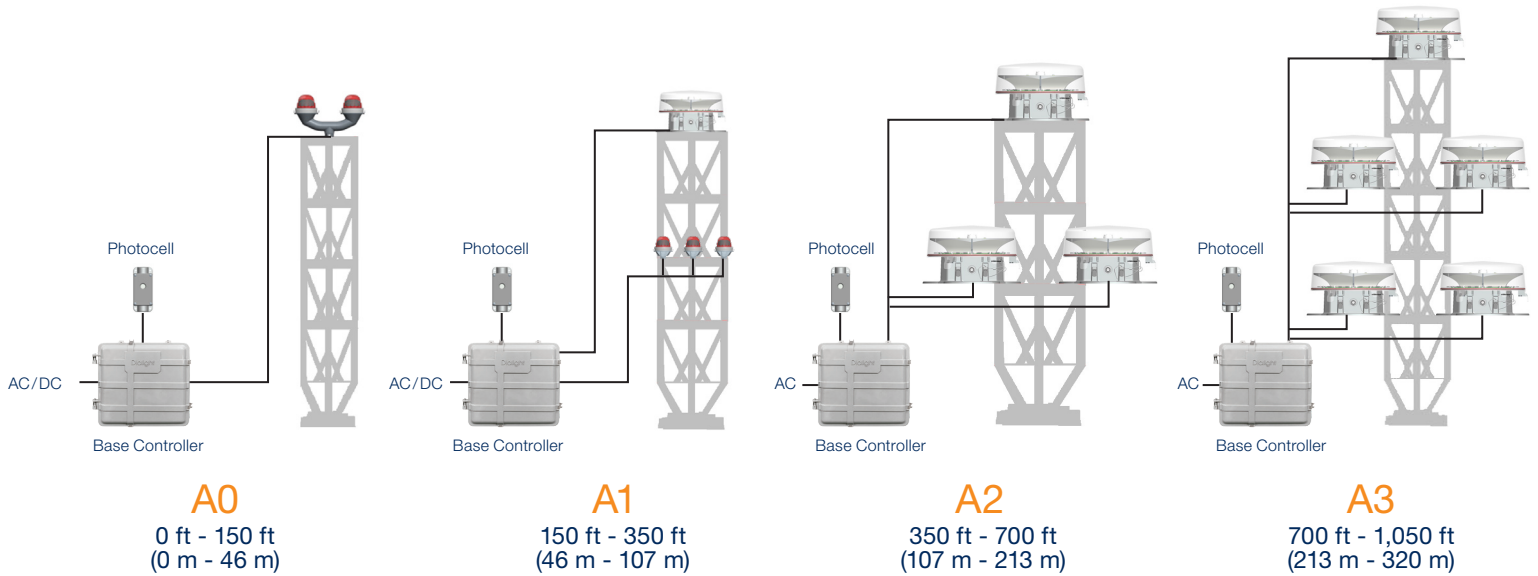

Vigilant® LED Based L-810

Low Intensity (Red) RTO Side Marker with Infrared (IR)

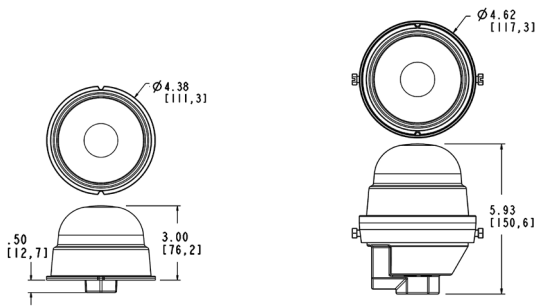
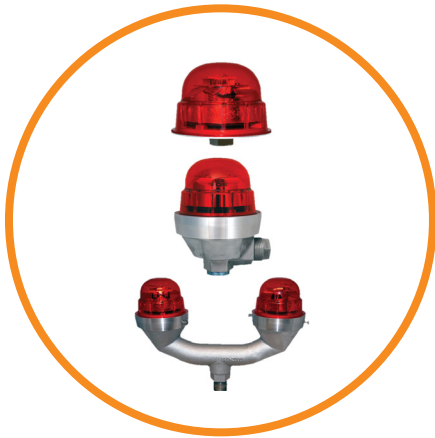

Retro-fit Unit

Single Fixture

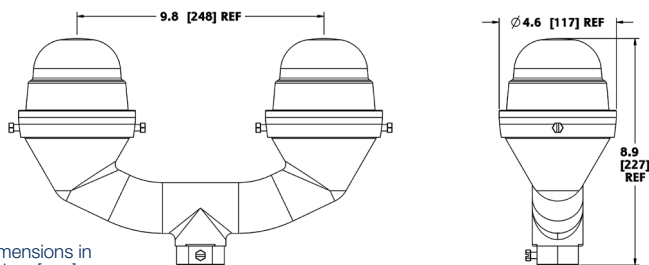

Dimensions in inches [mm]

Dual Fixture

Certifications & Compliance

- FAA AC 150/5345 - 43J
- FAA EB No. 67D and 98
- IP66
- NEMA 4X

Features & Benefits

- 5 Year Warranty
- ETL verified to FAA standards
- IR wavelength at 850 nm
- Superior surge and lightning protection
- Controllers available for all applications
- Compact, low power design
- Ideal for towers, stacks, wind turbines, buildings, etc.
- 360 degree coverage for each flash head
- Shock and vibration resistant
- Lighting kits available for standard towers

Technical Information:

Unit weight:	1.25 lbs (0.56 kg) (Retro unit) 2.00 lbs (0.91 kg) (Single unit) 4.60 lbs (2.09 kg) (Dual unit)
Supply voltage ranges:	Nominal ±10%
Effective intensity:	Red - 32 cd IR - 4 mW/sr
Wattage:	RTOCR27 (AC) = 6w steady burn RTOCR28 (DC) = 5.2w steady burn.
Power factor:	> 0.9 (All AC units)
Operating temperature:	-40 °F to +131 °F (-40 °C to +55 °C)
Input AC frequency:	50/60 Hz
All values typical unless otherwise stated (tolerance ± 10%)	

US Patent #7,604,384 | # 9,423,086 | #9.423,086

Part Number	Description	Voltage	Certification	Wattage
RTOCR27001	Single Fixture Red/Infrared (IR)	120–240 VAC	FAA	6.0
RTOCR28001	Single Fixture Red/Infrared (IR)	24–48 VDC	FAA	5.2
RTOCR27002	Dual Fixture Red/Infrared (IR)	120–240 VAC	FAA	12.0
RTOCR28002	Dual Fixture Red/Infrared (IR)	24–48 VDC	FAA	10.4
RTOCR27004	Single Side Marker Retro-fit Fixture Red/Infrared (IR)	120–240 VAC	FAA	6.0
RTOCR28004	Single Side Marker Retro-fit Fixture Red/Infrared (IR)	24–48 VDC	FAA	5.2

Vigilant® LED Based L-810

Low Intensity (Red) RTO Side Marker

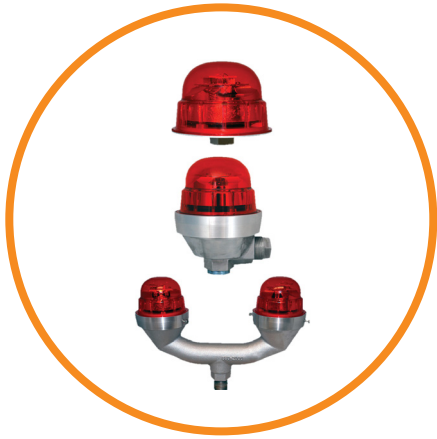

Certifications & Compliance

- FAA AC 150/5345 – 43H
- FAA EB No. 67D and 98
- IP66
- DGAC Mexico

Features & Benefits

- Superior surge and lightning protection
- Controllers available for all applications
- Compact, low power design
- Ideal for towers, stacks, wind turbines, buildings, etc.
- 360 degree coverage for each flash head
- Shock and vibration resistant
- Lighting kits available for standard towers

Technical Information:

Unit weight:	1.25 lbs (0.56 kg) (Retro unit) 2.00 lbs (0.91 kg) (Single unit) 4.60 lbs (2.09 kg) (Dual unit)
Supply voltage ranges:	Nominal ±10%
Power factor:	> 0.9 (All AC units)
Operating temperature:	-40 °F to +131 °F (-40 °C to +55 °C)
Input AC frequency:	50/60 Hz
All values typical unless otherwise stated (tolerance ± 10%)	

US Patent #7,604,384 | # 9,423,086 | #9,423,086

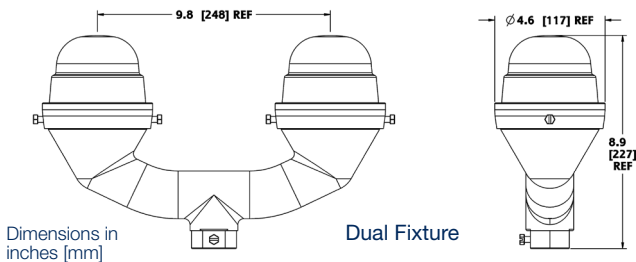
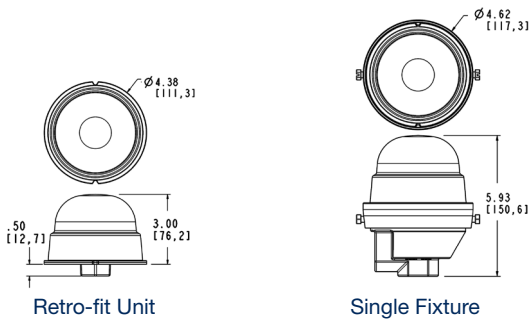

Part Number	Description	Voltage	Certification	Wattage
RTO1R07001	Single Fixture	120–240 VAC	FAA	6.5
RTO1R18001	Single Fixture - Low Power	12–48 VDC	FAA	1.5
RTO1R07002	Dual Fixture	120–240 VAC	FAA	13
RTO1R18002	Dual Fixture - Low Power	12–48 VDC	FAA	3
RTO1R07004	Single Side Marker Retro-fit Fixture	120–240 VAC	FAA	6.5
RTO1R18004	Single Side Marker Retro-fit Fixture - Low Power	12–48 VDC	FAA	1.5
RTO1R07001EU	Single Fixture	120–240 VAC	FAA	6.5
RTO1R07002EU	Dual Fixture	120–240 VAC	FAA	13
RTO1R07004EU	Single Side Marker Retro-fit Fixture	120–240 VAC	—	6.5

Vigilant® LED Based L-810

Low Intensity (Red) Light

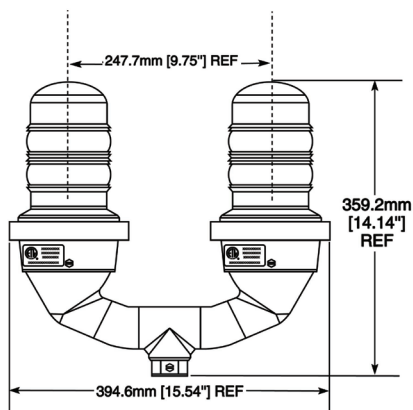
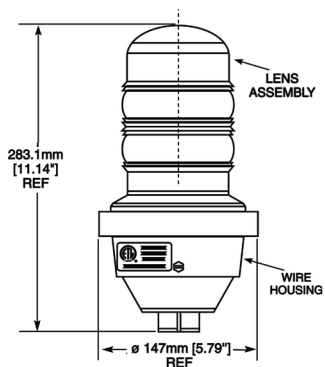

Dimensions in inches [mm]

Compliance

- IP66
- CASA

Features & Benefits

- Superior surge and lightning protection
- Controllers available for all applications
- Ideal for towers, stacks, wind turbines, buildings, etc.
- 360 degree coverage for each flash head
- Shock and vibration resistant
- Lighting kits available for standard towers
- 6kV of surge protection

Technical Information:

Unit weight:	7.14 lbs (3.23 kg) (Single unit) 16.06 lbs (7.28 kg) (Dual unit)
Wattages:	15 W/120mA (120 VAC) ± 10% 16 W/120mA (230 VAC-60 Hz) ± 15% 16 W/(230 VAC - 50 Hz) 24 W/2.0A (12 VDC - Standard) 20 W/920mA (24 VDC) 13 W/275mA (48 VDC)
Voltage amp:	44 VA (120 VAC) ± 10% 67 VA (230 VAC) ± 15%
Operating temperature:	-67 °F to +131 °F (-55 °C to +55 °C)

All values typical unless otherwise stated (tolerance ± 10%)

US Patent #6,425,678 (other patents pending)

Part Number	Description	Voltage
8601R01001	Single Fixture	120 VAC
8601R02001	Single Fixture	230VAC
8601R03001	Single Fixture	12VDC
8601R04001	Single Fixture	48VDC
8601R05001	Single Fixture	24VDC
8601R01002	Dual Fixture	120 VAC
8601R02002	Dual Fixture	230 VAC
8601R04002	Dual Fixture	48VDC
8604R02001EU	Single Fixture	230 VAC
8601R02002EU	Dual Fixture	230 VAC
8606R01001	Single Fixture	120 VAC
8606R01002	Dual Fixture	120 VAC

North American HQ

1501 Route 34 South
Farmingdale, NJ 07727
Tel: 732-919-3119
Fax: 732-751-5778
info@dialight.com

EMEA Technical Centre

Tel: +44 1638 666541 (UK)
Tel: +49 89 12089 5713 (Germany)
Tel: +33 3 23 22 62 58 (France)
sales-europe@dialight.com

Middle East

Level 42
Emirates Towers (Office Tower)
Sheikh Zayed Road
Dubai, United Arab Emirates
Fax: +971 (0) 4319 7686
Tel: +971 (0) 4319 7686

Australia

108 Howe Street
Osborne Park, WA 6017
Tel: +61 (0) 8 9244 7600
Fax: +61 (0) 8 9244 7601
info@dialight.com.au

Southeast Asia

33 Ubi Avenue 3
#07-72 Vertex (Tower A)
Singapore 408868
Tel: +65 6578 7157
Fax: +65 6578 7150
enquiry@dialight.com.sg

Brazil

Alameda Mercurio,
225 – American Park Empresarial NR
Indaiatuba – SP – 13347– 662
Tel: +55 (19) 3113-4300
Fax: +55 (19) 3113-4300
brasil@dialight.com

All values are design or typical values when measured under laboratory conditions. The lighting efficiency statements contained herein are calculated on a lumen per watts basis when comparing fixtures with similar features. All information provided is accurate as of the date of publication, is subject to change without notice and does not form part of any contract with dialight. Dialight does not warrant or represent that its products are fit for any particular purpose and has no responsibility for the inappropriate/unauthorised/non-approved use of any Dialight products by the end user.

Dialight reserves the right to make changes at any time in order to supply the best product possible.

The most current version of this document will always be available at: www.dialight.com