



# Dialight Ultra-Efficient LED High Bay

## Technical Specification Sheet - Americas

## Vigilant® Ultra-Efficient LED High Bay - UL / CSA

### Technical Information

#### Corded Model

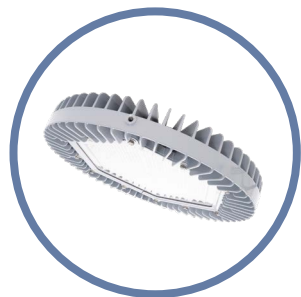

##### Mechanical Information:

###### Fixture weight:

18 lbs (8.16kg)

###### Shipping weight:

24 lbs (10.8kg)

###### Mounting:

3/4" NPT - top  
Various Kits

###### Power Cord:

10' 18 AWG STOOW / SOOW

Patent pending

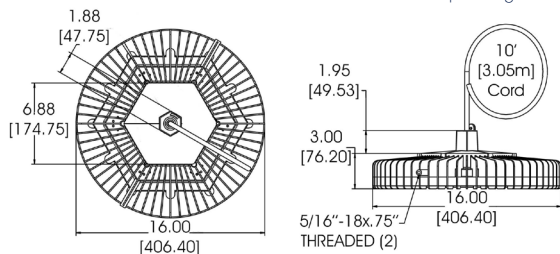

#### Integrated Wiring Box Model



##### Mechanical Information:

###### Fixture weight:

20 lbs (9 kg)

###### Shipping weight:

26 lbs (12 kg)

###### Mounting:

3/4" NPT or Hook

###### Wiring Box Cable Entries:

(2x) 3/4" NPT

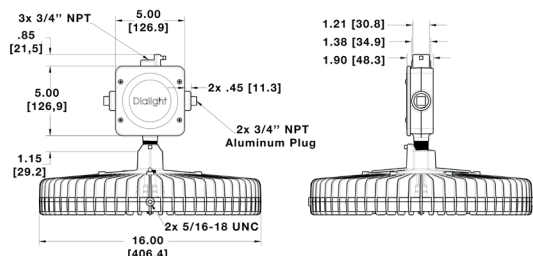

Dimensions in inches (mm)

**WARNING - INSTALLATION & SECONDARY RETENTION.** Use of any Dialight products without proper installation (including secondary retention / netting) and periodic inspections could cause severe injury or death. Dialight recommends that all installations should use secondary retention / netting (appropriate to the installation environment) where applicable. It is the exclusive responsibility of the contractor, installer and/or end-user to: (a) determine the suitability of the product for its intended application; and, (b) ensure that the product is safely installed (with secondary retention / netting where appropriate) and in compliance with all applicable laws and regulations. To the extent permissible under applicable laws, Dialight disclaims all liability for personal injury and/or other damage resulting from any dislodgment or other dislocation of its products.

##### Certifications & Ratings:

10 year warranty  
UL 1598/A  
UL 8750  
IP66/67  
IK10 (polycarbonate) / IK06 (acrylic) / IK05 (glass)

CSA C22.2 No. 250.0  
NEMA 4X  
L70 rated for >150,000 hours

##### Variable Dimming:

Variable Dimming Control: 0-10 VDC

##### Dimming Range:

10 VDC = 100% light output  
0 VDC = <10% light output

##### Electrical Specifications:

Operating Voltage: 100-277 VAC, 120-250 VDC  
347-480 VAC  
250-480 VAC, 250-480 VDC  
(600 VAC / 778 VDC short-term swell capacity)

##### Total system power consumption:

See table

##### Operating Temp:

-40°F to +149°F (-40°C to +65°C)

##### Harmonics:

IEC 61000-3-2 Class C

##### EMC:

FCC Title 47, Subpart B, Section 15, class A device. RF Immunity; 10V/m, 80MHz-1GHz

##### Transient protection:

100-277 VAC models tested to withstand up to 8kV/4kA per IEEE C62.41.  
347-480 VAC models tested to withstand up to 6kV/3kA per IEEE C62.41

##### THD:

<20%

##### Power Factor:

>0.9

##### Fusing:

Internal

##### Power Supply:

ALT: Over 15 yr equivalent at 24/7 service

(accelerated life testing)

##### MTBF:

(mean time between failures)

Over 300 years with annual failure rate less than 0.3% expected

##### Driver:

Fully potted and sealed for superior protection

##### Construction:

###### Housing:

Copper free aluminum

###### Finish:

Superior dual coat finish  
Sealed polyester topcoat  
Chemical-resistant epoxy primer

###### Lens:

See table

###### Vibration:

Up to 5G @ 10-150Hz for 750,000 cycles, per IEC 60068-2-6 for luminaire only

###### Shock:

50G half-sine for 3 cycles, per IEC 60068-2-27 for luminaire only

##### Photometric Information:

###### CRI:

80, 70

###### CCT:

5000K (cool white)  
4000K (neutral white)

All values typical unless otherwise stated (tolerance +/- 10%)

# Vigilant® Ultra-Efficient LED High Bay - UL / CSA

## Battery Backup Model



### Mechanical Information:

#### Fixture weight:

39 lbs (17.7 kg) max

#### Shipping weight:

46 lbs (20.9 kg) max

#### Mounting:

3/4" NPT - top  
Hook

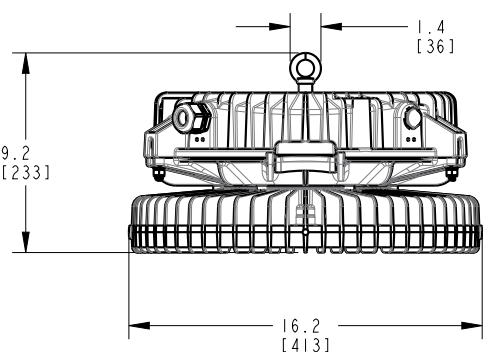
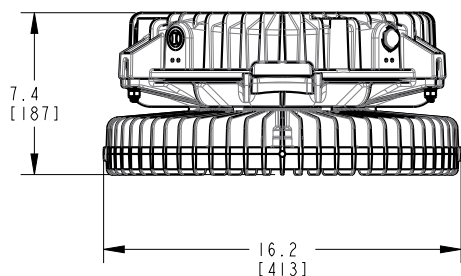

Dimensions in inches (mm)

### Certifications & Ratings:

10 year warranty (excluding battery)  
UL 1598/A IP66/67  
UL 924 NEMA 4X  
UL 8750 L70 rated for >150,000 hours  
CSA C22.2 No. 250.0  
IK10 (polycarbonate) / IK06 (acrylic) / IK05 (glass)

### Variable Dimming:

Variable Dimming Control: 0-10 VDC

Dimming Range: 10 VDC = 100% light output  
0 VDC = <10% light output

### Electrical Specifications:

Operating Voltage: 120-277 VAC

Total system power consumption:

See table

Operating Temp:

-4°F to +131°F (-20°C to +55°C)

Battery Power:

10W or 20W

Harmonics:

IEC 61000-3-2 Class C

EMC:

FCC Title 47, Subpart B, Section 15, class A device. RF Immunity; 10V/m, 80MHz-1GHz

Transient protection:

120-277 VAC models tested to withstand up to 6kV/3kA per IEEE C62.41.

THD:

<20%

Power Factor:

>0.9

Fusing:

Internal

### Power Supply:

ALT:  
(accelerated life testing)

Over 15 yr equivalent at 24/7 service

MTBF:  
(mean time between failures)

Over 300 years with annual failure rate less than 0.3% expected

Driver:

Fully potted and sealed for superior protection

### Construction:

Housing:

Copper free aluminum

Finish:

Superior dual coat finish  
Sealed polyester topcoat  
Chemical-resistant epoxy primer

Lens:

See table

Vibration:

Sinusoidal vibration tested per IEC 60068-2-6

### Photometric Information:

CRI: 80, 70

CCT: 5000K (cool white)  
4000K (neutral white)

All values typical unless otherwise stated (tolerance +/- 10%)

**WARNING - INSTALLATION & SECONDARY RETENTION.** Use of any Dialight products without proper installation (including secondary retention / netting) and periodic inspections could cause severe injury or death. Dialight recommends that all installations should use secondary retention / netting (appropriate to the installation environment) where applicable. It is the exclusive responsibility of the contractor, installer and/or end-user to: (a) determine the suitability of the product for its intended application; and, (b) ensure that the product is safely installed (with secondary retention / netting where appropriate) and in compliance with all applicable laws and regulations. To the extent permissible under applicable laws, Dialight disclaims all liability for personal injury and/or other damage resulting from any dislodgment or other dislocation of its products.

# Vigilant® Ultra-Efficient LED High Bay - UL / CSA

## Ordering Information



Project Information			Specifications		
Part Number:					
Project:					
Fixture Type:		Date:			

## Ordering Information

Product Code	Junction Box	Cert.	Lens Material	Beam Dist.	CCT & CRI	Oper. Voltage	Lumen Type	Controls	Mounting Options	Power Cable	Elect. Access.	Coatings	Battery
V		U									N	G	
<b>Product Code</b>				<b>CCT &amp; CRI</b>				<b>Controls</b>		<b>Electrical Accessories*</b>			
V Vigilant® Ultra-Efficient				B Cool White 5000K - 70 CRI				D Continuous Dimming		N No Plug			
				C Cool White 5000K - 80 CRI				J IntelliLED Wireless		*Cord & plug options available upon request			
<b>Junction Box</b>				L Neutral White 4000K - 70 CRI				N No Option					
C Wiring Box				N Neutral White 4000K - 80 CRI				Q Microwave Occupancy Sensor 40"²					
E No Junction Box													
<b>Certification</b>				<b>Operating Voltage</b>				<b>Mounting Options</b>		<b>Coatings</b>			
U UL 1598/A, CSA				2 100-277 VAC / 120-250 VDC				H Hook		G Gray (RAL 7040)			
				5 347-480 VAC				N 3/4" NPT					
<b>Lens Material</b>				Y 250-480 VAC / 250-480 VDC³				P Secondary Retention Bracket					
4 Polycarbonate - Clear										<b>Battery</b>			
7 Tempered Glass - Clear				<b>Lumen Type¹</b>						G Battery Backup - 10W⁴			
L Polycarbonate Dome - Diffused				A 12,100 Lumens						H Battery Backup - 20W⁴			
				B 15,000 Lumens						N No Option			
<b>Beam Distribution</b>				C 19,100 Lumens				<b>Power Cable</b>					
E Aisle				E 26,300 Lumens				N No Cord (Wiring Box only)					
M Medium				F 30,900 Lumens				W 10' [3 meter] Power Cable					
N Narrow				H 35,700 Lumens									
R High Efficacy Round				J 41,300 Lumens³									

Notes
1) Lumen type based on using a glass lens, round optic, 70 CRI. See page 14 for output of other options.
2) Occupancy Sensor models are dry locations only and are IP6X rated with a -20°C to +65°C ambient temperature range.
3) When ordering Operating Voltage = (Y) and Lumen Type = (J), maximum ambient temperature is +55°C (131°F).
4) Battery Backup only available with Junction Box = (E) and Operating Voltage = (2).

**DISCLAIMER.** All product information provided is, to the best of Dialight's knowledge, accurate as of the date of publication. When ordering, refer to [www.dialight.com](http://www.dialight.com) for current versions of: (a) relevant product documentation (including the relevant product data sheets); (b) Dialight terms and conditions of sale; and, (c) the relevant product warranty. To the extent that any contract is deemed formed between Dialight and the purchaser of Dialight products and/or an end-user, versions of documents available at [www.dialight.com](http://www.dialight.com) as at the date of sale shall be the versions incorporated therein. In the event of any discrepancy between this document or information provided at [www.dialight.com](http://www.dialight.com), the latter shall prevail.

# Vigilant® Ultra-Efficient LED High Bay - UL / CSA

## Ordering Information



Corded Model - 3/4" Conduit - 100-277 VAC / 120-250 VDC								
Part Number	Lumens	Wattage	lm/W	CCT, CRI	Lens	Beam Distribution	Hardware Options	Wiring
VEU-7NC2-JNNW-NGN	38,200	230	166	CW, 80CRI	Glass	Narrow	Pendant 3/4" NPT	10' Power Cable
VEU-7MC2-JNNW-NGN	37,400	230	163	CW, 80CRI	Glass	Medium	Pendant 3/4" NPT	10' Power Cable
VEU-7MC2-HNNW-NGN	32,300	195	166	CW, 80CRI	Glass	Medium	Pendant 3/4" NPT	10' Power Cable
VEU-7MC2-FNNW-NGN	28,000	165	170	CW, 80CRI	Glass	Medium	Pendant 3/4" NPT	10' Power Cable
VEU-7MC2-ENNW-NGN	23,800	140	170	CW, 80CRI	Glass	Medium	Pendant 3/4" NPT	10' Power Cable
Corded Model - 3/4" Conduit - 347-480 VAC								
VEU-7NC5-JNNW-NGN	38,200	230	166	CW, 80CRI	Glass	Narrow	Pendant 3/4" NPT	10' Power Cable
VEU-7MC5-JNNW-NGN	37,400	230	163	CW, 80CRI	Glass	Medium	Pendant 3/4" NPT	10' Power Cable
VEU-7MC5-HNNW-NGN	32,300	195	166	CW, 80CRI	Glass	Medium	Pendant 3/4" NPT	10' Power Cable
VEU-7MC5-FNNW-NGN	28,000	165	170	CW, 80CRI	Glass	Medium	Pendant 3/4" NPT	10' Power Cable
VEU-7MC5-ENNW-NGN	23,800	140	170	CW, 80CRI	Glass	Medium	Pendant 3/4" NPT	10' Power Cable
Integrated Wiring Box Model - Hook - 100-277 VAC / 120-250 VDC								
VCU-7NC2-JDHN-NGN	38,200	230	166	CW, 80CRI	Glass	Narrow	Hook	Wiring Box
VCU-7MC2-JDHN-NGN	37,400	230	163	CW, 80CRI	Glass	Medium	Hook	Wiring Box
VCU-7MC2-HDHN-NGN	32,300	195	166	CW, 80CRI	Glass	Medium	Hook	Wiring Box
VCU-7MC2-FDHN-NGN	28,000	165	170	CW, 80CRI	Glass	Medium	Hook	Wiring Box
VCU-7MC2-EDHN-NGN	23,800	140	170	CW, 80CRI	Glass	Medium	Hook	Wiring Box
Integrated Wiring Box Model - Hook - 347-480 VAC								
VCU-7NC5-JDHN-NGN	38,200	230	166	CW, 80CRI	Glass	Narrow	Hook	Wiring Box
VCU-7MC5-JDHN-NGN	37,400	230	163	CW, 80CRI	Glass	Medium	Hook	Wiring Box
VCU-7MC5-HDHN-NGN	32,300	195	166	CW, 80CRI	Glass	Medium	Hook	Wiring Box
VCU-7MC5-FDHN-NGN	28,000	165	170	CW, 80CRI	Glass	Medium	Hook	Wiring Box
VCU-7MC5-EDHN-NGN	23,800	140	170	CW, 80CRI	Glass	Medium	Hook	Wiring Box
20W Battery Backup - 120-277 VAC								
VEU-7NC2-JDNN-NGH	38,200	236	162	CW, 80CRI	Glass	Narrow	Pendant 3/4" NPT	Wiring Box
VEU-7MC2-JDNN-NGH	37,400	236	158	CW, 80CRI	Glass	Medium	Pendant 3/4" NPT	Wiring Box
VEU-7MC2-HDNN-NGH	32,300	201	161	CW, 80CRI	Glass	Medium	Pendant 3/4" NPT	Wiring Box
VEU-7MC2-FDNN-NGH	28,000	171	164	CW, 80CRI	Glass	Medium	Pendant 3/4" NPT	Wiring Box
VEU-7MC2-EDNN-NGH	23,800	146	163	CW, 80CRI	Glass	Medium	Pendant 3/4" NPT	Wiring Box

All values typical unless otherwise stated (tolerance +/- 10%)

**DISCLAIMER.** All product information provided is, to the best of Dialight's knowledge, accurate as of the date of publication. When ordering, refer to [www.dialight.com](http://www.dialight.com) for current versions of: (a) relevant product documentation (including the relevant product data sheets); (b) Dialight terms and conditions of sale; and, (c) the relevant product warranty. To the extent that any contract is deemed formed between Dialight and the purchaser of Dialight products and/or an end-user, versions of documents available at [www.dialight.com](http://www.dialight.com) as at the date of sale shall be the versions incorporated therein. In the event of any discrepancy between this document or information provided at [www.dialight.com](http://www.dialight.com), the latter shall prevail.

# Vigilant® Ultra-Efficient LED Low Bay - UL / CSA

## Technical Information

### Corded Model



#### Mechanical Information:

##### Fixture weight:

18 lbs (8.16kg)

##### Shipping weight:

24 lbs (10.8kg)

##### Mounting:

3/4" NPT - top

Various Kits

##### Power Cord:

10' 18 AWG ST00W/S00W

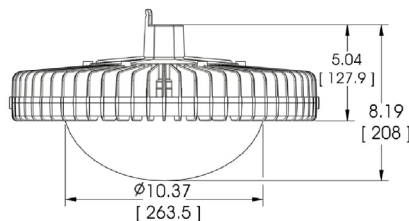
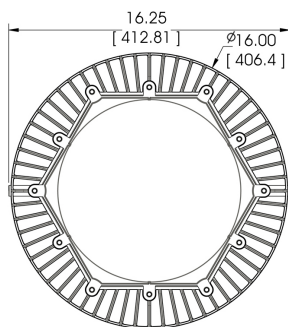

### Integrated Wiring Box Model



#### Mechanical Information:

##### Fixture weight:

20 lbs (9 kg)

##### Shipping weight:

26 lbs (12 kg)

##### Mounting:

3/4" NPT or Hook

Various Kits

##### Wiring Box Cable Entries:

(2x) 3/4" NPT

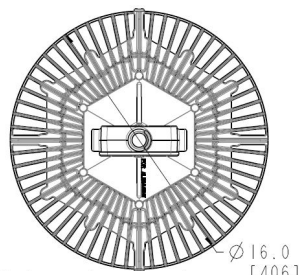
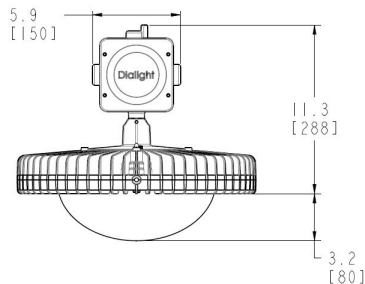

Dimensions in inches (mm)

#### Certifications & Ratings:

10 year warranty

UL 1598/A

UL 8750

IP66/67

CSA C22.2 No. 250.0

NEMA 4X

L70 rated for >150,000 hours

IK10 (polycarbonate dome)

#### Variable Dimming:

Variable Dimming Control: 0-10 VDC

#### Dimming Range:

10 VDC = 100% light output

0 VDC = <10% light output

#### Occupancy Sensor:

Mounting Height:

Up to 40ft

Ingress Protection:

IP6X

#### Electrical Specifications:

##### Operating Voltage:

100-277 VAC (120-250 VDC)

347-480 VAC

##### Total system power consumption:

See table

##### Operating Temp:

-40°F to +149°F (-40°C to +65°C)

##### Harmonics:

IEC 61000-3-2 Class C

##### EMC:

FCC Title 47, Subpart B, Section 15, class A device, RF Immunity; 10V/m, 80MHz-1GHz

##### Transient protection:

100-277 VAC models tested to withstand up to 8kV/4kA per IEEE C62.41  
347-480VAC models tested to withstand up to 6kV/3kA per IEEE C62.41

##### THD:

6k-18k lm models: <20%

##### Power Factor:

>0.9

##### Fusing:

Internal

#### Power Supply:

ALT: (accelerated life testing)

Over 15 yr equivalent at 24/7 service

MTBF: (mean time between failures)

Over 300 years with annual failure rate less than 0.3% expected

##### Driver:

Fully potted and sealed for superior protection

#### Construction:

##### Housing:

Copper free aluminum

##### Finish:

Superior dual coat finish  
Sealed polyester topcoat  
Chemical-resistant epoxy primer

##### Lens:

See table

##### Vibration:

Up to 5G @ 10-150Hz for 750,000 cycles, per IEC 60068-2-6 for luminaire only

##### Shock:

50G half-sine for 3 cycles, per IEC 60068-2-27 for luminaire only

#### Photometric Information:

##### CRI:

80

##### CCT:

5000K (cool white)  
4000K (neutral white)

All values typical unless otherwise stated (tolerance +/- 10%)

**WARNING - INSTALLATION & SECONDARY RETENTION.** Use of any Dialight products without proper installation (including secondary retention / netting) and periodic inspections could cause severe injury or death. Dialight recommends that all installations should use secondary retention / netting (appropriate to the installation environment) where applicable. It is the exclusive responsibility of the contractor, installer and/or end-user to: (a) determine the suitability of the product for its intended application; and, (b) ensure that the product is safely installed (with secondary retention / netting where appropriate) and in compliance with all applicable laws and regulations. To the extent permissible under applicable laws, Dialight disclaims all liability for personal injury and/or other damage resulting from any dislodgment or other dislocation of its products.

## Vigilant® Ultra-Efficient LED Low Bay - UL / CSA Battery Backup Model



### Mechanical Information:

#### Fixture weight:

39 lbs (17.7 kg) max

#### Shipping weight:

46 lbs (20.9 kg) max

#### Mounting:

3/4" NPT - top  
Hook

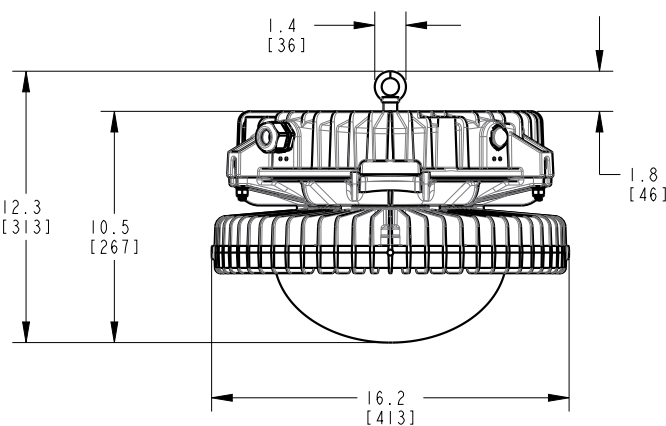
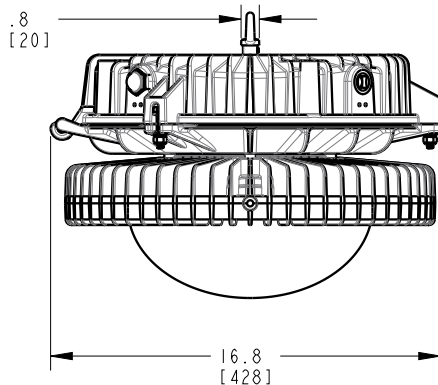

Dimensions in inches (mm)

### Certifications & Ratings:

10 year warranty (excluding battery)

UL 1598/A

IP66/67

UL 924

NEMA 4X

UL 8750

L70 rated for >150,000 hours

CSA C22.2 No. 250.0

IK10 (polycarbonate dome)

### Variable Dimming:

Variable Dimming Control: 0-10 VDC

### Dimming Range:

10 VDC = 100% light output

0 VDC = <10% light output

### Electrical Specifications:

Operating Voltage: 120-277 VAC

Total system power  
consumption:

See table

### Operating Temp:

-4°F to +131°F (-20°C to +55°C)

### Battery Power:

10W or 20W

### Harmonics:

IEC 61000-3-2 Class C

### EMC:

FCC Title 47, Subpart B, Section  
15, class A device. RF Immunity;  
10V/m, 80MHz-1GHz

### Transient protection:

120-277 VAC models tested to  
withstand up to 6kV/3kA per IEEE  
C62.41.

### THD:

<20%

### Power Factor:

>0.9

### Fusing:

Internal

### Power Supply:

ALT:  
(accelerated life testing)

Over 15 yr equivalent at 24/7 service

MTBF:  
(mean time between failures)

Over 300 years with annual failure rate  
less than 0.3% expected

### Driver:

Fully potted and sealed for superior  
protection

### Construction:

#### Housing:

Copper free aluminum

#### Finish:

Superior dual coat finish  
Sealed polyester topcoat  
Chemical-resistant epoxy primer

#### Lens:

See table

#### Vibration:

Sinusoidal vibration tested per  
IEC 60068-2-6

### Photometric Information:

#### CRI:

80, 70

#### CCT:

5000K (cool white)  
4000K (neutral white)

All values typical unless otherwise stated (tolerance +/- 10%)

**WARNING - INSTALLATION & SECONDARY RETENTION.** Use of any Dialight products without proper installation (including secondary retention / netting) and periodic inspections could cause severe injury or death. Dialight recommends that all installations should use secondary retention / netting (appropriate to the installation environment) where applicable. It is the exclusive responsibility of the contractor, installer and/or end-user to: (a) determine the suitability of the product for its intended application; and, (b) ensure that the product is safely installed (with secondary retention / netting where appropriate) and in compliance with all applicable laws and regulations. To the extent permissible under applicable laws, Dialight disclaims all liability for personal injury and/or other damage resulting from any dislodgment or other dislocation of its products.

# Vigilant® Ultra-Efficient LED Low Bay - UL / CSA

## Ordering Information



Project Information			Specifications		
Part Number:					
Project:					
Fixture Type:		Date:			

## Ordering Information

V		U		U							N	G	
Product Code	Junction Box	Cert.	Lens Material	Beam Dist.	CCT & CRI	Oper. Voltage	Lumen Type	Controls	Mounting Options	Power Cable	Elect. Access.	Coatings	Battery
<b>Product Code</b>	<b>Beam Distribution</b>			<b>Lumen Type<sup>1</sup></b>			<b>Power Cable</b>						
V Vigilant® Ultra-Efficient	U Ultra Wide			6 6,100 Lumens			N No Cord (Wiring Box only)						
				9 9,000 Lumens			W 10' [3 meter] Power Cable						
				B 13,400 Lumens									
				C 16,600 Lumens									
<b>Junction Box</b>	<b>CCT &amp; CRI</b>			<b>Controls</b>			<b>Electrical Accessories*</b>						
C Wiring Box	C Cool White 5000K - 80 CRI			D Continuous Dimming			N No Plug						
E No Junction Box	N Neutral White 4000K - 80 CRI			J IntelliLED Wireless Controls			*Cord & plug options available upon request						
				N No Option									
				Q Microwave Occ Sensor 40" <sup>3</sup>									
<b>Certification</b>	<b>Operating Voltage</b>			<b>Mounting Options</b>			<b>Coatings</b>						
U UL 1598/A	2 100-277 VAC / 120-250 VDC			H Hook			G Gray (RAL 7040)						
	5 347-480 VAC			N Pendant 3/4" NPT									
				P Pendant 3/4" NPT with Safety Retention Tabs									
				R Safety Retention Tabs with Hook									
<b>Lens Material</b>							<b>Battery</b>						
2 Acrylic - Clear (dry location only) <sup>2</sup>							G Battery Backup - 10W <sup>4</sup>						
3 Acrylic - Diffused (dry location only) <sup>2</sup>							H Battery Backup - 20W <sup>4</sup>						
4 Polycarbonate - Clear							N No Option						
5 Polycarbonate - Diffused													
L Polycarbonate Dome - Diffused													

### Notes

- 1) Lumen type based on using a polycarbonate dome lens. See page 14 for output of other options.
- 2) Acrylic lens are dry location only.
- 3) Occupancy Sensor models are dry locations only and are IP6X rated with a -20°C to +65°C ambient temperature range.
- 4) Battery Backup only available with Junction Box = (E) and Operating Voltage = (2).

**DISCLAIMER.** All product information provided is, to the best of Dialight's knowledge, accurate as of the date of publication. When ordering, refer to [www.dialight.com](http://www.dialight.com) for current versions of: (a) relevant product documentation (including the relevant product data sheets); (b) Dialight terms and conditions of sale; and, (c) the relevant product warranty. To the extent that any contract is deemed formed between Dialight and the purchaser of Dialight products and/or an end-user, versions of documents available at [www.dialight.com](http://www.dialight.com) as at the date of sale shall be the versions incorporated therein. In the event of any discrepancy between this document or information provided at [www.dialight.com](http://www.dialight.com), the latter shall prevail.

# Vigilant® Ultra-Efficient LED Low Bay - UL / CSA

## Ordering Information



Corded Model - 3/4" Conduit - 100-277 VAC / 120-250 VDC								
Part Number	Lumens	Wattage	lm/W	CCT, CRI	Lens	Beam Distribution	Hardware Options	Wiring
VEU-LUC2-CNNW-NGN	16,700	115	145	CW, 80CRI	Polycarbonate Dome - Diffused	Ultra Wide	Pendant 3/4" NPT	10' Power Cable
VEU-LUC2-BNNW-NGN	13,400	90	149	CW, 80CRI	Polycarbonate Dome - Diffused	Ultra Wide	Pendant 3/4" NPT	10' Power Cable
VEU-LUC2-9NNW-NGN	9,000	60	150	CW, 80CRI	Polycarbonate Dome - Diffused	Ultra Wide	Pendant 3/4" NPT	10' Power Cable
VEU-LUC2-6NNW-NGN	6,100	43	142	CW, 80CRI	Polycarbonate Dome - Diffused	Ultra Wide	Pendant 3/4" NPT	10' Power Cable
Corded Model - 3/4" Conduit - 347-480 VAC								
VEU-LUC5-CNNW-NGN	16,700	115	145	CW, 80CRI	Polycarbonate Dome - Diffused	Ultra Wide	Pendant 3/4" NPT	10' Power Cable
VEU-LUC5-BNNW-NGN	13,400	90	149	CW, 80CRI	Polycarbonate Dome - Diffused	Ultra Wide	Pendant 3/4" NPT	10' Power Cable
VEU-LUC5-9NNW-NGN	9,000	60	150	CW, 80CRI	Polycarbonate Dome - Diffused	Ultra Wide	Pendant 3/4" NPT	10' Power Cable
Integrated Wiring Box Model - Hook - 100-277 VAC / 120-250 VDC								
VCU-LUC2-CDHN-NGN	16,700	115	145	CW, 80CRI	Polycarbonate Dome - Diffused	Ultra Wide	Hook	Wiring Box
VCU-LUC2-BDHN-NGN	13,400	90	149	CW, 80CRI	Polycarbonate Dome - Diffused	Ultra Wide	Hook	Wiring Box
VCU-LUC2-9DHN-NGN	9,000	60	150	CW, 80CRI	Polycarbonate Dome - Diffused	Ultra Wide	Hook	Wiring Box
VCU-LUC2-6DHN-NGN	6,100	43	142	CW, 80CRI	Polycarbonate Dome - Diffused	Ultra Wide	Hook	Wiring Box
Integrated Wiring Box Model - Hook - 347-480 VAC								
VCU-LUC5-CDHN-NGN	16,700	115	145	CW, 80CRI	Polycarbonate Dome - Diffused	Ultra Wide	Hook	Wiring Box
VCU-LUC5-BDHN-NGN	13,400	90	149	CW, 80CRI	Polycarbonate Dome - Diffused	Ultra Wide	Hook	Wiring Box
VCU-LUC5-9DHN-NGN	9,000	60	150	CW, 80CRI	Polycarbonate Dome - Diffused	Ultra Wide	Hook	Wiring Box
10W Battery Backup - 120-277 VAC								
VEU-LUC2-CDNN-NGG	16,700	121	138	CW, 80CRI	Polycarbonate Dome - Diffused	Ultra Wide	Pendant 3/4" NPT	Wiring Box
VEU-LUC2-BDNN-NGG	13,400	96	140	CW, 80CRI	Polycarbonate Dome - Diffused	Ultra Wide	Pendant 3/4" NPT	Wiring Box
VEU-LUC2-9DNN-NGG	9,000	66	136	CW, 80CRI	Polycarbonate Dome - Diffused	Ultra Wide	Pendant 3/4" NPT	Wiring Box

All values typical unless otherwise stated (tolerance +/- 10%)

**DISCLAIMER.** All product information provided is, to the best of Dialight's knowledge, accurate as of the date of publication. When ordering, refer to [www.dialight.com](http://www.dialight.com) for current versions of: (a) relevant product documentation (including the relevant product data sheets); (b) Dialight terms and conditions of sale; and, (c) the relevant product warranty. To the extent that any contract is deemed formed between Dialight and the purchaser of Dialight products and/or an end-user, versions of documents available at [www.dialight.com](http://www.dialight.com) as at the date of sale shall be the versions incorporated therein. In the event of any discrepancy between this document or information provided at [www.dialight.com](http://www.dialight.com), the latter shall prevail.



# SafeSite® Ultra-Efficient LED High Bay - UL / CSA

## Battery Backup Model



### Mechanical Information:

**Fixture weight:**  
39 lbs (17.7 kg) max

**Shipping weight:**  
46 lbs (20.9 kg) max

**Mounting:**  
3/4" NPT - top  
Hook

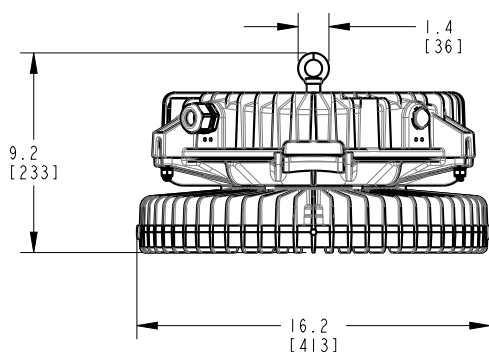
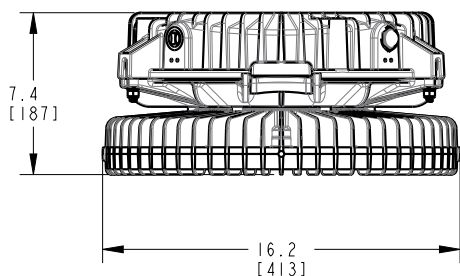

Dimensions in inches (mm)

### Temperature Ratings:

**Ambient Temp Range**  
**T4A Temp Code:** -4°F to +131°F (-20°C to +55°C)

### Certifications & Ratings:

10 year warranty (excluding battery)  
UL 844 (wet locations) NEMA 4X  
UL 924 IP66/67  
UL 8750 L70 rated for >150,000 hours  
IK10 (polycarbonate) / IK06 (acrylic) / IK05 (glass)  
CSA 22.2 No. 137  
Class I, Div. 2 Groups A, B, C, D  
Class I, Zone 2, Group IIC  
Class II, Div. 1 Groups E, F, G  
Class II, Div. 2 Groups F, G  
Class III, Div. 1 & 2

### Variable Dimming:

**Variable Dimming Control:** 0-10 VDC

**Dimming Range:** 10 VDC = 100% light output  
0 VDC = <10% light output

### Electrical Specifications:

**Operating voltage:** 120-277 VAC

**Power consumption:** See table

**Operating temp:** -4°F to +131°F (-20°C to +55°C)

**Harmonics:** IEC 61000-3-2 Class C

**EMC:** FCC Title 47, Subpart B, Section 15, Class A device. RF Immunity; 10V/m, 80MHz-1GHz

**Transient protection:** 120-277 VAC models tested to withstand up to 6kV/3kA per IEEE C62.41

**THD:** < 20%

**Power factor:** >0.9

**Fusing:** Internal

### Power Supply:

**ALT:** Over 15 yr equivalent at 24/7 service  
(accelerated life testing)

**MTBF:** Over 300 years with annual failure rate  
(mean time between failures) less than 0.3% expected

**Driver:** Fully potted and sealed for superior protection

### Construction:

**Housing:** Copper free aluminum

**Finish:** Superior dual coat finish  
Sealed polyester topcoat  
Chemical-resistant epoxy primer

**Lens:** See table

**Vibration:** Sinusoidal vibration tested per IEC 60068-2-6

### Photometric Information:

**CRI:** 80, 70

**CCT:** 5000K (cool white)  
4000K (neutral white)

All values typical unless otherwise stated (tolerance +/- 10%)

**WARNING - INSTALLATION & SECONDARY RETENTION.** Use of any Dialight products without proper installation (including secondary retention / netting) and periodic inspections could cause severe injury or death. Dialight recommends that all installations should use secondary retention / netting (appropriate to the installation environment) where applicable. It is the exclusive responsibility of the contractor, installer and/or end-user to: (a) determine the suitability of the product for its intended application; and, (b) ensure that the product is safely installed (with secondary retention / netting where appropriate) and in compliance with all applicable laws and regulations. To the extent permissible under applicable laws, Dialight disclaims all liability for personal injury and/or other damage resulting from any dislodgment or other dislocation of its products.

# SafeSite® Ultra-Efficient LED High Bay - UL / CSA

## Ordering Information



Project Information			Specifications		
Part Number:					
Project:					
Fixture Type:		Date:			

## Ordering Information

<b>V</b>	-		-	<b>D</b>	-		-		-		-		-		-	<b>N</b>	-	<b>G</b>	-							
Product Code		Junction Box		Cert.		Lens Material		Beam Dist.		CCT & CRI		Oper. Voltage		Lumen Type		Controls		Mounting Options		Power Cable		Elect. Access.		Coatings		Battery

### Product Code

V SafeSite® High Ultra-Efficient

### Junction Box

C Wiring Box²

E No Junction Box

### Certification

D UL 844 CID2, CII, CIII  
Class I, Zone 2

### Lens Material

4 Polycarbonate - Clear

7 Glass - Clear

L Polycarbonate Dome - Diffused

### Beam Distribution

E Aisle

M Medium

N Narrow

R High Efficacy Round

### CCT & CRI

B Cool White 5000K - 70 CRI

C Cool White 5000K - 80 CRI

L Neutral White 4000K - 70 CRI

N Neutral White 4000K - 80 CRI

### Operating Voltage

2 100-277 VAC / 120-250 VDC

5 347-480 VAC

### Lumen Type¹

A 12,100 Lumens

B 15,000 Lumens

C 19,100 Lumens

E 26,300 Lumens

F 30,900 Lumens

H 35,700 Lumens

J 41,300 Lumens

### Controls

D Continuous Dimming

J IntelliLED Wireless

N No Option

Q Microwave Occupancy Sensor 40'³

### Mounting Options

H Hook (Wiring Box only)

N 3/4" NPT

P Secondary Retention Bracket

### Power Cable

N No Cord (Wiring Box only)

W 10' [3 meter] Power Cable

### Electrical Accessories

N No Plug

\*Cord & plug options available upon request

### Coatings

G Gray (RAL 7040)

### Battery

G Battery Backup - 10W⁴

H Battery Backup - 20W⁴

N No Option

### Notes

1) Lumen type based on using a glass lens, round optic, 70CRI. See page 14 for output of other options.

2) Wiring Box is not CIID1 rated.

3) Occupancy Sensor models are dry locations only and are IP6X rated with a -20°C to +65°C ambient temperature range. Occupancy Sensor models are not CIID1 rated.

4) Battery Backup only available with Junction Box = (E) and Operating Voltage = (2).

**DISCLAIMER.** All product information provided is, to the best of Dialight's knowledge, accurate as of the date of publication. When ordering, refer to [www.dialight.com](http://www.dialight.com) for current versions of: (a) relevant product documentation (including the relevant product data sheets); (b) Dialight terms and conditions of sale; and, (c) the relevant product warranty. To the extent that any contract is deemed formed between Dialight and the purchaser of Dialight products and/or an end-user, versions of documents available at [www.dialight.com](http://www.dialight.com) as at the date of sale shall be the versions incorporated therein. In the event of any discrepancy between this document or information provided at [www.dialight.com](http://www.dialight.com), the latter shall prevail.

# SafeSite® Ultra-Efficient LED High Bay - UL / CSA

## Ordering Information



Corded Model - 3/4" Conduit - 100-277 VAC / 120-250 VDC								
Part Number	Lumens	Wattage	lm/W	CCT, CRI	Lens	Beam Distribution	Hardware Options	Wiring
VED-7NC2-JNNW-NGN	38,200	230	166	CW, 80CRI	Glass	Narrow	Pendant 3/4" NPT	10' Power Cable
VED-7MC2-JNNW-NGN	37,400	230	163	CW, 80CRI	Glass	Medium	Pendant 3/4" NPT	10' Power Cable
VED-7MC2-HNNW-NGN	32,300	195	166	CW, 80CRI	Glass	Medium	Pendant 3/4" NPT	10' Power Cable
VED-7MC2-FNNW-NGN	28,000	165	170	CW, 80CRI	Glass	Medium	Pendant 3/4" NPT	10' Power Cable
VED-7MC2-ENNW-NGN	23,800	140	170	CW, 80CRI	Glass	Medium	Pendant 3/4" NPT	10' Power Cable
Corded Model - 3/4" Conduit - 347-480 VAC								
VED-7NC5-JNNW-NGN	38,200	230	166	CW, 80CRI	Glass	Narrow	Pendant 3/4" NPT	10' Power Cable
VED-7MC5-JNNW-NGN	37,400	230	163	CW, 80CRI	Glass	Medium	Pendant 3/4" NPT	10' Power Cable
VED-7MC5-HNNW-NGN	32,300	195	166	CW, 80CRI	Glass	Medium	Pendant 3/4" NPT	10' Power Cable
VED-7MC5-FNNW-NGN	28,000	165	170	CW, 80CRI	Glass	Medium	Pendant 3/4" NPT	10' Power Cable
VED-7MC5-ENNW-NGN	23,800	140	170	CW, 80CRI	Glass	Medium	Pendant 3/4" NPT	10' Power Cable
Integrated Wiring Box Model - Hook - 100-277 VAC / 120-250 VDC								
VCD-7NC2-JDHN-NGN	38,200	230	166	CW, 80CRI	Glass	Narrow	Hook	Wiring Box
VCD-7MC2-JDHN-NGN	37,400	230	163	CW, 80CRI	Glass	Medium	Hook	Wiring Box
VCD-7MC2-HDHN-NGN	32,300	195	166	CW, 80CRI	Glass	Medium	Hook	Wiring Box
VCD-7MC2-FDHN-NGN	28,000	165	170	CW, 80CRI	Glass	Medium	Hook	Wiring Box
VCD-7MC2-EDHN-NGN	23,800	140	170	CW, 80CRI	Glass	Medium	Hook	Wiring Box
Integrated Wiring Box Model - Hook - 347-480 VAC								
VCD-7NC5-JDHN-NGN	38,200	230	166	CW, 80CRI	Glass	Narrow	Hook	Wiring Box
VCD-7MC5-JDHN-NGN	37,400	230	163	CW, 80CRI	Glass	Medium	Hook	Wiring Box
VCD-7MC5-HDHN-NGN	32,300	195	166	CW, 80CRI	Glass	Medium	Hook	Wiring Box
VCD-7MC5-FDHN-NGN	28,000	165	170	CW, 80CRI	Glass	Medium	Hook	Wiring Box
VCD-7MC5-EDHN-NGN	23,800	140	170	CW, 80CRI	Glass	Medium	Hook	Wiring Box
20W Battery Backup - 120-277 VAC								
VED-7NC2-JDNN-NGH	38,200	236	162	CW, 80CRI	Glass	Narrow	Pendant 3/4" NPT	Wiring Box
VED-7MC2-JDNN-NGH	37,400	236	158	CW, 80CRI	Glass	Medium	Pendant 3/4" NPT	Wiring Box
VED-7MC2-HDNN-NGH	32,300	201	161	CW, 80CRI	Glass	Medium	Pendant 3/4" NPT	Wiring Box
VED-7MC2-FDNN-NGH	28,000	171	164	CW, 80CRI	Glass	Medium	Pendant 3/4" NPT	Wiring Box
VED-7MC2-EDNN-NGH	23,800	146	163	CW, 80CRI	Glass	Medium	Pendant 3/4" NPT	Wiring Box

All values typical unless otherwise stated (tolerance +/- 10%)

**DISCLAIMER.** All product information provided is, to the best of Dialight's knowledge, accurate as of the date of publication. When ordering, refer to [www.dialight.com](http://www.dialight.com) for current versions of: (a) relevant product documentation (including the relevant product data sheets); (b) Dialight terms and conditions of sale; and, (c) the relevant product warranty. To the extent that any contract is deemed formed between Dialight and the purchaser of Dialight products and/or an end-user, versions of documents available at [www.dialight.com](http://www.dialight.com) as at the date of sale shall be the versions incorporated therein. In the event of any discrepancy between this document or information provided at [www.dialight.com](http://www.dialight.com), the latter shall prevail.

## SafeSite® Ultra-Efficient LED Low Bay - UL / CSA

### Technical Information

#### Corded Model



#### Mechanical Information:

##### Fixture weight:

18 lbs (8.16kg)

##### Shipping weight:

24 lbs (10.8kg)

##### Mounting:

3/4" NPT - top

Various Kits

##### Power Cord:

10' 18 AWG ST00W/SOOW

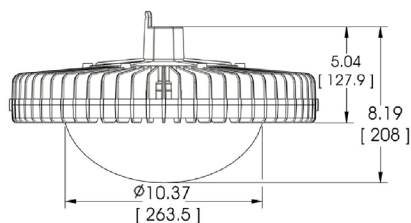
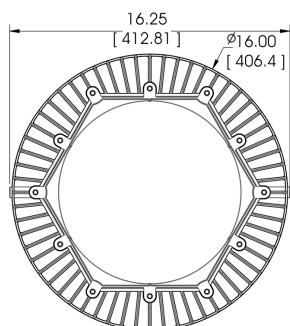

#### Integrated Wiring Box Model



#### Mechanical Information:

##### Fixture weight:

20 lbs (9 kg)

##### Shipping weight:

26 lbs (12 kg)

##### Mounting:

3/4" NPT or Hook

Various Kits

##### Wiring Box Cable Entries:

(2x) 3/4" NPT

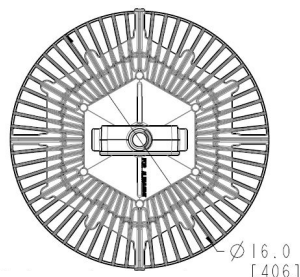
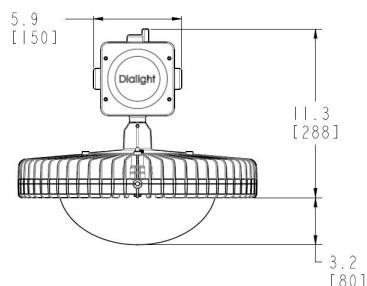

Dimensions in inches (mm)

#### Temperature Ratings:

##### Ambient Temp Range

T4 Temp Code: -40°F to +149°F (-40°C to +65°C)

##### Ambient Temp Range

T5 Temp Code: -40°F to +122°F (-40°C to +50°C)

#### Certifications & Ratings:

10 year warranty  
UL1598/A (wet locations)  
UL 8750  
IP66/67  
IK10 (polycarbonate dome)  
Class I, Div. 2 Groups A, B, C, D  
Class I, Zone 2, Group II C  
Class II, Div. 1 Groups E, F, G (corded model only)  
Class II, Div. 2 Groups F, G  
Class III, Div. 1 & 2

CSA 22.2 No. 250.0

NEMA 4X

L70 rated for >150,000 hours

#### Variable Dimming:

Variable Dimming Control: 0-10 VDC

##### Dimming Range:

10 VDC = 100% light output  
0 VDC = <10% light output

#### Electrical Specifications:

##### Operating voltage:

100-277 VAC, 120-250 VDC  
347-480 VAC

##### Power consumption:

See table

##### Operating temp:

-40°F to +149°F (-40°C to +65°C)

##### Harmonics:

IEC 61000-3-2 Class C

##### EMC:

FCC Title 47, Subpart B, Section 15,  
Class A device. RF Immunity; 10V/m,  
80MHz-1GHz

##### Transient protection:

100-277 VAC models tested to  
withstand up to 8kV/4kA per IEEE  
C62.41  
347-480VAC models tested to  
withstand up to 6kV/3kA per IEEE C62.41

##### THD:

6k-18k lm models: <20%

##### Power factor:

>0.9

##### Fusing:

Internal

#### Power Supply:

ALT:  
(accelerated life testing)

Over 15 yr equivalent at 24/7 service

MTBF:  
(mean time between failures)

Over 300 years with annual failure rate  
less than 0.3% expected

##### Driver:

Fully potted and sealed for superior  
protection

#### Construction:

##### Housing:

Copper free aluminum

##### Finish:

Superior dual coat finish  
Sealed polyester topcoat  
Chemical-resistant epoxy primer

##### Lens:

See table

##### Vibration:

Up to 5G @ 10-150Hz for 750,000 cycles,  
per IEC 60068-2-6 for luminaire only

##### Shock:

50G half-sine for 3 cycles,  
per IEC 60068-2-27 for luminaire only

#### Photometric Information:

##### CRI:

80

##### CCT:

5000K (cool white)  
4000K (neutral white)  
2700K (warm white)

All values typical unless otherwise stated (tolerance +/- 10%)

**WARNING - INSTALLATION & SECONDARY RETENTION.** Use of any Dialight products without proper installation (including secondary retention / netting) and periodic inspections could cause severe injury or death. Dialight recommends that all installations should use secondary retention / netting (appropriate to the installation environment) where applicable. It is the exclusive responsibility of the contractor, installer and/or end-user to: (a) determine the suitability of the product for its intended application; and, (b) ensure that the product is safely installed (with secondary retention / netting where appropriate) and in compliance with all applicable laws and regulations. To the extent permissible under applicable laws, Dialight disclaims all liability for personal injury and/or other damage resulting from any dislodgment or other dislocation of its products.

## SafeSite® Ultra-Efficient LED Low Bay - UL / CSA Battery Backup Model



### Mechanical Information:

**Fixture weight:**  
39 lbs (17.7 kg) max

**Shipping weight:**  
46 lbs (20.9 kg) max

**Mounting:**  
3/4" NPT - top  
Hook

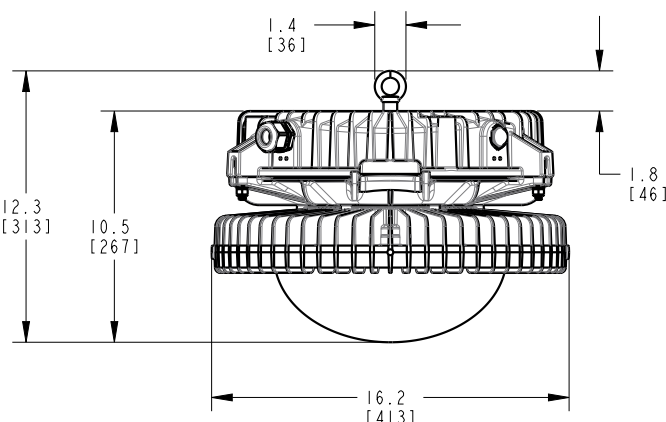
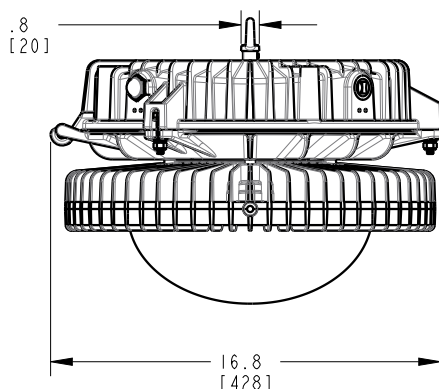

Dimensions in inches (mm)

### Temperature Ratings:

**Ambient Temp Range**  
**T4A Temp Code:** -4°F to +131°F (-20°C to +55°C)

### Certifications & Ratings:

10 year warranty (excluding battery)  
UL1598/A (wet locations) NEMA 4X  
UL 924 IP66/67  
UL 8750 L70 rated for >150,000 hours  
IK10 (polycarbonate dome)  
CSA 22.2 No. 250.0  
Class I, Div. 2 Groups A, B, C, D  
Class I, Zone 2, Group IIC  
Class II, Div. 1 Groups E, F, G  
Class II, Div. 2 Groups F, G  
Class III, Div. 1 & 2

### Variable Dimming:

**Variable Dimming Control:** 0-10 VDC

**Dimming Range:** 10 VDC = 100% light output  
0 VDC = <10% light output

### Electrical Specifications:

**Operating voltage:** 120-277 VAC

**Power consumption:** See table

**Operating temp:** -4°F to +131°F (-20°C to +55°C)

**Harmonics:** IEC 61000-3-2 Class C

**EMC:** FCC Title 47, Subpart B, Section 15, Class A device. RF Immunity; 10V/m, 80MHz-1GHz

**Transient protection:** 120-277 VAC models tested to withstand up to 6kV/3kA per IEEE C62.41

**THD:** 6k-18k lm models: <20%

**Power factor:** >0.9

**Fusing:** Internal

### Power Supply:

**ALT:** Over 15 yr equivalent at 24/7 service  
(accelerated life testing)

**MTBF:** Over 300 years with annual failure rate  
(mean time between failures) less than 0.3% expected

**Driver:** Fully potted and sealed for superior protection

### Construction:

**Housing:** Copper free aluminum

**Finish:** Superior dual coat finish  
Sealed polyester topcoat  
Chemical-resistant epoxy primer

**Lens:** See table

**Vibration:** Sinusoidal vibration tested per IEC 60068-2-6

### Photometric Information:

**CRI:** 80

**CCT:** 5000K (cool white)  
4000K (neutral white)

All values typical unless otherwise stated (tolerance +/- 10%)

**WARNING - INSTALLATION & SECONDARY RETENTION.** Use of any Dialight products without proper installation (including secondary retention / netting) and periodic inspections could cause severe injury or death. Dialight recommends that all installations should use secondary retention / netting (appropriate to the installation environment) where applicable. It is the exclusive responsibility of the contractor, installer and/or end-user to: (a) determine the suitability of the product for its intended application; and, (b) ensure that the product is safely installed (with secondary retention / netting where appropriate) and in compliance with all applicable laws and regulations. To the extent permissible under applicable laws, Dialight disclaims all liability for personal injury and/or other damage resulting from any dislodgment or other dislocation of its products.

## SafeSite® Ultra-Efficient LED Low Bay - UL / CSA

### Ordering Information



Project Information			Specifications		
Part Number:					
Project:					
Fixture Type:		Date:			

### Ordering Information

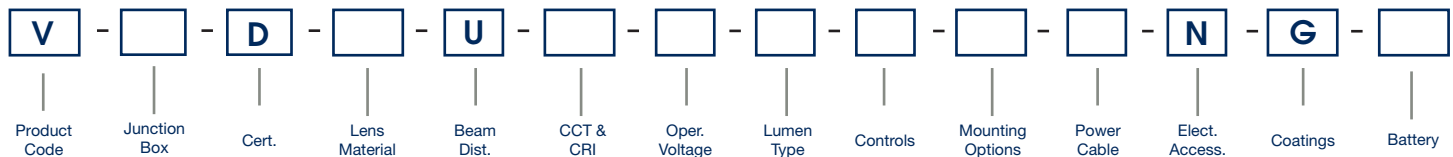

#### Product Code

V Vigilant® Ultra-Efficient

#### Junction Box

C Wiring Box<sup>2</sup>  
E No Junction Box

#### Certification

D UL 844 CID2, CII, CIII  
Class I, Zone 2

#### Lens Material

4 Polycarbonate - Clear  
5 Polycarbonate - Diffused  
L Polycarbonate Dome - Diffused

#### Beam Distribution

U Ultra Wide

#### CCT & CRI

C Cool White 5000K - 80 CRI  
N Neutral White 4000K - 80 CRI

#### Operating Voltage

2 100-277 VAC / 120-250 VDC  
5 347-480 VAC

#### Lumen Type<sup>1</sup>

6 6,100 Lumens  
9 9,000 Lumens  
B 13,400 Lumens  
C 16,600 Lumens

#### Controls

D Continuous Dimming  
J IntelliLED Wireless Controls  
N No Option  
Q Microwave Occ Sensor 40<sup>13</sup>

#### Mounting Options

H Hook  
N Pendant 3/4" NPT  
P Pendant 3/4" NPT with Safety Retention Tabs  
R Safety Retention Tabs with Hook

#### Power Cable

N No Cord (Wiring Box only)  
W 10' [3 meter] Power Cable

#### Electrical Accessories\*

N No Plug

\*Cord & plug options available upon request

#### Coatings

G Gray (RAL 7040)

#### Battery

G Battery Backup - 10W<sup>4</sup>  
H Battery Backup - 20W<sup>4</sup>  
N No Option

#### Notes

- 1) Lumen type based on using a polycarbonate dome lens. See page 14 for output of other options.
- 2) Wiring Box is not CLID1 rated.
- 3) Occupancy Sensor models are dry locations only and are IP6X rated with a -20°C to +65°C ambient temperature range. Occupancy Sensor models are not CLID1 rated.
- 4) Battery Backup only available with Junction Box = (E) and Operating Voltage = (2).

**DISCLAIMER.** All product information provided is, to the best of Dialight's knowledge, accurate as of the date of publication. When ordering, refer to [www.dialight.com](http://www.dialight.com) for current versions of: (a) relevant product documentation (including the relevant product data sheets); (b) Dialight terms and conditions of sale; and, (c) the relevant product warranty. To the extent that any contract is deemed formed between Dialight and the purchaser of Dialight products and/or an end-user, versions of documents available at [www.dialight.com](http://www.dialight.com) as at the date of sale shall be the versions incorporated therein. In the event of any discrepancy between this document or information provided at [www.dialight.com](http://www.dialight.com), the latter shall prevail.

# SafeSite® Ultra-Efficient LED Low Bay - UL / CSA

## Ordering Information



Corded Model - 3/4" Conduit - 100-277 VAC / 120-250 VDC								
Part Number	Lumens	Wattage	lm/W	CCT, CRI	Lens	Beam Distribution	Hardware Options	Wiring
VED-LUC2-CNNW-NGN	16,700	115	145	CW, 80CRI	Polycarbonate Dome - Diffused	Ultra Wide	Pendant 3/4" NPT	10' Power Cable
VED-LUC2-BNNW-NGN	13,400	90	149	CW, 80CRI	Polycarbonate Dome - Diffused	Ultra Wide	Pendant 3/4" NPT	10' Power Cable
VED-LUC2-9NNW-NGN	9,000	60	150	CW, 80CRI	Polycarbonate Dome - Diffused	Ultra Wide	Pendant 3/4" NPT	10' Power Cable
VED-LUC2-6NNW-NGN	6,100	43	142	CW, 80CRI	Polycarbonate Dome - Diffused	Ultra Wide	Pendant 3/4" NPT	10' Power Cable
Corded Model - 3/4" Conduit - 347-480 VAC								
VED-LUC5-CNNW-NGN	16,700	115	145	CW, 80CRI	Polycarbonate Dome - Diffused	Ultra Wide	Pendant 3/4" NPT	10' Power Cable
VED-LUC5-BNNW-NGN	13,400	90	149	CW, 80CRI	Polycarbonate Dome - Diffused	Ultra Wide	Pendant 3/4" NPT	10' Power Cable
VED-LUC5-9NNW-NGN	9,000	60	150	CW, 80CRI	Polycarbonate Dome - Diffused	Ultra Wide	Pendant 3/4" NPT	10' Power Cable
Integrated Wiring Box Model - Hook - 100-277 VAC / 120-250 VDC								
VCD-LUC2-CDHN-NGN	16,700	115	145	CW, 80CRI	Polycarbonate Dome - Diffused	Ultra Wide	Hook	Wiring Box
VCD-LUC2-BDHN-NGN	13,400	90	149	CW, 80CRI	Polycarbonate Dome - Diffused	Ultra Wide	Hook	Wiring Box
VCD-LUC2-9DHN-NGN	9,000	60	150	CW, 80CRI	Polycarbonate Dome - Diffused	Ultra Wide	Hook	Wiring Box
VCD-LUC2-6DHN-NGN	6,100	43	142	CW, 80CRI	Polycarbonate Dome - Diffused	Ultra Wide	Hook	Wiring Box
Integrated Wiring Box Model - Hook - 347-480 VAC								
VCD-LUC5-CDHN-NGN	16,700	115	145	CW, 80CRI	Polycarbonate Dome - Diffused	Ultra Wide	Hook	Wiring Box
VCD-LUC5-BDHN-NGN	13,400	90	149	CW, 80CRI	Polycarbonate Dome - Diffused	Ultra Wide	Hook	Wiring Box
VCD-LUC5-9DHN-NGN	9,000	60	150	CW, 80CRI	Polycarbonate Dome - Diffused	Ultra Wide	Hook	Wiring Box
10W Battery Backup - 120-277 VAC								
VED-LUC2-CDNN-NGG	16,700	121	138	CW, 80CRI	Polycarbonate Dome - Diffused	Ultra Wide	Pendant 3/4" NPT	Wiring Box
VED-LUC2-BDNN-NGG	13,400	96	140	CW, 80CRI	Polycarbonate Dome - Diffused	Ultra Wide	Pendant 3/4" NPT	Wiring Box
VED-LUC2-9DNN-NGG	9,000	66	136	CW, 80CRI	Polycarbonate Dome - Diffused	Ultra Wide	Pendant 3/4" NPT	Wiring Box

All values typical unless otherwise stated (tolerance +/- 10%)

**DISCLAIMER.** All product information provided is, to the best of Dialight's knowledge, accurate as of the date of publication. When ordering, refer to [www.dialight.com](http://www.dialight.com) for current versions of: (a) relevant product documentation (including the relevant product data sheets); (b) Dialight terms and conditions of sale; and, (c) the relevant product warranty. To the extent that any contract is deemed formed between Dialight and the purchaser of Dialight products and/or an end-user, versions of documents available at [www.dialight.com](http://www.dialight.com) as at the date of sale shall be the versions incorporated therein. In the event of any discrepancy between this document or information provided at [www.dialight.com](http://www.dialight.com), the latter shall prevail.

# Lumen Tables

## High Bay

Vigilant High Bay 100-277 VAC, 120-250 VDC and 347-480 VAC, 250-480 VAC and 250-480 VDC					
Output	Wattage	Optic	Lens Material	70 CRI, 5000K / 4000K CCT	
				Lumen Output	lm/W
J	230	High Efficacy Round	Glass	41,300	180
H	195			35,700	183
F	165			30,900	187
E	140			26,300	188
C	96			19,100	200
B	80			15,000	188
A	65			12,100	186
Variable		Type		Scale Factor	
Lens		Glass - Clear		100%	
		Acrylic - Clear		100%	
		Polycarbonate - Clear		99%	
		Polycarbonate - Dome Diffused		98%	
Optic		Round		100%	
		Narrow		97%	
		Medium		95%	
		Aisle		92%	
CCT & CRI		CW 70 CRI		100%	
		NW 70 CRI		100%	
		CW 80 CRI		96%	
		NW 80 CRI		96%	

\*Optional battery backup will add 6W to fixture wattage

## Low Bay

Vigilant Low Bay 100-277 VAC, 120-250 VDC and 347-480 VAC, 250-480 VAC					
Output	Wattage	Optic	Lens Material	80 CRI, 5000K / 4000K CCT	
				Lumen Output	lm/W
6	43	Ultra Wide	Polycarbonate - Dome	6,100	142
9	60			9,000	150
B	90			13,400	149
C	115			16,600	144
Variable		Type		Scale Factor	
Lens		Acrylic - Clear		102%	
		Polycarbonate - Clear		101%	
		Polycarbonate - Dome Diffused		100%	

## Battery Backup

lm/W	10W Battery - Lumens	20W Battery - Lumens
140	1,400	2,800
150	1,500	3,000
160	1,600	3,200
170	1,700	3,400
180	1,800	3,600
190	1,900	3,800
200	2,000	4,000

Battery performance at 25°C ambient temperature. Output will be reduced at temperatures below 0°C

**DISCLAIMER.** All product information provided is, to the best of Dialight's knowledge, accurate as of the date of publication. When ordering, refer to [www.dialight.com](http://www.dialight.com) for current versions of: (a) relevant product documentation (including the relevant product data sheets); (b) Dialight terms and conditions of sale; and, (c) the relevant product warranty. To the extent that any contract is deemed formed between Dialight and the purchaser of Dialight products and/or an end-user, versions of documents available at [www.dialight.com](http://www.dialight.com) as at the date of sale shall be the versions incorporated therein. In the event of any discrepancy between this document or information provided at [www.dialight.com](http://www.dialight.com), the latter shall prevail.

## Thermal Roll-Off

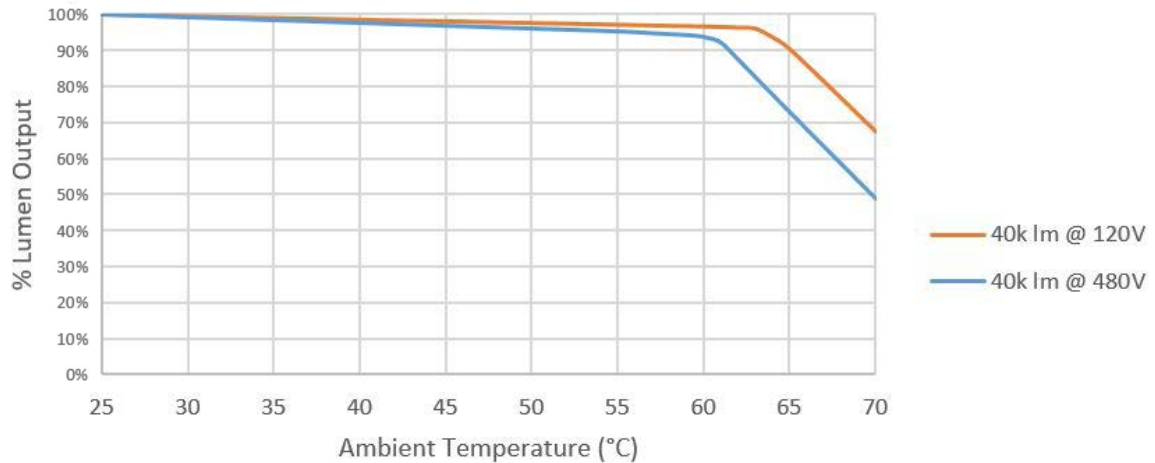

## Dimming Characterization 0-10V

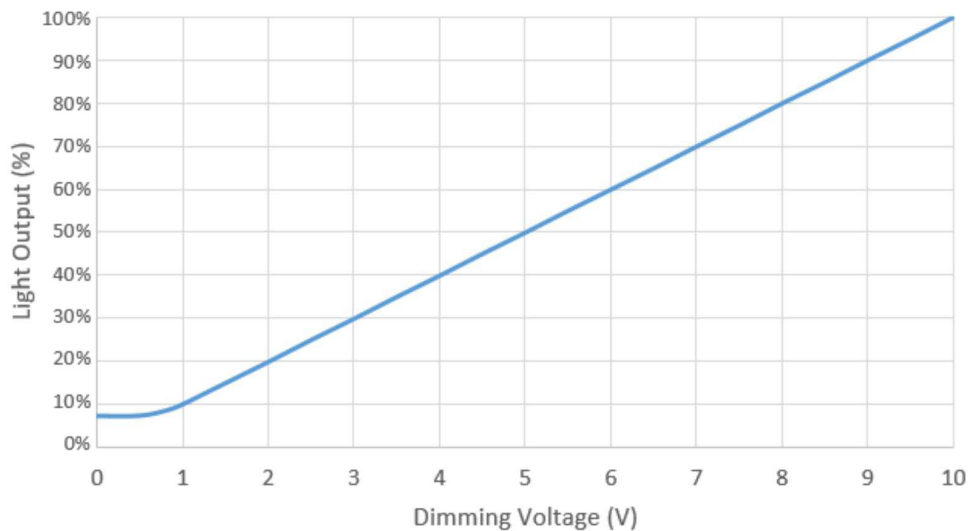

**DISCLAIMER.** All product information provided is, to the best of Dialight's knowledge, accurate as of the date of publication. When ordering, refer to [www.dialight.com](http://www.dialight.com) for current versions of: (a) relevant product documentation (including the relevant product data sheets); (b) Dialight terms and conditions of sale; and, (c) the relevant product warranty. To the extent that any contract is deemed formed between Dialight and the purchaser of Dialight products and/or an end-user, versions of documents available at [www.dialight.com](http://www.dialight.com) as at the date of sale shall be the versions incorporated therein. In the event of any discrepancy between this document or information provided at [www.dialight.com](http://www.dialight.com), the latter shall prevail.

# Beam Distribution

Medium

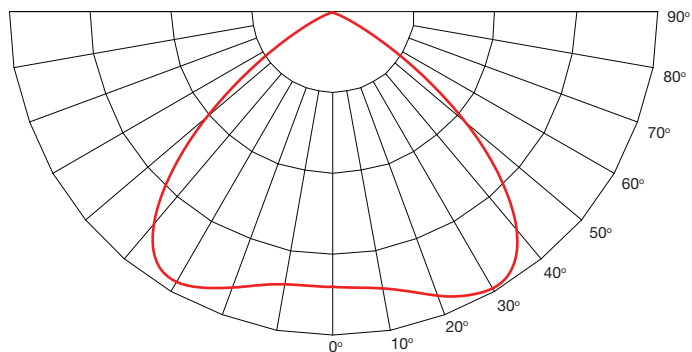

Aisle

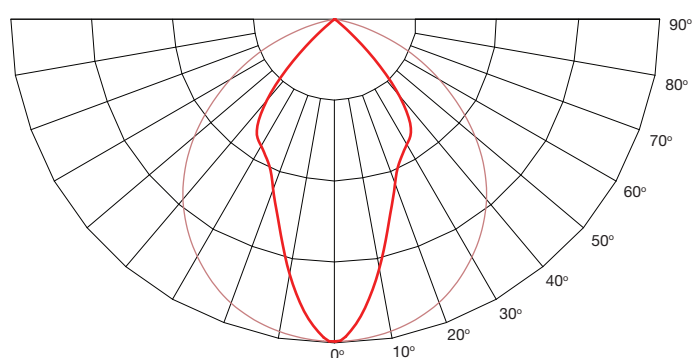

Round

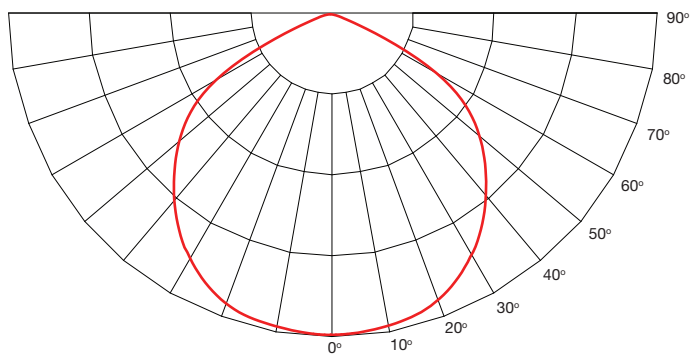

Narrow

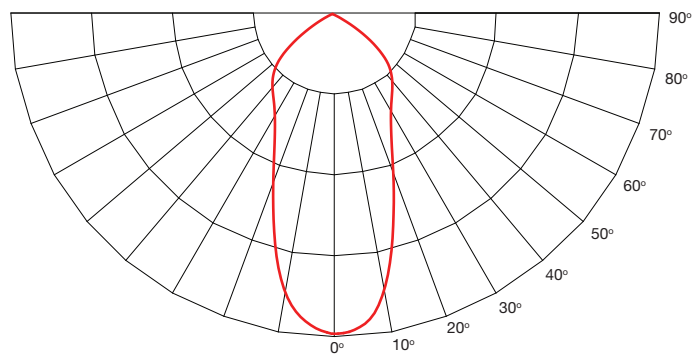

Ultra Wide

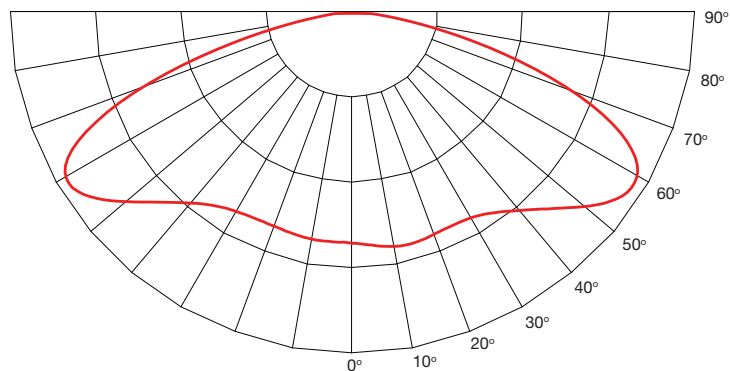

**DISCLAIMER.** All product information provided is, to the best of Dialight's knowledge, accurate as of the date of publication. When ordering, refer to [www.dialight.com](http://www.dialight.com) for current versions of: (a) relevant product documentation (including the relevant product data sheets); (b) Dialight terms and conditions of sale; and, (c) the relevant product warranty. To the extent that any contract is deemed formed between Dialight and the purchaser of Dialight products and/or an end-user, versions of documents available at [www.dialight.com](http://www.dialight.com) as at the date of sale shall be the versions incorporated therein. In the event of any discrepancy between this document or information provided at [www.dialight.com](http://www.dialight.com), the latter shall prevail.

# Lumen Maintenance Factor

% Lumen Output (40k lm @ 120V)									
Ambient Temp (°C)	Hours								
	0	15000	30000	45000	60000	75000	90000	100000	150000
25	100%	96%	93%	90%	87%	84%	91%	80%	71%
30	100%	96%	93%	90%	87%	84%	91%	79%	71%
35	99%	95%	92%	89%	86%	84%	90%	79%	71%
40	99%	95%	92%	89%	86%	83%	90%	79%	70%
45	98%	94%	91%	88%	85%	82%	80%	78%	69%
50	98%	94%	91%	87%	84%	82%	79%	77%	69%
55	97%	93%	90%	87%	84%	81%	78%	76%	68%
60	97%	93%	89%	86%	83%	80%	77%	75%	67%
65	90%	87%	84%	80%	78%	75%	72%	70%	62%

% Lumen Output (40k lm @ 480V)									
Ambient Temp (°C)	Hours								
	0	15000	30000	45000	60000	75000	90000	100000	150000
25	100%	96%	93%	90%	87%	84%	91%	80%	71%
30	99%	96%	92%	89%	87%	84%	90%	79%	71%
35	98%	95%	92%	89%	86%	83%	90%	79%	70%
40	98%	94%	91%	88%	85%	82%	89%	78%	70%
45	97%	93%	90%	87%	84%	81%	79%	77%	69%
50	96%	92%	89%	86%	83%	80%	78%	76%	67%
55	95%	91%	88%	85%	82%	79%	77%	75%	66%
60	94%	90%	87%	84%	81%	78%	75%	73%	65%
65	73%	70%	67%	65%	63%	60%	58%	56%	50%

% Lumen Output (26k lm @ 120V)									
Ambient Temp (°C)	Hours								
	0	15000	30000	45000	60000	75000	90000	100000	150000
25	100%	97%	95%	92%	90%	88%	86%	84%	77%
30	99%	97%	94%	92%	90%	87%	85%	84%	77%
35	99%	96%	94%	91%	89%	87%	85%	83%	76%
40	98%	96%	93%	91%	89%	86%	84%	83%	76%
45	98%	95%	93%	90%	88%	86%	84%	82%	75%
50	97%	94%	92%	90%	87%	85%	83%	81%	75%
55	97%	94%	91%	89%	87%	84%	82%	81%	74%
60	96%	93%	91%	88%	86%	84%	81%	80%	73%
65	96%	93%	90%	88%	85%	83%	81%	79%	72%

**DISCLAIMER.** All product information provided is, to the best of Dialight's knowledge, accurate as of the date of publication. When ordering, refer to [www.dialight.com](http://www.dialight.com) for current versions of: (a) relevant product documentation (including the relevant product data sheets); (b) Dialight terms and conditions of sale; and, (c) the relevant product warranty. To the extent that any contract is deemed formed between Dialight and the purchaser of Dialight products and/or an end-user, versions of documents available at [www.dialight.com](http://www.dialight.com) as at the date of sale shall be the versions incorporated therein. In the event of any discrepancy between this document or information provided at [www.dialight.com](http://www.dialight.com), the latter shall prevail.

# In-rush Current

## 100-277 VAC Models

Product	Output	Max Wattage	Inrush Current @ Input Voltage				Approximate Time Duration (T50) of Inrush Current			
			100VAC	120VAC	230VAC	277VAC	100VAC	120VAC	230VAC	277VAC
Low Bay	4k	33	6.4	7.7	14.8	17.8	1.5ms	1.5ms	1.5ms	1.5ms
	6k	50	6.4	7.7	14.8	17.8	1.5ms	1.5ms	1.5ms	1.5ms
	9k	69	6.4	7.7	14.8	17.8	1.5ms	1.5ms	1.5ms	1.5ms
	14k	102	6.4	7.7	14.8	17.8	1.5ms	1.5ms	1.5ms	1.5ms
	18k	130	6.4	7.7	14.8	17.8	1.5ms	1.5ms	1.5ms	1.5ms
High Bay	11k	73	6.4	7.7	14.8	17.8	1.5ms	1.5ms	1.5ms	1.5ms
	14k	90	6.4	7.7	14.8	17.8	1.5ms	1.5ms	1.5ms	1.5ms
	18k	111	6.4	7.7	14.8	17.8	1.5ms	1.5ms	1.5ms	1.5ms
	26k	161	6.4	7.7	14.8	17.8	1.5ms	1.5ms	1.5ms	1.5ms
	30k	190	6.4	7.7	14.8	17.8	1.5ms	1.5ms	1.5ms	1.5ms
	35k	225	6.4	7.7	14.8	17.8	1.5ms	1.5ms	1.5ms	1.5ms
	40k	261	6.4	7.7	14.8	17.8	1.5ms	1.5ms	1.5ms	1.5ms

# Breakers

## 100-277 VAC Models

Product	Output	Max Wattage	Maximum # of Lights per Breaker @100VAC			Maximum # of Lights per Breaker @120VAC			Maximum # of Lights per Breaker @230VAC			Maximum # of Lights per Breaker @277VAC		
			C10	B16	C16	C10	B16	C16	C10	B16	C16	C10	B16	C16
Low Bay	4k	33	22	34	34	26	42	42	48	77	77	54	87	87
	6k	50	14	23	23	18	28	28	32	52	52	38	61	61
	9k	69	10	17	17	13	20	20	24	39	39	28	45	45
	14k	102	7	11	11	8	14	14	16	26	26	18	29	29
	18k	130	6	9	9	7	11	11	13	21	21	15	24	24
High Bay	11k	73	10	16	16	12	19	19	23	37	37	27	43	43
	14k	90	8	13	13	10	16	16	19	30	30	22	36	36
	18k	111	6	10	10	8	13	13	15	24	24	17	28	28
	26k	161	4	7	7	5	9	9	11	17	17	12	19	19
	30k	190	4	6	6	5	7	7	9	14	14	10	17	17
	35k	225	3	5	5	4	6	6	8	12	12	9	14	14
	40k	261	3	4	4	3	5	5	7	10	10	8	12	12

**DISCLAIMER.** All product information provided is, to the best of Dialight's knowledge, accurate as of the date of publication. When ordering, refer to [www.dialight.com](http://www.dialight.com) for current versions of: (a) relevant product documentation (including the relevant product data sheets); (b) Dialight terms and conditions of sale; and, (c) the relevant product warranty. To the extent that any contract is deemed formed between Dialight and the purchaser of Dialight products and/or an end-user, versions of documents available at [www.dialight.com](http://www.dialight.com) as at the date of sale shall be the versions incorporated therein. In the event of any discrepancy between this document or information provided at [www.dialight.com](http://www.dialight.com), the latter shall prevail.

# In-rush Current

## 347-480 VAC Models

Product	Output	Max Wattage	Inrush Current @ Input Voltage		Approximate Time Duration (T50) of Inrush Current	
			347VAC	480VAC	347VAC	480VAC
Low Bay	9k	71	22.3	30.9	1.8ms	1.8ms
	14k	103	22.3	30.9	1.8ms	1.8ms
	18k	130	22.3	30.9	1.8ms	1.8ms
High Bay	11k	70	22.3	30.9	1.8ms	1.8ms
	14k	89	22.3	30.9	1.8ms	1.8ms
	18k	112	22.3	30.9	1.8ms	1.8ms
	26k	159	22.3	30.9	1.8ms	1.8ms
	30k	187	22.3	30.9	1.8ms	1.8ms
	35k	221	22.3	30.9	1.8ms	1.8ms
	40k	252	22.3	30.9	1.8ms	1.8ms

# Breakers

## 347-480 VAC Models

Product	Output	Max Wattage	Maximum # of Lights per Breaker @347VAC			Maximum # of Lights per Breaker @480VAC		
			C10	B16	C16	C10	B16	C16
Low Bay	9k	71	34	54	54	44	70	70
	14k	103	24	38	38	31	50	50
	18k	130	19	30	30	25	40	40
High Bay	11k	70	34	55	55	45	71	71
	14k	89	27	44	44	36	58	58
	18k	112	22	35	35	29	46	46
	26k	159	15	25	25	21	33	33
	30k	187	13	21	21	18	29	29
	35k	221	11	18	18	15	25	25
	40k	252	10	16	16	13	22	22

**DISCLAIMER.** All product information provided is, to the best of Dialight's knowledge, accurate as of the date of publication. When ordering, refer to [www.dialight.com](http://www.dialight.com) for current versions of: (a) relevant product documentation (including the relevant product data sheets); (b) Dialight terms and conditions of sale; and, (c) the relevant product warranty. To the extent that any contract is deemed formed between Dialight and the purchaser of Dialight products and/or an end-user, versions of documents available at [www.dialight.com](http://www.dialight.com) as at the date of sale shall be the versions incorporated therein. In the event of any discrepancy between this document or information provided at [www.dialight.com](http://www.dialight.com), the latter shall prevail.

# In-rush Current

## 250-480 VAC Models

Product	Output	Max Wattage	Inrush Current @ Input Voltage			Approximate Time Duration (T50) of Inrush Current		
			250 VAC	347VAC	480VAC	250 VAC	347VAC	480VAC
High Bay	11k	69	2.9	4.1	5.7	1.5	1.5	1.5
	14k	84	2.9	4.1	5.7	1.5	1.5	1.5
	18k	108	2.9	4.1	5.7	1.5	1.5	1.5
	26k	160	2.9	4.1	5.7	1.5	1.5	1.5
	30k	189	2.9	4.1	5.7	1.5	1.5	1.5
	35k	221	2.9	4.1	5.7	1.5	1.5	1.5
	40k	261	2.9	4.1	5.7	1.5	1.5	1.5

# Breakers

## 250-480 VAC Models

Product	Output	Max Wattage	Maximum # of Lights per Breaker @250VAC			Maximum # of Lights per Breaker @347VAC			Maximum # of Lights per Breaker @480VAC		
			C10	B16	C16	C10	B16	C16	C10	B16	C16
High Bay	11k	69	23	38	38	33	52	52	45	72	72
	14k	84	19	31	31	27	43	43	37	59	59
	18k	108	15	24	24	21	33	33	29	46	46
	26k	160	10	16	16	14	22	22	19	31	31
	30k	189	6	9	9	8	13	13	11	17	17
	35k	221	7	12	12	10	16	16	14	23	23
	40k	261	6	10	10	9	14	14	12	19	19

**DISCLAIMER.** All product information provided is, to the best of Dialight's knowledge, accurate as of the date of publication. When ordering, refer to [www.dialight.com](http://www.dialight.com) for current versions of: (a) relevant product documentation (including the relevant product data sheets); (b) Dialight terms and conditions of sale; and, (c) the relevant product warranty. To the extent that any contract is deemed formed between Dialight and the purchaser of Dialight products and/or an end-user, versions of documents available at [www.dialight.com](http://www.dialight.com) as at the date of sale shall be the versions incorporated therein. In the event of any discrepancy between this document or information provided at [www.dialight.com](http://www.dialight.com), the latter shall prevail.

# Vigilant® LED High Bay / Low Bay - UL / CSA



**HBXW3-SSL-316**

- Stainless steel bracket



**HBXCAB48**

- 48" long stainless steel safety rope (for use with safety bracket)
- 2 pieces per kit



**HBXH**

- Hook
- For use with 3 conductor cable only

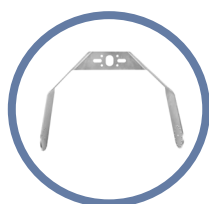

**HBXW3-SSL-316FT**

- 316 Stainless steel forward throw bracket



**HBXHL**

- Hook/Loop
- For use with 3 conductor cable only



**HBXCU**

- Ceiling / wall mount



**HBXW2**

- Swivel bracket and cable gland

**HBXW3**

- Swivel bracket



**HBXSB**

- Stainless Steel (4x)



**HBXCG**

- Cable gland

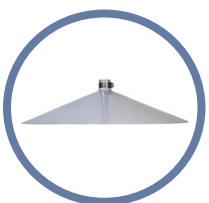

**HBXDC**

- 21° slope dust cover

**HBXDC45**

- 45° slope dust cover

**HBXDC60**

- 60° slope dust cover



**LBXLENP**

- Polycarbonate dome lens replacement



**HBBATTKIT20**

- 20W replacement battery

**HBBATTKIT10**

- 10W replacement battery

## North American HQ

1501 Route 34 South  
Farmingdale, NJ 07727  
Tel: 732-919-3119  
Fax: 732-751-5778  
info@dialight.com

## Australia

108 Howe Street  
Osborne Park, WA 6017  
Tel: +61 (0) 8 9244 7600  
Fax: +61 (0) 8 9244 7601  
info@dialight.com.au

## Dialight Europe Ltd

Leaf C, Level 36, Tower 42  
25 Old Broad Street  
London, EC2N 1HQ, United Kingdom  
Tel: +44 (0) 203 058 3540  
Customer Service: +44 (0) 163 866 6541  
sales-emea@dialight.com

## Southeast Asia

56 Kallang Pudding Road  
#09 – 08 HH@Kallang  
Singapore 349328  
Tel: +65 6578 7271  
Fax: +65 6578 7150  
enquiry@dialight.com.sg

## Middle East

Level 23 – Boulevard Plaza Tower 2  
Emaar Boulevard, Dubai, U.A.E.  
P.O. Box 124342  
Tel: +971 (4) 409-6962  
Fax: +971 (4) 409-6850

### WARNING / DISCLAIMERS:

**Installation & secondary retention.** The use of this product without proper installation (including secondary retention / netting) and periodic inspections, could cause severe injury or death. Dialight recommends that all installations should use secondary retention / netting (appropriate to the installation environment) as applicable. Dialight products are intended for ultimate purchase, installation and operation by knowledgeable persons trained in the functional assessment, installation, use and maintenance of such products and all customers (including but not limited to end customers) are responsible for assessing the suitability of Dialight products for any given installation requirement. It is the exclusive responsibility of the contractor, installer and/or end-user to: (a) determine the suitability of the product for its intended application; and, (b) ensure that the product is safely installed (with secondary retention / netting as appropriate) and in compliance with all applicable laws and regulations.

**Product specifications & warranties.** All product information provided is, to the best of Dialight's knowledge, accurate as of the date of publication. All values and performance data herein are design or typical values when measured under laboratory conditions. The information herein is subject to change without notice. The products / software detailed herein are subject to applicable warranties and terms and conditions of use/purchase. Unless agreed otherwise in writing by an authorized representative of Dialight, Dialight does not represent that its products are fit for any particular purpose and accepts no liability for the installation and/or unauthorised use of its products. When ordering, refer to [www.dialight.com](http://www.dialight.com) for current versions of: (a) relevant product documentation (including relevant product data sheets); (b) Dialight terms and conditions of sale; and, (c) the relevant product warranties. To the extent that any contract is deemed formed between Dialight and the purchaser of Dialight products and/or an end-user, versions of documents available at [www.dialight.com](http://www.dialight.com) as at the date of sale shall be the versions incorporated therein. In the event of any discrepancy between this document and information provided at [www.dialight.com](http://www.dialight.com), the latter shall prevail.

**Exclusion of liability.** To the extent permissible under the relevant law, Dialight disclaims all liability for personal injury and/or other damage resulting from any dislodgment or other dislocation of its products. Whilst Dialight has used its reasonable endeavours to ensure the completeness and accuracy of information herein, Dialight does not assume any liability for damages resulting from use of this information or for any third-party representations made in relation to Dialight products.